

# Round Bale Spear (BSU48)



## Features

- ☑ One 2" x 48" main spear, two 1 1/2" stabilizers.
- ☑ One bale maximum.

# Round Bale Spear Specifications

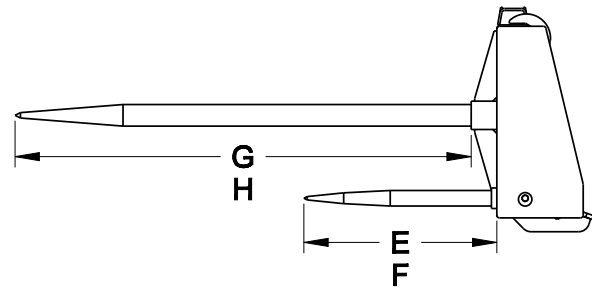
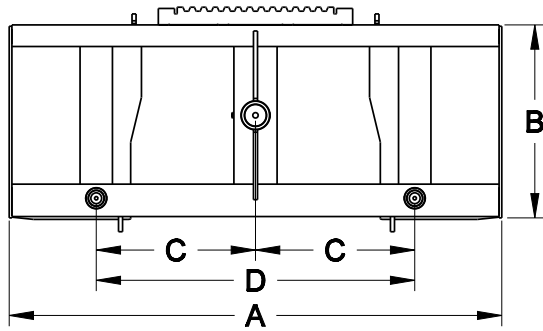

MODEL	BSV48
(A) Frame Width (Inches)	45.5
Number of Main Spears <sup>1</sup>	1
(B) Frame Height (Inches)	18.0
(C) Spear Space (Inches)	14.8
(D) Spear Space (Inches)	29.5
(E) Usable Spear Length (Inches)	17.4
Number of Stabilizer Spears <sup>1</sup>	2
(F) Spear Size	1.5
(G) Usable Spear Length (Inches)	42.3
(H) Spear Size	2.0
Approximate Weight (Pounds)	230
Capacity, With Bale Against Frame (Pounds)	2000

<sup>1</sup> 1045 Cold Finished Stress Relieved (CFSR) Round Stock (100,000 PSI Minimum Yield Strength).

**Additional Info**

- All teeth on all models are bolted in.

Specifications and designs are subject to change without notice.



**Virnig Manufacturing Inc.**  
 800-648-2408  
 attachments@virnigmfg.com  
 www.virnigmfg.com

## Round / Square Bale Combo Spear (CBU48)



### Features

- ☑ One 1 3/4" x 42" main spear, three 1 3/4" x 30" stabilizers.
- ☑ One bale maximum.

# Round / Square Bale Combo Spear Specifications

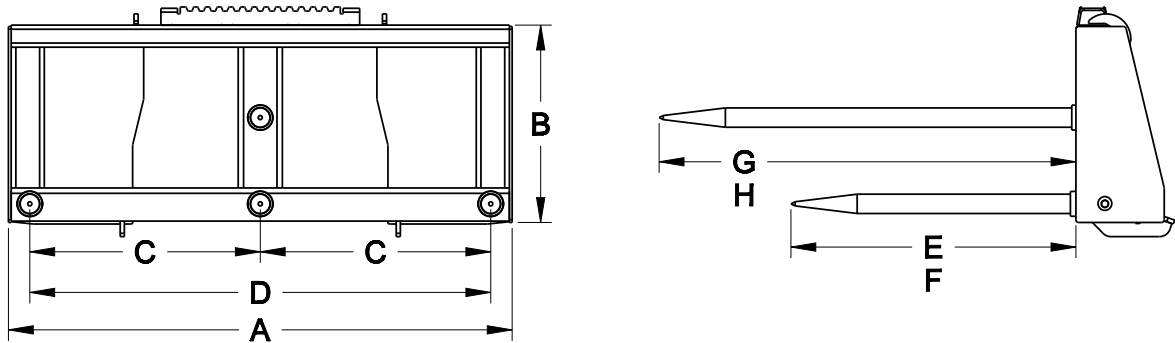

MODEL	CBV48
(A) Frame Width (Inches)	45.5
Number of Main Spears <sup>1</sup>	1
(B) Frame Height (Inches)	18.0
(C) Spear Space (Inches)	20.9
(D) Spear Space (Inches)	41.8
(E) Usable Spear Length (Inches)	25.8
Number of Stabilizer Spears <sup>1</sup>	3
(F) Spear Size	1.75
(G) Usable Spear Length (Inches)	37.8
(H) Spear Size	1.75
Approximate Weight (Pounds)	260
Capacity, With Bale Against Frame (Pounds)	2000

<sup>1</sup> 1045 CFSR Round Material  
(100,000 PSI Minimum Yield Strength).

**Additional Info**

- All teeth on all models are bolted in.

Specifications and designs are subject to change without notice.



**Virnig Manufacturing Inc.**  
800-648-2408  
attachments@virnigmfg.com  
www.virnigmfg.com

# Bale Fork (BFU48)



## Features

- ☑ Two 2" x 48" spears.
- ☑ One bale maximum.

# Bale Fork Specifications

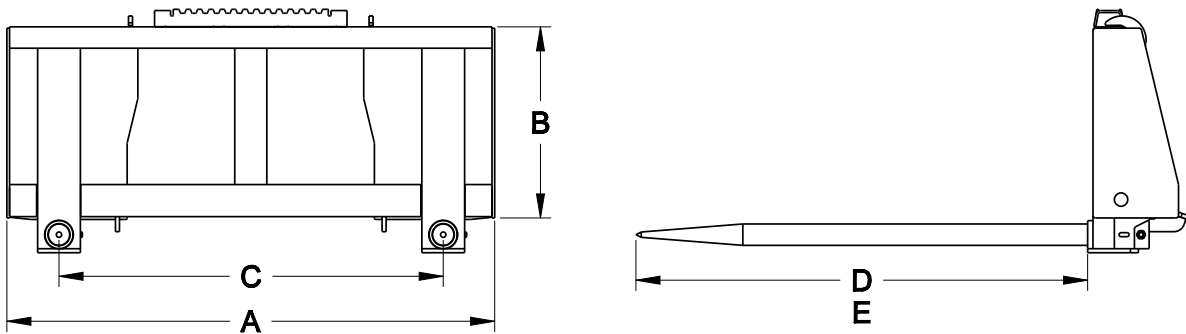

MODEL	BFV48
(A) Frame Width (Inches)	45.5
Number of Main Spears <sup>1</sup>	2
(B) Frame Height (Inches)	18.0
(C) Spear Space (Inches)	36.0
(D) Usable Spear Length (Inches)	42.3
Number of Stabilizer Spears	-
(E) Spear Size	2.0
Approximate Weight (Pounds)	270
Capacity, With Bale Against Frame (Pounds)	2000

<sup>1</sup> 1045 CFSR Round Material  
(100,000 PSI Minimum Yield Strength).

**Additional Info**

- All teeth on all models are bolted in.

Specifications and designs are subject to change without notice.



**Virnig Manufacturing Inc.**  
800-648-2408  
attachments@virnigmfg.com  
www.virnigmfg.com

# Square Bale Spear (SSU48)



## Features

- ☑ Three 1 3/4" x 30" spears.
- ☑ One bale maximum.

# Square Bale Spear Specifications

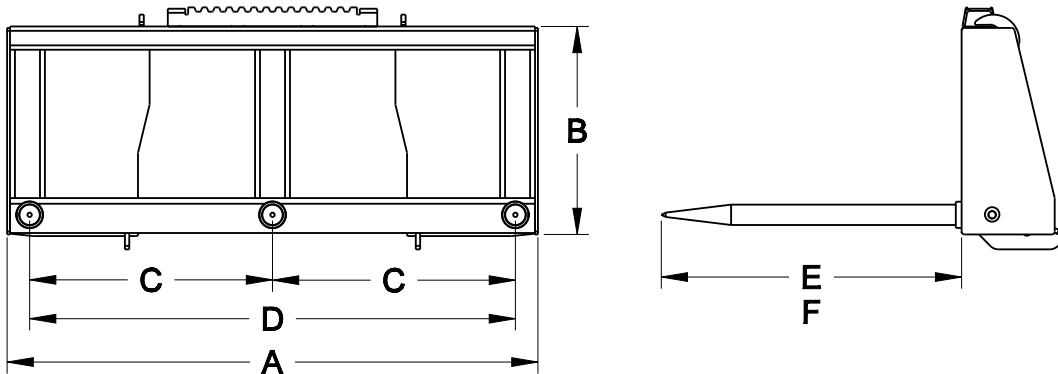

MODEL	SSV48
(A) Frame Width (Inches)	45.5
Number of Main Spears <sup>1</sup>	3
(B) Frame Height (Inches)	18.0
(C) Spear Space (Inches)	20.9
(D) Spear Space (Inches)	41.8
(E) Usable Spear Length (Inches)	25.8
Number of Stabilizer Spears	-
(F) Spear Size	1.75
Approximate Weight (Pounds)	225
Capacity, With Bale Against Frame (Pounds)	2000

<sup>1</sup> 1045 CFSR Round Material  
(100,000 PSI Minimum Yield Strength).

**Additional Info**

- All teeth on all models are bolted in.

Specifications and designs are subject to change without notice.



**Virnig Manufacturing Inc.**  
800-648-2408  
attachments@virnigmfg.com  
www.virnigmfg.com



# Big Square Bale Spear (BASS66)



## Features

- ☑ Two 1 3/4" x 42" main spears, two 1 3/4" x 30" stabilizers.
- ☑ One bale maximum.

# Big Square Bale Spear Specifications

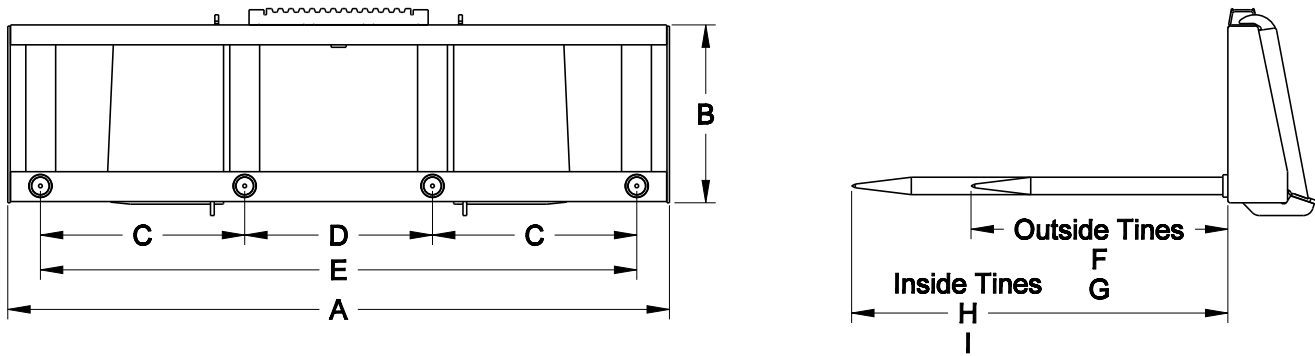

MODEL	BASS66
(A) Frame Width (Inches)	66.5
Number of Main Spears <sup>1</sup>	2
(B) Frame Height (Inches)	18.0
(C) Spear Space (Inches)	20.6
(D) Spear Space (Inches)	18.9
(E) Spear Space (Inches)	60.0
(F) Usable Spear Length (Inches)	25.8
Number of Stabilizer Spears <sup>1</sup>	2
(G) Spear Size	1.75
(H) Usable Spear Length (Inches)	37.8
(I) Spear Size	1.75
Approximate Weight (Pounds)	310
Capacity, With Bale Against Frame (Pounds)	2000

<sup>1</sup> 1045 CFSR Round Material  
(100,000 PSI Minimum Yield Strength).

### Additional Info

- All teeth on all models are bolted in.

Specifications and designs are subject to change without notice.



**Virnig Manufacturing Inc.**  
800-648-2408  
attachments@virnigmfg.com  
www.virnigmfg.com