

V50 SKELETON TINE GRAPPLE



- Two-cylinder independent grapple that reaches tine tips for fine work.
- Every tine is constructed from one piece of ½" Grade 80 steel, from tip to top brace, to add rigidity.
- Fully gusseted tines with no cross member allowing better material penetration.
- 2" bore, 8 ⅜" stroke cylinders featuring corrosion, dent and flake resistant NitroSteel® cylinder rods.
- Greasable 1 ¼" diameter cylinder pins and 1 ⅞" diameter hinge pins.
- Teflon® coated bushings provide lubrication at all pivot locations.

OPTION: CYLINDER GUARDS



- Protect cylinders from damage.



V50 SKELETON TINE GRAPPLE SPECS

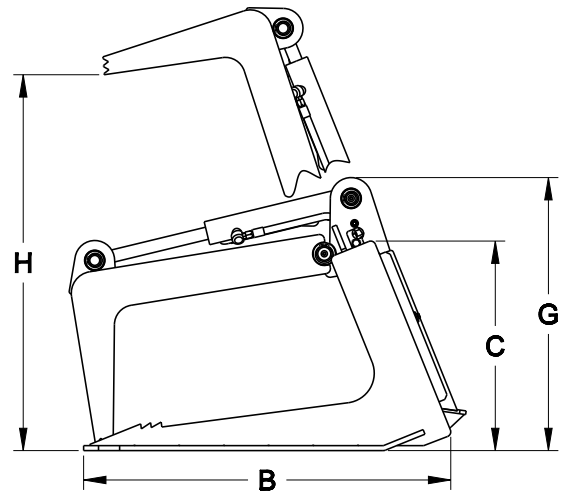
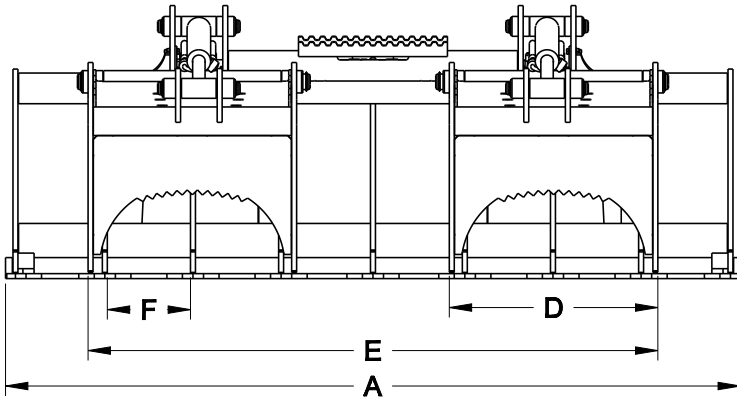

MODEL	STG66	STG72	STG78	STG84	STG90
(A) Overall Bucket Width (Inches)	68.0	74.0	80.0	86.0	92.0
(B) Bucket Depth (Inches)	36.5				
(C) Bucket Height (Inches)	21.1				
Number of Tines (With Sides)	8	9	10	10	11
(D) Space Between Tines (Inches)	9.5	8.4	8.7	9.3	8.5
Tine Thickness (Inches)	0.5*				
(E) Overall Grapple Width (Inches)	57.4				
(F) Independent Grapple Width (Inches)	21.0				
(G) Height with Grapple Closed (Inches)	27.5				
(H) Grapple Jaw Opening (Inches)	36.4				
Approximate Weight (Pounds)	910	950	990	1010	1050
Recommended Loader Capacity	Greater than 1500 pounds				

*Tine Material is Grade 80 Plate (80,000 PSI Minimum Yield Strength).

- 1-9/16" diameter hinge pins.
- 2" bore, 8-3/8" stroke cylinders with 1-1/4" NitroSteel® cylinder rods and 1-1/4" cylinder pins.
- Hoses from grapple to loader and couplers included.