

Land Leveler with Scarifier

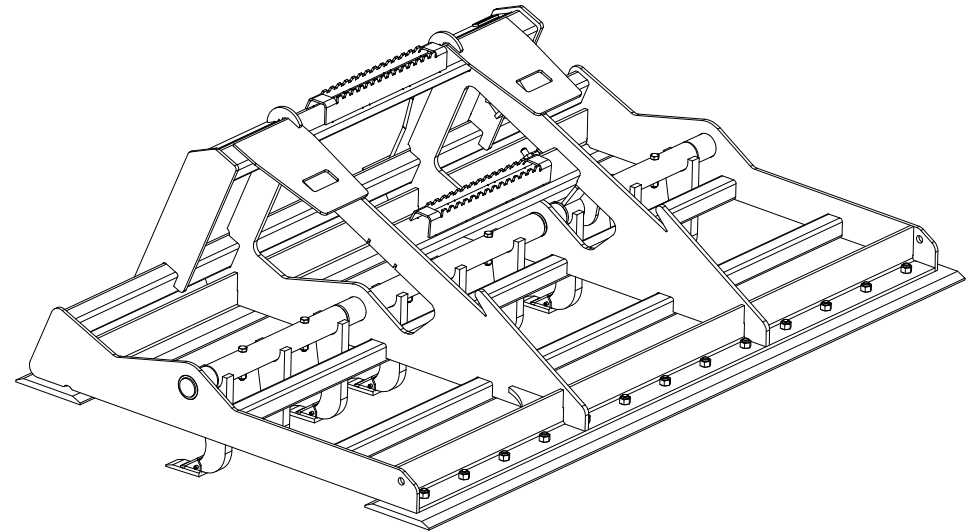

Model Number LLV /SK.

Serial Number _____.

Serial Number 129703, 129704, 130569 and Greater
Manufacture Date 02/01/18 – Current

Phone: 320-393-7080

3/6/09
Revised 02/01/18

LLV/SK

Features of Virnig Mfg. Inc. Land Leveler with Scarifier include:

- 1 1/2" bore x 6" stroke cylinder.
- Replaceable teeth on scarifier.
- Reversible, replaceable cutting edges.
- Constructed with heavy plate for strength and durability.

Initial Use

- See following pages for suggested hose routing.
- Check that quick-tach on unit fits onto skid loader properly. Pins must engage through 3/8" plates at bottom of quick-tach.
- Fully roll back attachment, make sure hoses do not pinch during roll back.
- Slowly roll attachment fully forward. Check that hoses are long enough so they do not stretch or bind. Check for interference between attachment and bottom side of loader arm.
- Do not connect this attachment to high flow couplers.
- Cycle scarifier up/down. Check for oil leaks per instructions in "Maintenance" section.
- Read and understand all warning information in this manual before operating this attachment.
- Never exceed the maximum attachment operating pressure of 3500 psi.

Operation

- Always follow safety information.
- Keep bystanders back 50 feet.
- Always follow all safety and operating instructions of skid loader.
- Always relieve pressure before disconnecting hydraulic hoses.
- Never hit or pound couplers.
- Never hook a chain on attachment.
- Check for debris in quick-tach area before each hook-up.

Scarifier Assembly

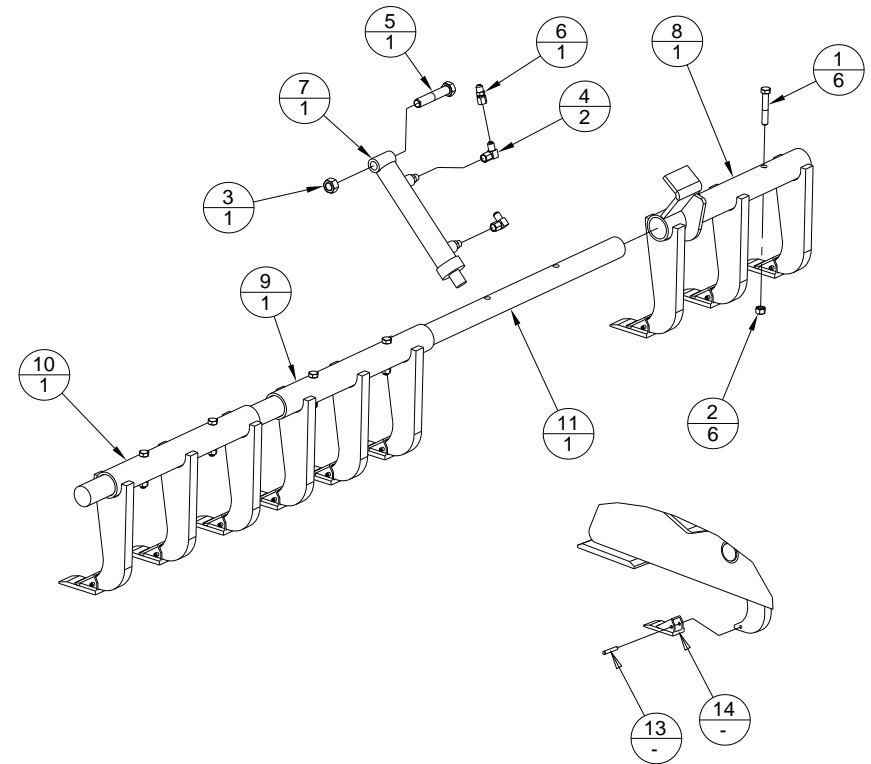

Note: Restrictor fitting (Item #6), plumbed to barrel end of cylinder.

Land Leveler Assembly

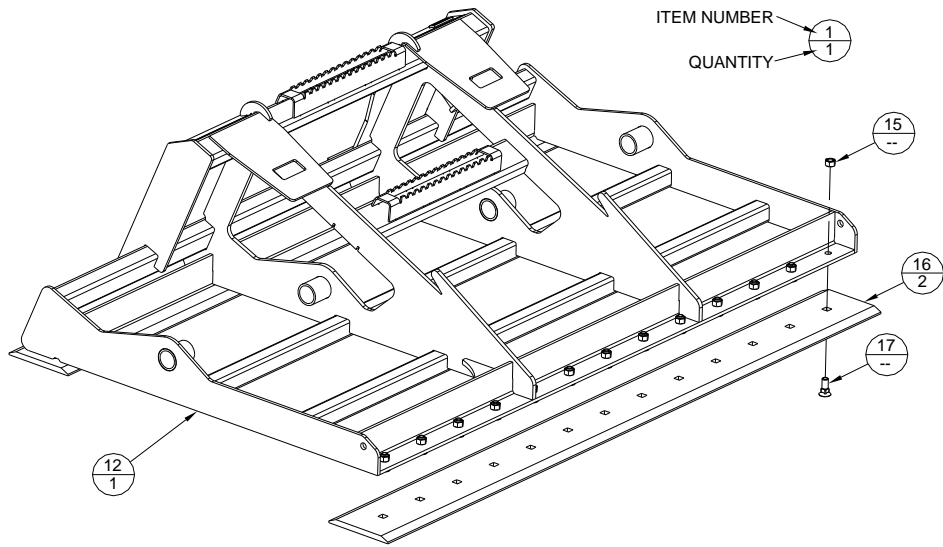

Center Plumb works for Case, John Deere, New Holland, Mustang, Takeuchi, and Gehl skid loaders.

Hoses need to be secured so they do not get damaged during operation. Hoses can be routed as shown in the picture above. Hoses can also be tied or bungeed to the skid loader cross member (close to the lower pivot) to hold them from getting pinched or stretched.

Attachment can also be Left Side Plumbed. Please see picture on the next page showing Left Side Plumb. Hoses should be run through the bracket on the skid loader arm, as shown, or the hoses can be tied or bungeed to the skid loader arm.



Land Leveler with Scarifier (LLV/SK) Parts List (cont.)

Table 1

	LLV72 W/SK72	LLV78 W/SK78	LLV84 W/SK84	LLV90 W/SK90
LLV FRAME WELDMENT	11171VW	11179VW	11184VW	11188VW
OUTER SCARIFIER WELDMENT LH	6893VW	6893VW	6895VW	6908VW
CENTER SCARIFIER WELDMENT	6900VW	6894VW	6904VW	6911VW
OUTER SCARIFIER WELDMENT RH	6895VW	6895VW	6895VW	6908VW
SCARIFIER SHAFT	6902VP	6898VP	6906VP	6910VP
# OF TEETH & ROLL PINS	9	9	9	10
# OF BOLTS AND NUTS	24	26	28	26
BOLT ON EDGE 5/8"	LLVBEV72	BEV78	BEV84	BEV90
WEIGHT (lb)	850	940	990	1050

Left Side Plumb, works for Cat, Bobcat, Kubota, Terex and ASV.

Land Leveler with Scarifier (LLV/SK) Parts List

ITEM	PART NO.	QTY	DESCRIPTION	
	1	1002PP	6	1/2"-13 X 3" LG HHCS
	2	1003PP	6	1/2"-13 REVERSE LOCK NUT
	3	1011PP	1	3/4"-10 TOP LOCK NUT
	4	1012PP	2	ELBOW 90 6FJX TO 6MJ
	5	1085PP	1	3/4"-10 X 4" LG HHCS
	6	1132PP	1	1/32" DIA RESTRICTOR FITTING IN LINE 6 JIC
	7	1134PP	1	SCARIFIER CYLINDER
A	8	-----	1	OUTER SCARIFIER WELDMENT LH
A	9	-----	1	CENTER SCARIFIER WELDMENT
A	10	-----	1	OUTER SCARIFIER WELDMENT RH
A	11	-----	1	SCARIFIER SHAFT
A	12	-----	1	LLV FRAME WELDMENT
A	13	1006PP	-	5/16" X 2" LG SPRING PIN
A	14	1007PP	-	TOOTH SCARIFIER
A	15	1008PP	-	5/8"-11 TOP LOCK NUT
A	16	-----	2	BOLT ON EDGE 5/8"
A	17	5585PP	-	5/8"-11 X 1 3/4" LG PLOW BOLT
B	18	1128PP	2	HYD HOSE 1/4" X 88" LG 6FJX TO 6FJX
		1142PP		HYD HOSE 1/4" X 96" LG 6FJX TO 6FJX
B	19	9333PP	1	COUPLER FEMALE STD 90 6MJ
B	20	9334PP	1	COUPLER MALE STD 90 6MJ

A - See Table 1.

B - Item not shown.



If needed, additional small elbows (Part No. 1012PP) are zip tied to the attachment and can be installed between hoses and couplers, as shown above, to improve hose routing at hydraulic coupler interface on loader. The additional elbows will not be required for most brands of skid loaders.

Maintenance

*Every 10 hours of operation

- Inspect cylinder, hydraulic fittings, and hoses for leaks and damage. Replace as needed. Make sure skid loader is shut off and hydraulic pressure is relieved before checking for leaks. Never use hands to check for high pressure hydraulic leaks.

*Every 50 hours of operation

- Check that the cylinder is secure.
- Check that all teeth on scarifier are secure.
- Check for loose, worn, or missing parts. Repair or replace as needed.
- Contact your dealer for replacement parts.

Labels on Land Leveler with Scarifier



5263PP – PINCH POINT WARNING LABEL

Always keep hands clear when skid loader hydraulic system is operational.



5265PP – HYDRAULIC WARNING LABEL

This label has several important instructions that must be followed for safe operation of this attachment.

Land Leveler with Scarifier Label Parts List

ITEM	PART NO.	QTY	DESCRIPTION
1	5263PP	2	PINCH POINT WARNING LABEL
2	5265PP	1	HYDRAULIC WARNING LABEL
3	9397PP	1	72 WIDTH LABEL
	9398PP		78 WIDTH LABEL
	9399PP		84 WIDTH LABEL
	9400PP		90 WIDTH LABEL
4	SERIALTAG	2*	SERIAL NUMBER TAG

*One label used for the Land Leveler and one label used for the Scarifier.

