

# VIRNIG MFG INC.

## High Dump Bucket

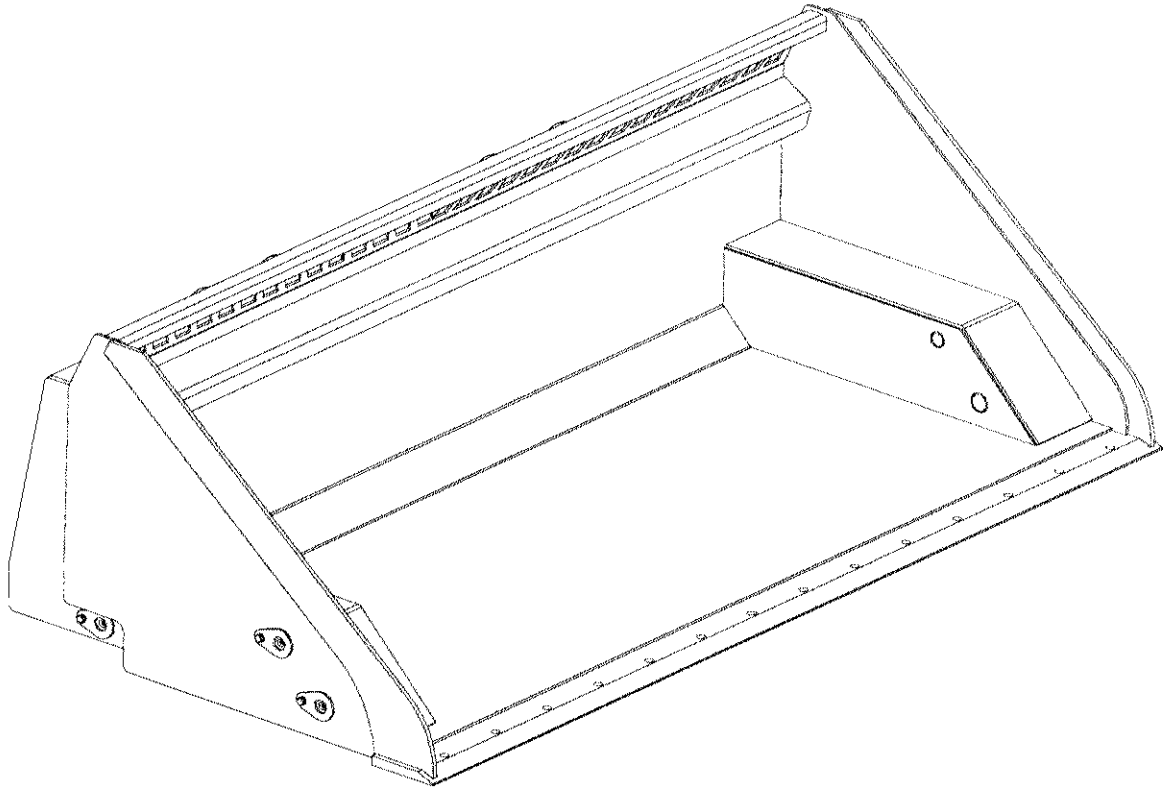

### OWNERS/OPERATORS MANUAL

Model Number \_\_\_\_\_ DMP \_\_\_\_\_

Serial Number \_\_\_\_\_

Date of Manufacture \_\_\_\_\_

Phone: 320-393-7080

12/03/2008



# Warranty

Virnig Manufacturing, Inc. products are warranted to be free from defects, in workmanship, for one year from the end users date of purchase.

Purchased components on Virnig Manufacturing, Inc. products are subject to the warranty of original Manufacturer.

This warranty is void on products that have been Modified or Repaired without the prior consent of Virnig Manufacturing, Inc.

Virnig Manufacturing, Inc. does not warrant damage from misuse, accidents, or negligence nor damage to machine or surrounding environment.

Claims are limited to replacement parts and a reasonable labor amount. This warranty does not cover service mileage, downtime, or replacement of attachment.

Upon request for warranty claim an RGA number will be assigned and replacement parts sent prepaid ground freight and invoiced. Defective parts need to be returned prepaid to Virnig Manufacturing, Inc. for warranty consideration. Upon inspection, account will be credited for defective part.

Please call Virnig Manufacturing at 320-393-7080 with any questions regarding warranty.



## **Features of Virnig Mfg. Inc. High Dump Bucket include:**

1. 2 1/2" bore x 8 3/8" stroke cylinders.
2. Optional 5/8" x 8" reversible bolt-on edge.
3. Increases vertical lift by approximately 44".
4. Increases horizontal reach by approximately 13".
5. Replaceable bushings at hinge pivot points.
6. Constructed with heavy plate for strength and durability.
7. Recommended for skid loaders with a lift capacity over 1800 lbs.

## **Initial Use**

- See following page for suggested hose routing.
- Check that quick-tach on bucket fits onto skid loader properly. Pins must engage through 3/8" plates at bottom of quick-tach.
- With bottom of attachment touching ground/floor, slowly roll back bucket. Make sure there is no interference between attachment and loader with attachment fully rolled back.
- Make sure hoses do not pinch during roll back.
- Lift bucket off ground/floor approximately 24" and dump by extending the attachment hydraulic cylinders. Slowly roll bucket fully forward, lifting bucket as necessary. Check that hoses are long enough so they do not stretch or bind.
- Can loosen and adjust angle on elbow adapters to improve hose routing.
- Do not connect this attachment to high flow couplers.
- Cycle bucket open/close. Check for oil leaks per instructions in maintenance section.
- Read and understand all warning information in this manual before operating this attachment.
- Never exceed the maximum attachment operating pressure of 3500 psi.





Grapple is shipped Center Plumbed, as shown above. The lead hoses are connected under the center step of the grapple. Center Plumb works for Case, John Deere, New Holland, Mustang, Takeuchi, Volvo and Gehl skid loaders.

Hoses need to be secured so they do not get damaged during operation. Hoses can be routed as shown in the picture above. Hoses can also be tied or bungeed to the skid loader cross member (close to the lower pivot ) to hold them from getting pinched or stretched.

Grapple can also be Left Side Plumbed. Left Side Plumb works for Cat, Bobcat and ASV. Grapple can be converted to Left Side Plumb by following instructions located in this manual. Please see picture below showing Left Side Plumb. Hoses should be run through the bracket on the skid loader arm, as shown, or the hoses can be tied or bungeed to the skid loader arm.



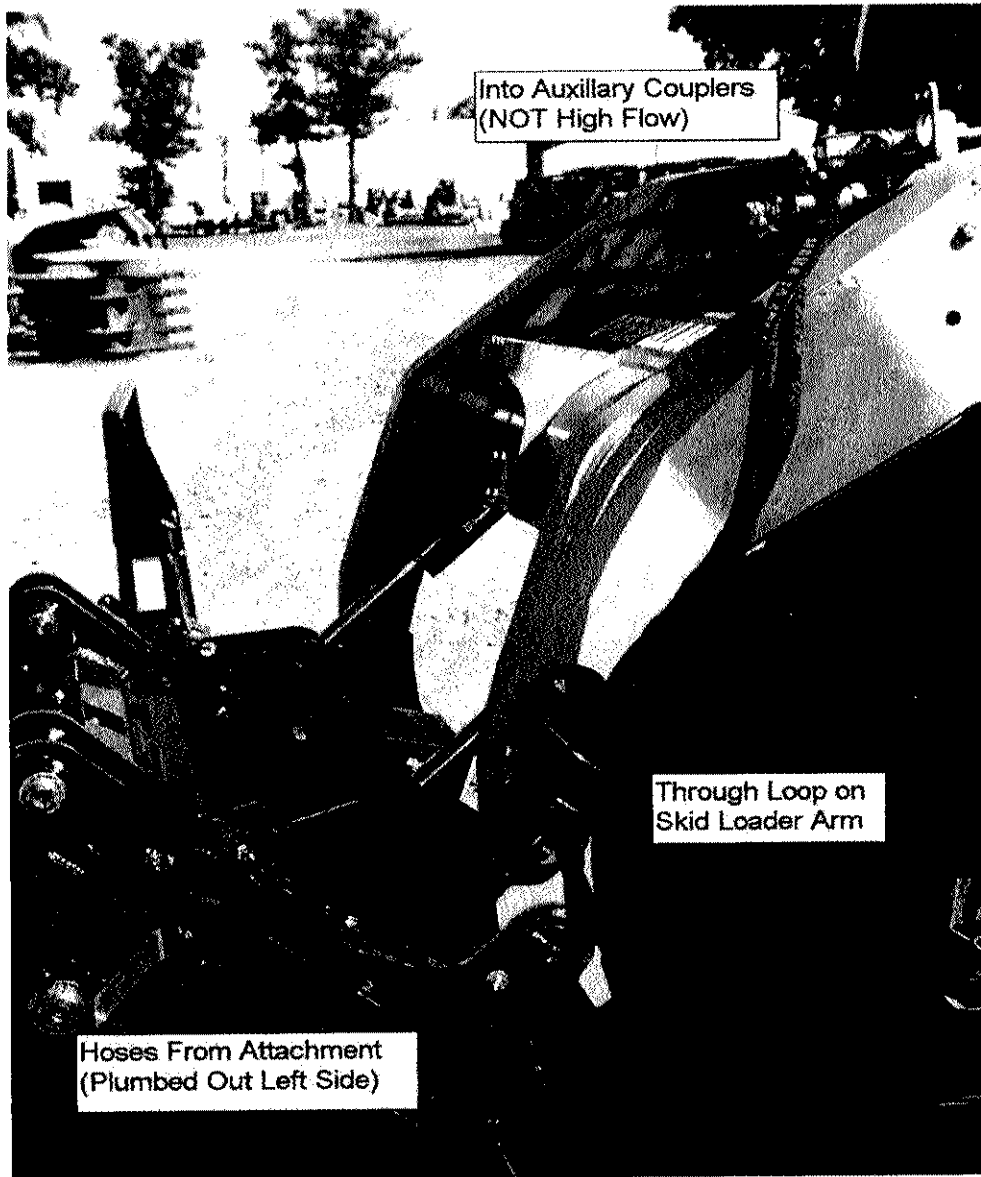

If there is too much slack hose, the amount of slack can be adjusted using the clamp on the attachment near the mount plate.

<u>ITEM</u>	<u>PART NO.</u>	<u>QTY</u>	<u>DESCRIPTION</u>
LEAD HOSE	1127PP	2	HYD HOSE 72 LG, BOTH ENDS #6 JIC FEMALE (37° FLARE)
	1126PP	2	HYD HOSE 80 LG, BOTH ENDS #6 JIC FEMALE (37° FLARE)
	1128PP	2	HYD HOSE 88 LG, BOTH ENDS #6 JIC FEMALE (37° FLARE)
	1142PP	2	HYD HOSE 96 LG, BOTH ENDS #6 JIC FEMALE (37° FLARE)
	1143PP	2	HYD HOSE 102 LG, BOTH ENDS #6 JIC FEMALE (37° FLARE)
ADAPTER	1144PP	2	90° SOLID ELBOW, #6 MALE JIC - #8 O-RING THREAD
	1145PP	2	STRAIGHT ADAPTER, #6 MALE JIC - #8 O-RING THREAD
	1141PP	2	90° SOLID ELBOW, #6 MALE JIC - #8 (1/2") PIPE THREAD
	1124PP	2	STRAIGHT ADAPTER, #6 MALE JIC - #8 (1/2") PIPE THREAD
COUPLERS	5582PP	1	FLAT FACE COUPLERS, MALE/FEMALE PAIR

NOTE: THIS UNIT PLUMBED WITH HIGHLIGHTED COMPONENTS



## Operation

- Always follow safety information.
- Keep bystanders back 50 feet.
- Never attempt to lift more than the operating capacity (attachment weight and load) of skid loader. See Table 1 for attachment weight. The use of this attachment will effectively decrease the operating capacity of the skid loader.
- Always follow all safety and operating instructions of skid loader.
- Always relieve pressure before disconnecting hydraulic hoses.
- Never hit or pound couplers.
- Never hook a chain on bucket.
- Check for debris in quick-tach area before each hook-up.

## Maintenance

### \*Every 10 hours of operation

- Grease hinge pins and cylinder pins (6 grease fittings total).
- Inspect cylinders, hydraulic fittings, and hoses for leaks and damage. Replace as needed. Make sure skid loader is shut off and hydraulic pressure is relieved before checking for leaks. Never use hands to check for high pressure hydraulic leaks.

### \*Every 50 hours of operation

- Check that all cylinder and hinge pins are secure.
- Check for loose, worn, or missing parts. Repair or replace as needed.
- Contact your dealer for replacement parts.



# WARNING LABELS ON HIGH DUMP ATTACHMENT

## ⚠ WARNING

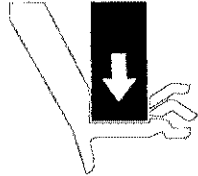

### PINCH POINT

- Keep hands clear during operation.
- Always shut off skid loader and relieve pressure before inspecting or repairing.
- Failure to follow these instructions could result in injury or death.

This label is located near hinge area on bucket.

Always keep hands clear of attachment when skid loader hydraulic system is operational.

## ⚠ WARNING

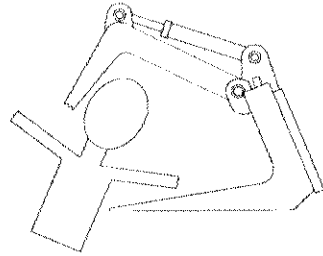

### CRUSH HAZARD

- Stay back 50 feet during operation.
- Failure to follow this instruction could result in injury or death.

This label is located near hinge area on bucket.

Always stay clear of bucket. Never inspect attachment with skid loader running.

## ⚠ WARNING

- NEVER use hands to check for oil leaks.
- ALWAYS relieve pressure before disconnecting hoses.
- Read and understand all operating and safety instructions in owners manual.
- Attachment Weight and Load MUST NOT exceed Operating Capacity of Skid Loader (refer to skid loader manual for capacity).
- THE USE OF THIS ATTACHMENT WILL EFFECTIVELY DECREASE THE OPERATING CAPACITY OF THE SKID LOADER. As the bucket is dumped, the weight of the material in the bucket is shifted forward decreasing the operating capacity of the Skid Loader.
- Load bucket evenly to avoid tipping.
- Use extra caution when handling material that will stick inside the bucket.
- Attachment must be securely latched to skid loader.
- Check for loose or broken parts before operating, repair as needed.
- Stay back 50 feet during operation.
- ALWAYS follow skid loader safety and operating instructions.
- Failure to follow these instructions could result in injury or death.

This label is located on the side of the bucket frame.

This label has several important instructions that must be followed for safe operation of this attachment.



# HIGH DUMP BUCKET (DMP) PARTS LIST

ITEM	PART NO.	QTY	DESCRIPTION
1	1013PP	2	TEE, 3-WAY #6 JIC MALE (37° FLARE)
2	1034PP	6	1/4"-28 UNF STRAIGHT GREASE FITTING
3	1067PP	4	HOSE CLAMP ASSEMBLY
4	1075PP	6	3/8" LOCK WASHER
5	1117PP	4	5/16" NC X 1 1/2" LG HHCS
A 6	-----	4	HYD HOSE, BOTH ENDS #6 JIC FEMALE
7	1132PP	1	1/32" RESTRICTED FITTING
8	5586PP	4	1 9/16" DIA X 1 9/16" LONG BUSHING
9	7350PP	2	MPV CYLINDER (2 1/2" BORE)
10	7810VW	2	DUMPOUT BUCKET ROD END PIN WELDMENT
11	7811VW	2	DUMPOUT BUCKET CYL. END PIN WELDMENT
12	7812VW	2	DUMPOUT BUCKET HINGE PIN WELDMENT
A 13	-----	1	DUMPOUT BUCKET WELDMENT
A 14	-----	1	DUMPOUT BUCKET FRAME WELDMENT
15	7849PP	4	3/8" NC X 1" LONG HHCS
16	7850PP	2	3/8" NC X 1 1/2" LONG HHCS

A - SEE TABLE 1

TABLE 1

	DMP72	DMP84	DMP96
HYD HOSE	1125PP	1125PP	1127PP
BUCKET WELDMENT	8037VW	7815VW	8045VW
BUCKET FRAME WELDMENT	8038VW	7816VW	8046VW
WEIGHT (lbs)	1010	1100	1180





# MAIN COMPONENT ASSEMBLY

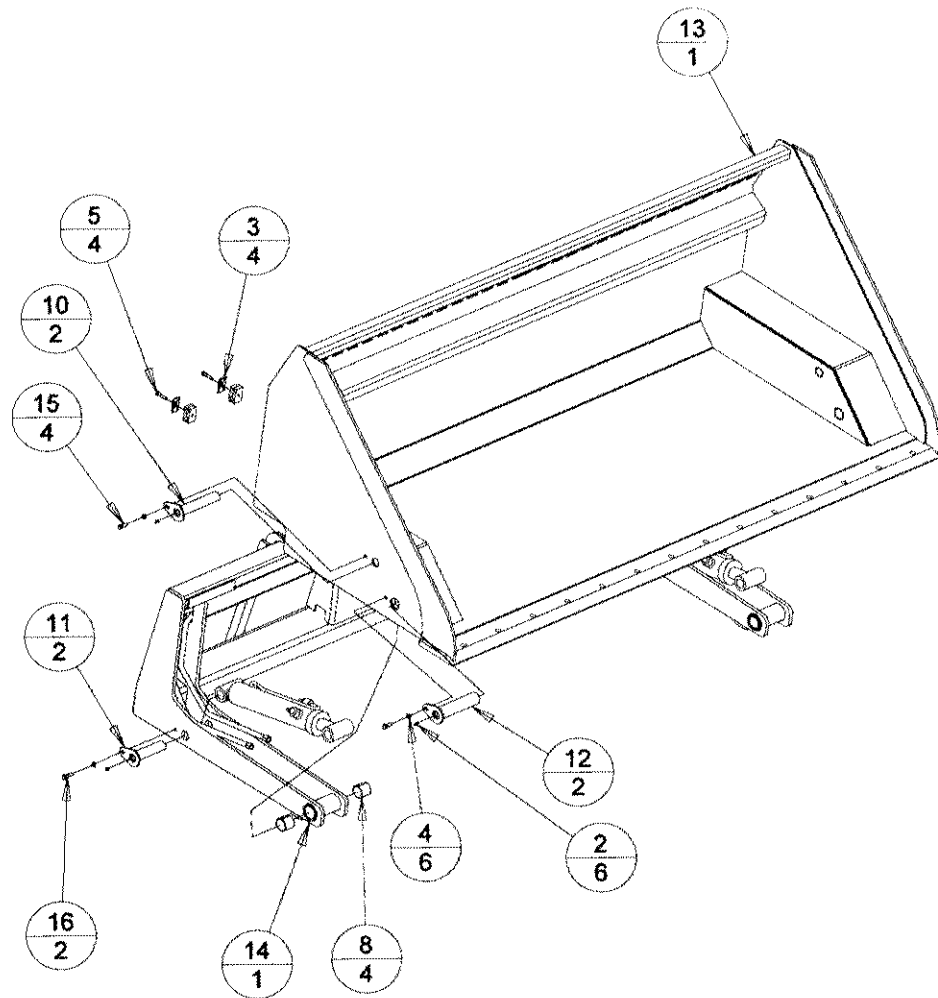
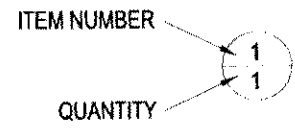

# HYDRAULIC ROUTING AND INSTALLATION

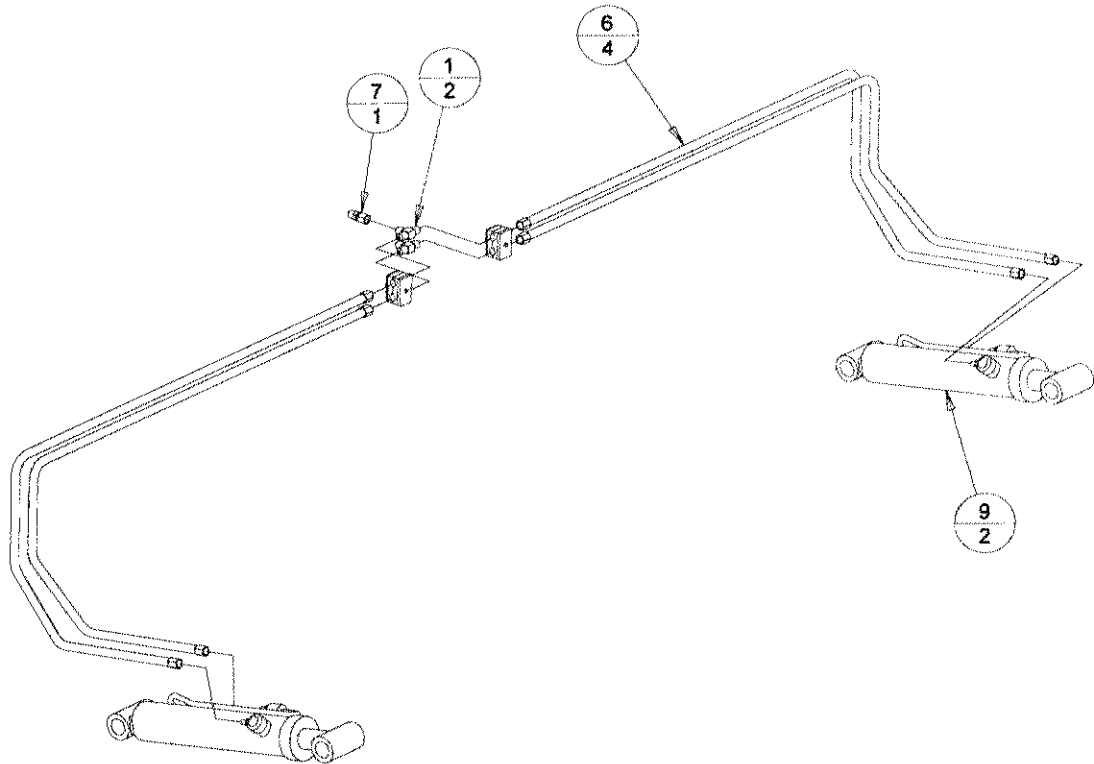

**NOTE: BOTH RIGHT SIDE CYLINDER PORTS MUST BE PLUMBED TOGETHER.  
BOTH LEFT SIDE CYLINDER PORTS MUST BE PLUMBED TOGETHER.  
RESTRICTED FITTING (ITEM 7), PLUMBED TO ROD ENDS OF CYLINDERS.**

