



Works With

- Concrete
 - Asphalt
 - Sand
 - Washed Gravel
 - Wildlife Feed
 - Agricultural Grains
- Patented rubber flighted auger prevents coarse material from binding.
 - Skid-steer quick attach on both sides allow left or right hand discharge.
 - Multi-link chutes allow for greater reach. 5' of chutes are included with each bucket.
 - Standard 1/2 yard capacity can be increased with bolt-on hopper extensions.

Auger Bucket Specifications



Discharge Auger

The standard rubber flighted auger. Handles most materials.

Mixing Auger

Paddles and reinforced rubber flighting allows for concrete to be mixed directly in the bucket.

Steel Auger

Used for discharging asphalt and dry mixtures or materials.

- Self-loading from loose piles. Optional weld-on cutting edge available.
- Accurate and controlled discharge - 1/2 yard in 50 seconds.
- Hydraulic direct drive powered by Eaton motors.
- Replaceable bolt-on rubber flighting.
- Reinforced auger available for use as a concrete mixer.
- Steel only auger for use with asphalt, sand, and other dry materials.

Model	3000 Series
Length	73.5"
Width	22.5"
Height	29.5"
Weight	380 lbs.
Volume	13 cu. ft.
Volume – Incl. Extension	28 cu. ft.
Min. Hyd. Requirements	12 GPM
Auger Length	61.5"
Auger Diameter – Without Rubber	4.0"
Auger Diameter – With Rubber	6.5"
Flighting Spacing	4.0"

Auger Bucket Options

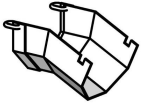

Chute Angle Increaser

Part # 87141

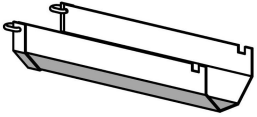

24" Chute - Multi-link chutes. Auger Bucket includes 1 by default.

Part # 87139

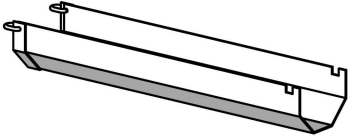

36" Chute - Multi link chutes. Auger Bucket includes 1 by default.

Part # 87140

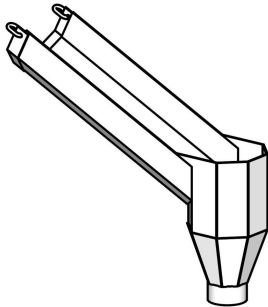
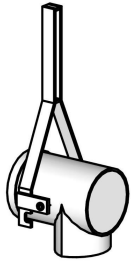

Hose Adapter - Can be used for slurry mix, filling block walls, etc.

4" Hose Adapter (Right) - Part # 87136

6" Hose Adapter (Left) - Part # 90224

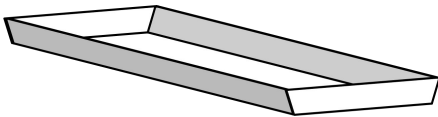

Weld-On Cutting Edge - For loading from frozen/hard piles.

Part # 87137

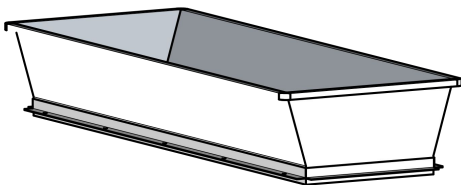

3/4 Yard Hopper Extension - Increases the capacity of the auger bucket from 1/2 yard to 3/4 yard. Bolt-on.

Part # 87134

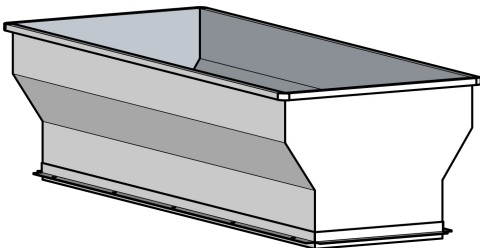

1 Yard Hopper Extension - Increases the capacity of the auger bucket from 1/2 yard to 1 yard. Bolt-on. For tractors with skid-steer loader mount only.

Part # 87133

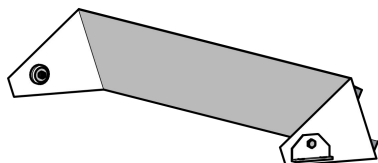

Spill Guard - Keeps material from spilling when traveling with a full bucket. Bolt on.

Part # 90001