

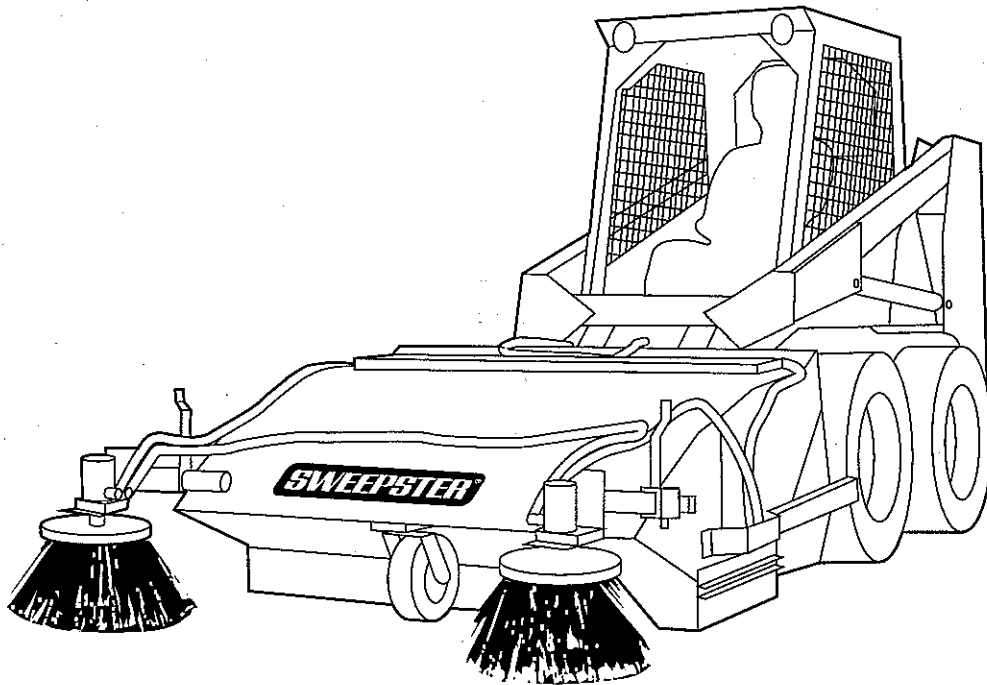

## HBB Series

Pickup Sweepers for  
Tractor & Skid Steer Loaders



SWEEPSTER, Inc.  
2800 N. Zeeb Road • Dexter, MI 48130  
(734) 996-9116 • FAX (734) 996-9014  
1-800-456-7100  
[www.sweepster.com](http://www.sweepster.com)



# Contents

<b>Introduction</b> .....	<b>4-5</b>	Installing Bucket & Sweeper .....	17
Serial & Part Numbers .....	4	Removing Sweeper Only .....	17
Importance of this Manual .....	5	Installing Sweeper .....	17
Purpose of Sweeper .....	5	Brushes .....	17
Safety Alert Symbol .....	5	<b>Maintenance</b> .....	<b>18-19</b>
Contacting SWEEPSTER .....	5	Replacing Brush Sections .....	18
Terms Used in Manual .....	5	Lubricating the Sweeper .....	19
Optional Equipment .....	5	Maintaining Hydraulics .....	19
Specifications & Features .....	5	<b>Main Sweeper</b> .....	<b>20-25</b>
Warranty .....	5	<b>Hydraulic Motor</b> .....	<b>26</b>
<b>Safety Information</b> .....	<b>6-7</b>	<b>Buckets</b> .....	<b>27-28</b>
Read this Manual .....	6	<b>Universal Mounting</b> .....	<b>29</b>
Hazard Definitions .....	6	<b>Hook Points</b> .....	<b>30</b>
Operation .....	6	<b>Option – Dual Motor Kit</b> .....	<b>31-32</b>
Service & Repair .....	7	Installation .....	31
<b>Safety Signs &amp; Labels</b> .....	<b>8-9</b>	Parts List .....	32
Important .....	8	<b>Option – Gutter brush</b> .....	<b>33-40</b>
Locations .....	8	Installing Gutter Brushes .....	33
Representations of labels .....	9	Adjusting Gutter Brush Contact Area .....	34
<b>Installation</b> .....	<b>10-14</b>	Adjusting Gutter Brush Swing .....	34
Notice .....	10	Using Gutter Brushes .....	35
Installing Main Sweeper – Customer Bucket .....	10	Replacing Gutter Brush .....	35
Installing Main Sweeper – Universal Mounting .....	11	Parts Lists .....	36-40
Installing Main Sweeper – Quick Attach Mountings .....	12	<b>Option – Sprinkler</b> .....	<b>41-47</b>
Installing Main Sweeper – Thomas .....	13	Installation .....	41-43
Installing Main Sweeper – GEHL .....	14	Parts Lists .....	44-47
<b>Adjustments</b> .....	<b>15</b>	<b>Option – Flow Divider</b> .....	<b>48-50</b>
Adjusting Chains .....	15	Hydraulic Hook-Up (No Gutterbrush) .....	48
Adjusting Main Sweeper .....	15	Hydraulic Hook-Up (Single Gutterbrush) .....	49
<b>Operation</b> .....	<b>16</b>	Hydraulic Hook-Up (Dual Gutterbrush) .....	50
Notice .....	16	<b>Torque Values</b> .....	<b>51</b>
Operation .....	16	<b>Warranty Information</b> .....	<b>52-53</b>
Tips .....	16	<b>Glossary</b> .....	<b>54-55</b>
<b>Storage</b> .....	<b>17</b>		
Removing Bucket & Sweeper .....	17		

# Introduction

## Serial & Part Numbers

On your unit you will find a serial number plate and/or part number plate(s). The numbers on these plates are very important if you wish to order parts or accessories. For your convenience, record numbers in the appropriate spaces below.

<b>SWEEPSTER</b>	
Model #	Serial #
<input type="text"/>	<input type="text"/>
Empty	GVW
<input type="text"/>	<input type="text"/>
Dexter, MI 48130 1-800-456-7100	

<b>SWEEPSTER</b>	
Dexter, MI 48130 1-800-456-7100	
Part Number	Date
<input type="text"/>	<input type="text"/>

<b>SWEEPSTER</b>	
Dexter, MI 48130 1-800-456-7100	
Part Number	Date
<input type="text"/>	<input type="text"/>

<b>SWEEPSTER</b>	
Dexter, MI 48130 1-800-456-7100	
Part Number	Date
<input type="text"/>	<input type="text"/>

# Introduction

## Importance of this Manual

This operator's manual should be regarded as part of the sweeper. Suppliers of both new and secondhand sweepers are advised to keep documentation indicating that this manual was provided with the sweeper.

The manual contains information regarding installation, operation and maintenance required for this sweeper model and optional equipment. It also includes detailed parts lists.

## Purpose of Sweeper

This sweeper is designed solely for use in construction cleanup, road maintenance, grounds maintenance, snow removal and similar operations. Use in any other way is considered contrary to the intended use. Compliance with and strict adherence to operation, service and repair conditions, as specified by the manufacturer, are also essential elements of the intended use.

This sweeper should be operated, serviced and repaired only by persons who are familiar with its characteristics and acquainted with relevant safety procedures.

Accident prevention regulations, all other generally recognized safety regulations and all road traffic regulations must be observed at all times.

Any modifications made to this sweeper may relieve the manufacturer of liability for any resulting damage or injury.

## Safety Alert Symbol

 This safety alert symbol indicates important safety messages in this manual. When you see this symbol, be alert to the possibility of injury. Carefully read the message that follows and inform other operators.

## Contacting SWEEPSTER

If you have any questions about information in this manual or need to order parts, please call, write, FAX or e-mail SWEEPSTER.

SWEEPSTER, Inc.  
2800 North Zeeb Road  
Dexter, Michigan 48130  
Phone: (734) 996-9116 • (800) 456-7100  
FAX: (734) 996-9014  
e-mail: sweep@sweepster.com

For help with installation, operation or maintenance procedures, contact our Technical Service Department. Direct product questions and parts orders to our Sales Department.

When ordering parts or accessories, be prepared to give the following information:

- Sweeper model, serial number and date of purchase
- Prime mover make and model
- Part number, description and quantity

## Terms Used in Manual

*Right-hand, left-hand, front and rear* are determined from the operator's perspective (either the operator's seat or standing behind a walk-behind unit), facing forward in the normal operating position.

*Prime mover* refers to the tractor, truck, loader or tow vehicle that a sweeper is mounted on or towed by.

## Optional Equipment

Installation instructions for optional equipment, if applicable, appear with parts lists in the back of the manual.

## Specifications & Features

Due to continuous product improvement, specifications and features may change without notice.

## Warranty

To validate the warranty for this unit, fill out the warranty card or warranty pages located at the back of this manual. Then, send this information to SWEEPSTER.

# Safety Information

## Read this Manual

Read all safety information in this manual. All operators must read and understand the entire contents of this manual before sweeping. General safety practices are listed on Safety Information pages and specific safety information is located throughout this manual.

## Hazard Definitions

Four hazard classifications are used in this manual. They are

 **CAUTION** – Indicates a potentially hazardous situation which, if not avoided, may result in minor or moderate injury.

 **WARNING** – Indicates a potentially hazardous situation which, if not avoided, could result in death or serious injury.

 **DANGER** – Indicates an imminently hazardous situation which, if not avoided, will result in death or serious injury.

**IMPORTANT** – Used for instructions when machine damage may be involved.

## Operation

 **CAUTION** – A sweeper is a demanding machine. Only fully trained operators or trainee operators under the close supervision of a fully trained person should use this machine.

Before sweeping:

- Learn sweeper and prime mover controls in an off-road location.
- Be sure that you are in a safe area, away from traffic or other hazards.
- Check all hardware holding the sweeper to the prime mover, making sure it is tight.
- Make sure all hydraulic fittings and hardware are tight.
- Replace any damaged or fatigued hardware with properly rated fasteners.

- Check prime mover tire pressure before sweeping.
- Check tire ratings to be sure they match the prime mover load. Weigh the sweeper end of the prime mover, if necessary, to insure proper tire rating.
- Remove from the sweeping area all property that could be damaged by debris flying from the sweeper.
- Be sure all persons not operating the sweeper are clear of the sweeper discharge area.
- Always wear proper apparel such as a long-sleeve shirt buttoned at the cuffs; safety glasses, goggles or a face shield; ear protection; and a dust mask.

When sweeping, adhere to all government rules, local laws and other professional guidelines for your sweeping application.

 **WARNING** – Never raise the sweeper more than a few feet off the ground. The sweeper can tip back or the prime mover can tip over causing death or serious injury.

Before leaving the operator's area for any reason – lower the sweeper to the ground, stop the prime mover engine, set the brakes and remove the key from the ignition.

Minimize flying debris – use the slowest brush speed that will do the job.

Keep hands, feet, hair and loose clothing away from all moving parts.

Leave the brush hood (shield) and all other shields and safety equipment in place when operating the sweeper and prime mover.

Be aware of the extra weight and width a sweeper adds. Reduce travel speed accordingly.

When sweeping on rough terrain, reduce speed to avoid “bouncing” the sweeper. Loss of steering can result.

Never sweep toward people, buildings, vehicles or other objects that can be damaged by flying debris.

## Safety Information

### Service & Repair



**CAUTION** – Do not modify the sweeper in any way. Personal injury could result. If you have questions, contact your dealer or SWEEPSTER.

Repair or adjust the sweeper in a safe area, away from road traffic and other hazards.

Before adjusting or servicing the sweeper – lower the sweeper to the ground, stop the prime mover engine, set the brakes and remove the key from the ignition.

When working on or around the sweeper, lower it to the ground or secure it with transport chains or cylinder-stop locks.

Stop the prime mover engine and cycle control levers to release hydraulic pressure before servicing or adjusting sweeper hydraulic systems.



**WARNING** – Escaping hydraulic fluid can have enough pressure to penetrate the skin, causing serious personal injury.

---

# Safety Signs & Labels

## Important

Always keep safety signs clean and readable, and always replace any damaged or missing safety signs with new ones from SWEEPSTER.

Safety sign and label locations are shown below. For representations of these safety signs and labels, refer to page 9.

## Locations

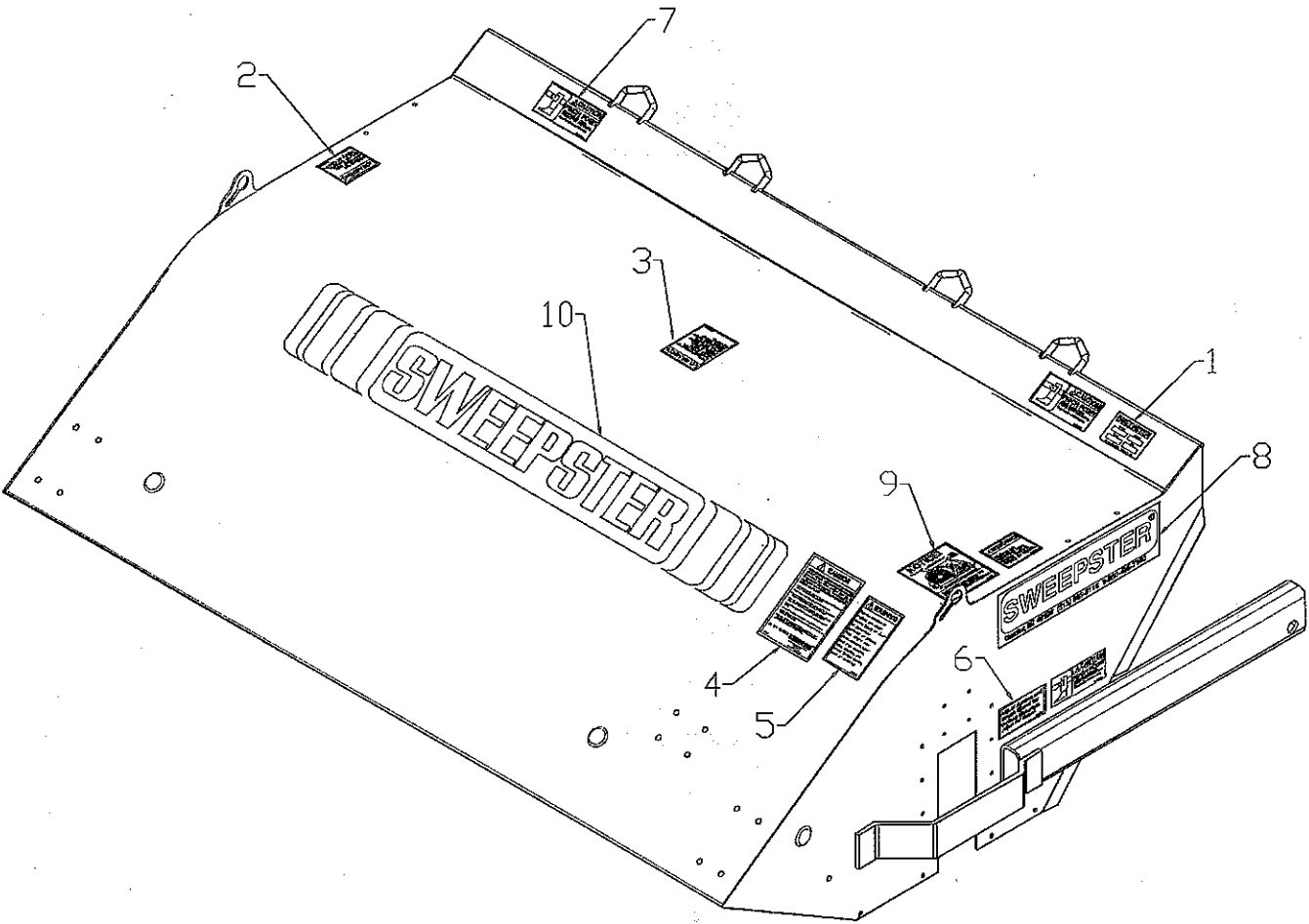

Item	Part	Qty	Description
1.	50-0004	1	Label, Serial Number
2.	50-0008-1	2	Label, Danger, No Riders
3.	50-0013-1	1	Label, Danger, Falling Sweeper & Loader Arms
4.	50-0014-1	1	Label, Caution, Read Manual
5.	50-0014-2	1	Label, Caution, Running Sweeper & Engine
6.	50-0023-1	2	Label, Adjust Aprons for Various Materials
7.	50-0076-1	4	Label, Caution, Pinch Point
8.	50-0203	1	Label, Sweep Direction, HB
9.	50-0185	2	Label, Medium, White, Logo
10.	50-0252	1	Label, Logo, Large, White, Die-Cut



# Safety Signs & Labels

## Representations of Labels

Locations shown on page 8.



1. 50-0004



2. 50-0008-1



3. 50-0013-1



4. 50-0014-1

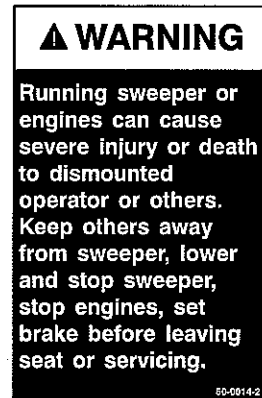

5. 50-0014-2



6. 50-0023-1



7. 50-0076-1

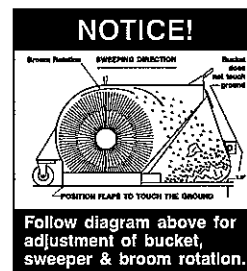

8. 50-0203



9. 50-0185



10. 50-0252

# Installation

## Notice

**IMPORTANT** – For single motor units, hydraulic flow must range from 8 to 15 gpm (30.28 to 56.85 liters/min) at 1,800 psi (124.14 bars). For dual motor units, hydraulic flow must range from 15 to 25 gpm (56.58 to 113.60 liters/min) at 1,800 psi (124.14 bars).

## Installing Main Sweeper – Customer Bucket

**NOTE** – For Thomas units, follow instructions on page 13. For GEHL units, see page 14.

**NOTE** – You must purchase a bolt-on bracket kit to use your own bucket.

1. Locate brackets on the bucket as shown in figure 1. Transfer punch and then drill holes. Use a 13/32 in. bit on the side brackets and a 17/32 in. bit on the rear brackets.
2. Attach rear mounting brackets to the rear of the bucket and angle brackets to the sides with hardware provided.
3. Connect the sweeper to the bucket by attaching the sweeper side arms to the rear mounting brackets with pins provided.
4. Attach chains to a convenient location on the prime mover arms, such as a cross bar or step. Leave the chains loose with equal slack on both (figure 2). Do not entangle hydraulic hoses when installing.

**NOTE** – Use 2 clevis pins, 2 rubber hoses and 2 quick links to attach the chain to the loader (figure 2).

**CAUTION** – Avoid equipment damage and personal injury. Chains must be of equal length and long enough to keep the sweeper level during dumping. Short chains may cause the sweeper to tip back and damage the sweeper body.

5. Connect hydraulic hoses to the prime mover's hydraulic remotes.
6. Make adjustments to the chains and main sweeper; see the Adjustments section.



figure 2

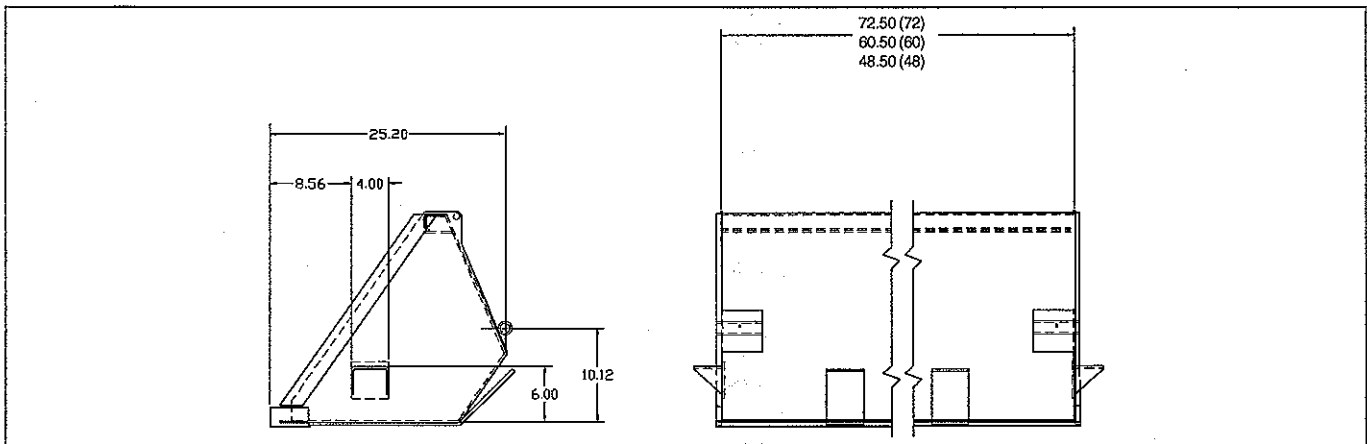

figure 1

# Installation

## Installing Main Sweeper – Universal Mounting

**NOTE** – Only prime movers without quick attaches use a universal mounting.

**NOTE** – Due to the number of different sized pins used in the industry, it may be necessary to modify the mounting plates by either drilling out the pin holes or fabricating bushings.

1. Attach the mounting frame to the bucket with hardware provided.
2. Install 4 bottom mounting plates to the bucket.
3. Attach the prime mover arms to the bottom mounting plates.
4. Attach the top mounting plates to the bucket. Use the set of holes that align the plates with the prime mover tilt cylinders (partially extended).
5. Pin tilt cylinders to the top mounting plates.
6. Attach chains to a convenient location on the prime mover arms, such as a cross bar or step. Leave the chains loose with equal slack on both (figure 3).



**CAUTION** – Avoid equipment damage and personal injury. Chains must be of equal length and long enough to keep the sweeper level during dumping. Short chains may cause the sweeper to tip back and damage the sweeper body.

7. Connect hydraulic hoses to prime mover remote hydraulics.
8. Make adjustments to the chains and main sweeper; see the Adjustments section.



figure 3

# Installation

## Installing Main Sweeper – Quick Attach Mountings

1. Install the sweeper on the prime mover's quick attach mounting.
2. Attach chains to a convenient location on the prime mover arms, such as a cross bar or step. Leave the chains loose with equal slack on both (figure 7). Do not entangle hydraulic hoses.

**NOTE** – Use 2 clevis pins, 2 rubber hoses and 2 quick links to attach the chain to the loader (figure 7).



**CAUTION** – Avoid equipment damage and personal injury. Chains must be of equal length and long enough to keep the sweeper level during dumping. Short chains may cause the sweeper to tip back and damage the sweeper body.

3. Connect hydraulic hoses to prime mover remote hydraulics.
  4. Make adjustments to the chains and main sweeper; see the Adjustments section.
-

# Installation

## Installing Main Sweeper – Thomas

**NOTE** – You must purchase a bolt-on bracket kit to use your own bucket. See page 20 or 22.

1. Mount hook points to the prime mover arms as shown in figure 5.
2. Transfer punch holes from brackets to the bucket. Drill holes in the bucket using dimensions shown in figure 6.
3. Attach the rear mounting brackets to the rear of the bucket and angle brackets to the sides with hardware provided.
4. Connect the sweeper to the bucket by attaching the sweeper side arms to the rear mounting brackets with pins provided.
5. Connect the sweeper/bucket assembly to the prime mover.
6. Attach chains to hook points with equal slack on both chains.

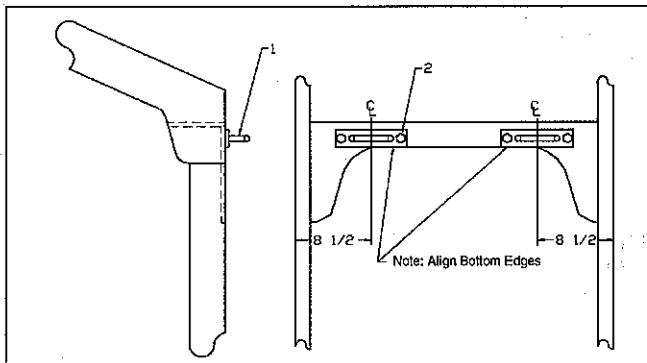

figure 5

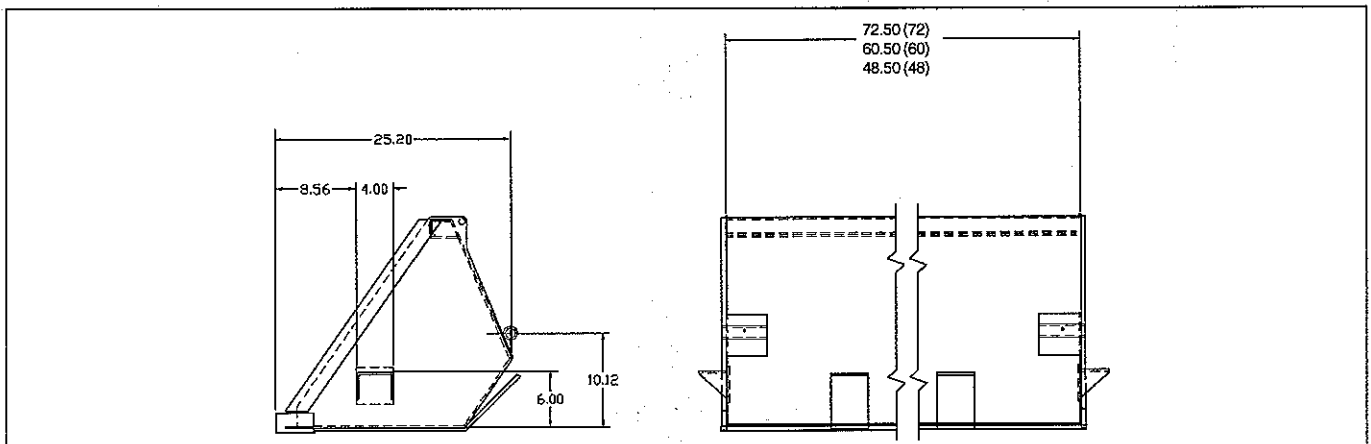

figure 6

**NOTE** – Use 2 clevis pins, 2 rubber hoses and 2 quick links to attach the chain to the loader (figure 7).



**CAUTION** – Avoid equipment damage and personal injury. Chains must be of equal length and long enough to keep the sweeper level during dumping. Chains that are too short may cause the sweeper to tip back during dumping.

7. Connect hydraulic hoses to the prime mover remote hydraulics.
8. Make adjustments to the chains and main sweeper; see the Adjustments section.



figure 7

# Installation

## Installing Main Sweeper – GEHL

1. Install the sweeper on the prime mover's quick attach mounting.
2. Attach chains to handles on the prime mover arms, as shown in figures A, B, and C. Use 2 rubber hoses and 4 quick links. Leave the chains loose with equal slack on both. Do not entangle hydraulic hoses.

**CAUTION** – Avoid equipment damage and personal injury. Chains must be of equal length and long enough to keep the sweeper level during dumping (figure D). Short chains may cause the sweeper to tip back and damage the sweeper body.

3. Connect hydraulic hoses to prime mover remote hydraulics.
4. Make adjustments to the chains and main sweeper; see the Adjustments section.



figure A

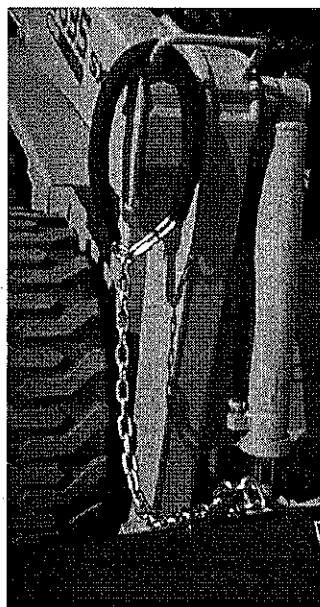

figure B



figure D



figure C

# Adjustments

## Adjusting Chains

1. Make sure chains are quite loose.
2. Raise the unit and then dump the bucket slowly. The unit will dump correctly if chains have the proper tension (figure 9). If the unit tips down when test dumping, go to step 3.
3. Tighten both chains by the same amount but no more than 2 links each.
4. Repeat steps 2 and 3 until the unit dumps correctly.

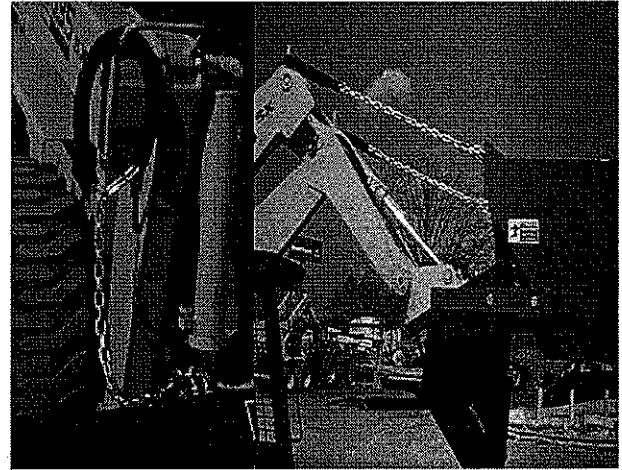

figure 9

## Adjusting Main Sweeper

A properly adjusted brush offers the best sweeper performance. To adjust the brush pattern:

1. Move the sweeper to a dusty, flat surface.
2. Set the prime mover brake; leave the engine running.
3. Start the sweeper at a slow speed; then, lower the sweeper bucket to 1 in. (25 mm) above the ground.
4. Run the sweeper in a stationary position for 30 seconds.
5. Raise the sweeper and back away.
6. Switch off the prime mover engine and remove the key.
7. Check the brush pattern left in the dust. The swept area should be 2-3 in. (51-76 mm) wide, running the length of the brush (figure 10).
8. If the brush pattern is not 2-3 in. (51-76 mm) wide, adjust the brush height.
  - If the the brush pattern is too wide, remove the pin (figure 11) and use a higher set of holes.
  - If the brush pattern is too narrow, remove the pin (figure 11) and use a lower set of holes.
9. Repeat steps 1-8 until the brush pattern is 2-3 in. (51-76 mm) wide.
10. Adjust the front and side flaps to contact the sweeping surface lightly and evenly.

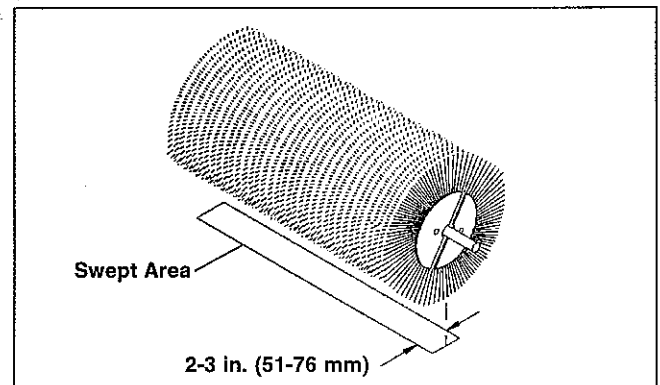

figure 10

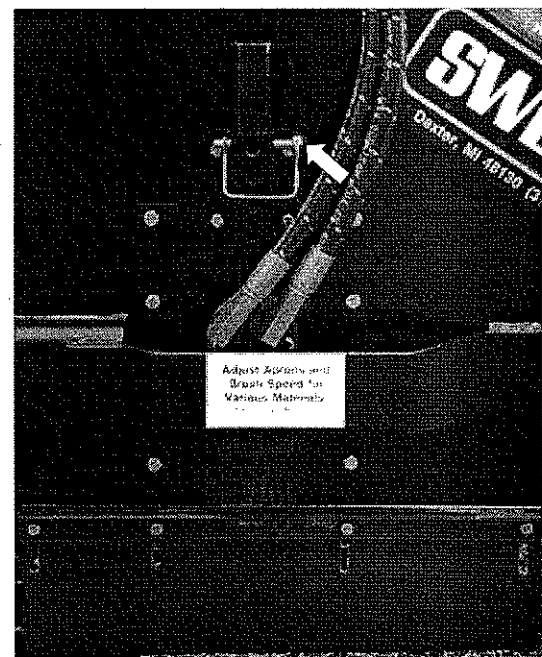

figure 11

# Operation

## Notice

**IMPORTANT** – For single motor units, hydraulic flow must range from 8 to 15 gpm (30.28 to 56.85 liters/min) at 1,800 psi (124.14 bars). For dual motor units, it must range from 15 to 25 gpm (56.58 to 113.60 liters/min) at 1,800 psi (124.14 bars).

## Operation

### Sweeping

This sweeper uses prime mover hydraulic flow to sweep. To start the brush, turn on the prime mover's hydraulic flow; to stop it, turn off the flow.

With this sweeper you sweep over the brush while moving forward (figure 12).

To increase or decrease brush speed, change the prime mover's engine rpm. Use the lowest speed that will complete the job. In general, half throttle provides plenty of engine speed.

The front caster feature allows the sweeper to follow ground contours. Therefore, do not run the sweeper with the prime mover in Float. Using Float allows the sweeper to drop too low and lift too high, resulting in poor sweeping and damage to the unit.

Use the bucket for collection only. It will wear quickly if used for scraping. Never operate the sweeper with the bucket less than 1 in. (25 mm) above the ground.

### Dumping

Empty the bucket by raising the sweeper above the container; then, dump using prime mover tilt controls.

**! DANGER** – Avoid electrical shock. Stay away from overhead wires when dumping.

**! CAUTION** – Avoid equipment damage and/or personal injury. Adjust the chains properly. Otherwise, the sweeper can tip back onto the lift arm during dumping.

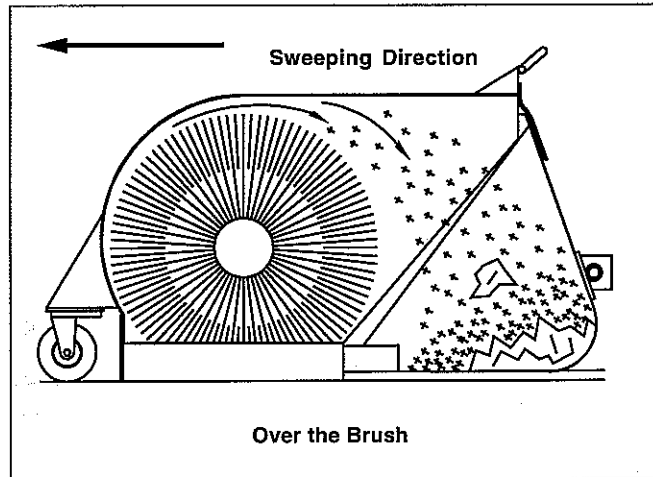

figure 12

### Stopping Sweeper

Never stop the sweeper at high engine speed. Decrease prime mover engine speed before stopping the hydraulic flow to the sweeper.

**IMPORTANT** – Avoid sweeper and motor damage. Decrease prime mover engine speed (rpm) before stopping hydraulic flow to disengage the sweeper.

## Tips

**Do** follow all safety precautions outlined in this manual.

**Do** operate the sweeper on flat, level surfaces only.

**Do** use low engine speed when sweeping to prevent excessive dust.

**Do not** run the sweeper in Float.

**Do not** engage or disengage the brush at a high engine speed. This damages the sweeper and motor.

**Do not** scrape with the bucket. It is for collection only and will wear prematurely if it is used for scraping. Never operate the sweeper with the bucket less than 1 in. (25 mm) from the ground.



## Storage

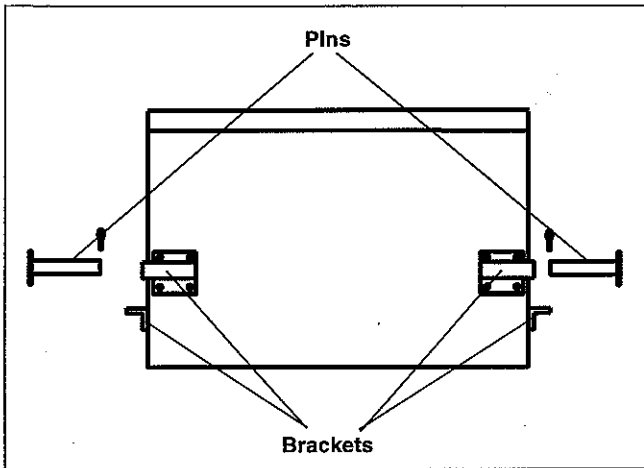

figure 13

### Removing Bucket & Sweeper

**WARNING** – Avoid serious injury. Lower and stop the sweeper, set the brake, stop the prime mover engine and remove the key before leaving, adjusting or repairing the sweeper.

1. Move the sweeper to a storage area.
2. Set the bucket on blocks to keep the brush off the ground during storage.
3. Disconnect and cap hydraulic lines.
4. Remove support chains from the prime mover.
5. Remove the bucket from the prime mover.
6. Move the prime mover away from the sweeper.

### Installing Bucket & Sweeper

1. Align the prime mover behind the sweeper.
2. Install the bucket on the prime mover.
3. Attach support chains.
4. Connect hydraulic lines.
5. Adjust according to Adjusting the Main Sweeper on page 15.

### Removing Sweeper Only

**WARNING** – Avoid serious injury. Lower and stop the sweeper, set the brake, stop the prime mover engine and remove the key before leaving, adjusting or repairing the sweeper.

**IMPORTANT** – The bucket is for collection only. Scraping with the bucket edge wears the bucket prematurely.

1. Move the sweeper to a storage area.
2. Place the sweeper on blocks to keep the brush off the ground during storage.
3. Disconnect and cap hydraulic lines.
4. Remove support chains from the prime mover.
5. Remove pins from the rear brackets (figure 13).
6. Move the prime mover away from the sweeper.

### Installing Sweeper

1. Align the prime mover behind the sweeper.
2. Pin sweeper side arms to the rear brackets.
3. Attach support chains to the prime mover.
4. Connect hydraulic lines.
5. Adjust according to Adjusting the Main Sweeper on page 15.

### Brushes

**IMPORTANT** – Do not store the sweeper with weight on the brush. This will deform bristles, destroying their effectiveness. To avoid this problem, place the sweeper on blocks.

Do not store polypropylene brushes in direct sunlight. They will deteriorate and crumble.

Keep polypropylene brush material away from intense heat or flame. It will melt.

## Replacing Brush Sections

**! WARNING** – Avoid serious injury. Lower and stop the sweeper, set the brake, stop the prime mover engine and remove the key before leaving the operator's seat.

1. Disconnect and then cap hydraulic lines to prevent contamination.
2. Remove flaps and adjustment lock pins from both sides of the sweeper.
3. Raise the sweeper, leaving the brush head on the ground.
4. Remove the retainer plate halves on the bearing end of the brush (single motor) or the end ring (dual motor).
5. Remove old sections.
6. Install new sections by doing the following:
  - a. Number the tubes on the core as 1, 2 and 3 (figure 14).
  - b. Slide the first section onto the core with the drive pins on either side of tube 1. Make sure that the drive pins angle up (figure 15).
  - c. Place the second section on the core with the drive pins on either side of tube 2. Be sure the drive pins angle down.
  - d. Put the third section on with the drive pins around tube 3. Be sure the drive pins angle up.
  - e. Slide sections on until the core is full, making sure to alternate the tubes used and the direction of the drive pins.
7. Replace the retainer plate halves or end ring.
8. Lay the brush on the ground.
9. Lower the sweeper over the brush head.
10. Reinstall adjustment lock pins and flaps.
11. Connect hydraulic lines.
12. Adjust the brush pattern according instructions in the Adjustments section.

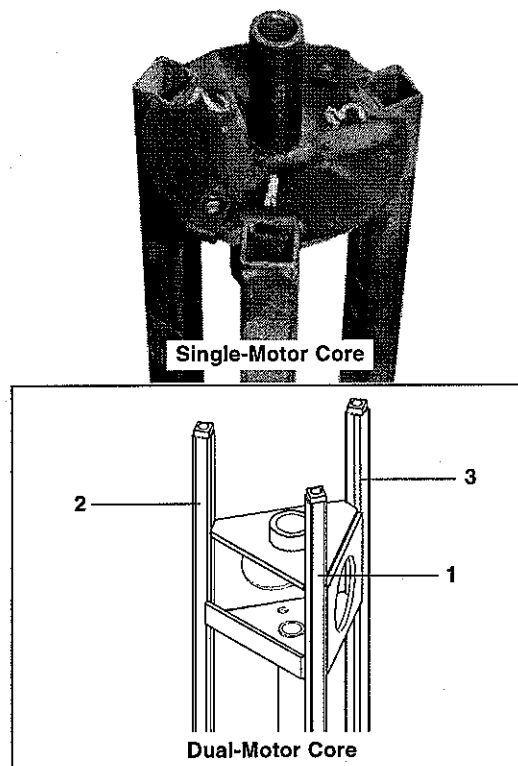

figure 14

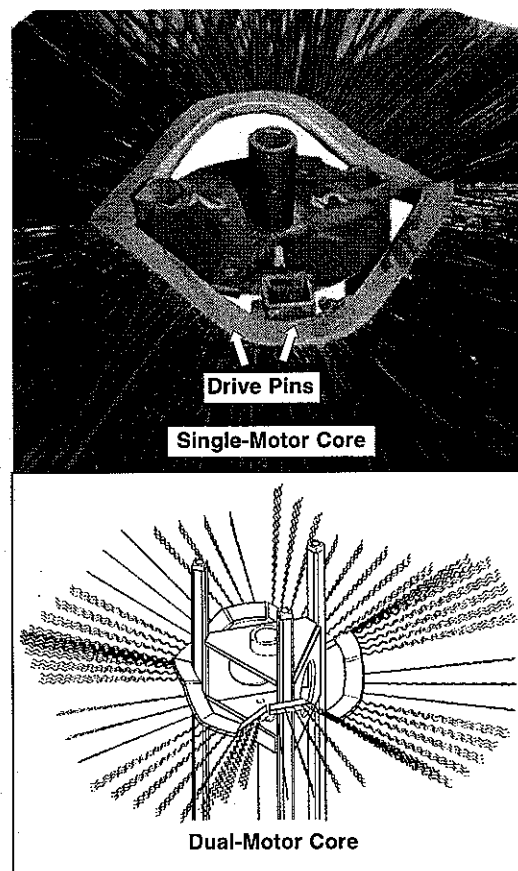

figure 15

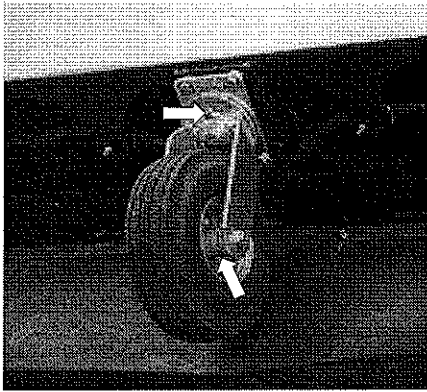

figure 16

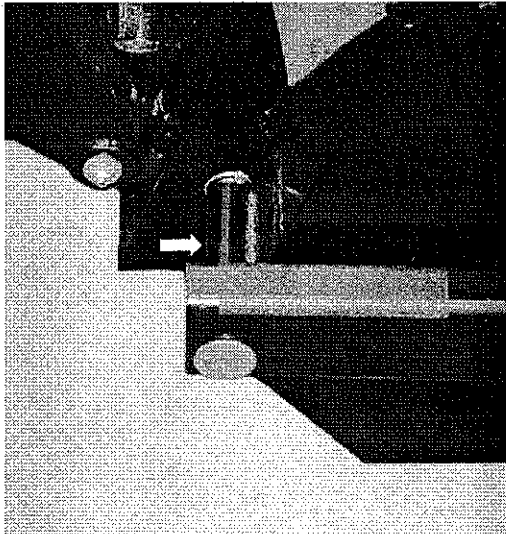

figure 17

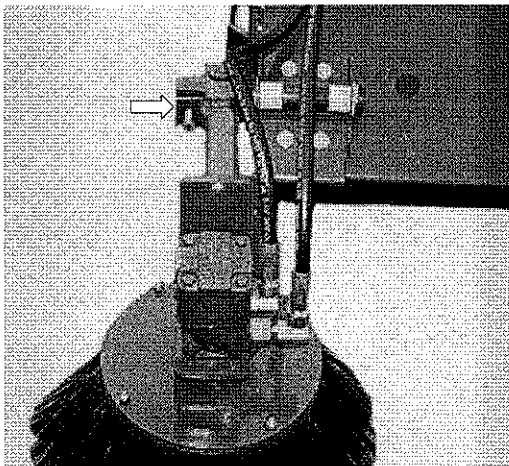

figure 18

## Lubricating the Sweeper

Lubrication is an important part of daily maintenance. Each day, lubricate the following locations.

- Front caster axle and swivel zerks (figure 16)
- Rear bracket tube zerk (figure 17)
- Gutter brush pin zerk (inside the tube) (figure 18)

---

## Maintaining Hydraulics

To prevent contamination of the sweeper hydraulic system, clean couplers before connecting hydraulics, and change oil and filters regularly according to manufacturer's instructions.

---

# Main Sweeper

Item	Part	Qty	Description
1.	01-0847	14	Section, 26, Poly, Convoluted, HB48CB
	01-0848	12	Section, 26, Wire, Convoluted, HB48CB
	01-0847	26	Section, 26, Poly, Convoluted, HB48PB
	01-0847	18	Section, 26, Poly, Convoluted, HB60CB
	01-0848	17	Section, 26, Wire, Convoluted, HB60CB
	01-0847	35	Section, 26, Poly, Convoluted, HB60PB
	01-0847	22	Section, 26, Poly, Convoluted, HB72CB
	01-0848	20	Section, 26, Wire, Convoluted, HB72CB
	01-0847	42	Section, 26, Poly, Convoluted, HB72PB
2.	03-3204	1	Motor, Hydraulic, 15.0, 1 in., Left, Tapered Shaft, Check Valve
3.	03-2936	2	Plug, Button, Flush Head, for 1.25 Hole
4.	07-3637	8	Screw, Cap, 1/4-20 x 1
5.	07-1714	4	Screw, Cap, 5/16 x 1
6.	07-3670	4	Screw, Cap, 1/2-13 x 1
7.	07-4032	10	Washer, Flat, 1/4
8.	07-1763	4	Washer, Flat, 1/2
9.	07-4038	10	Washer, Lock, Split, 1/4
10.	07-1762	4	Washer, Lock, Split, 1/2
11.	07-4039	10	Nut, Hex, 1/4-20
12.	07-0240	3	Nut, Lock, Stamped, 5/16 x 18, Timmerman
13.	07-0244	2	Pin, Link, #1600
14.	07-1607	2	Pin, Lock, 5/16, Square Bail
15.	07-1973	16	Screw, Cap, 5/16-18 x 1-1/4
16.	07-2656	2	Pad, Nonslip, 4 x 24
17.	07-2956	19	Nut, Insert, M6 x 1 (48 & 60)
	07-2956	25	Nut, Insert, M6 x 1 (72)
18.	07-3273	25	Washer, Lock, Split, 5/16
19.	07-3275	27	Washer, Flat, 5/16
20.	07-3278	22	Nut, Hex, 5/16-18
21.	07-3280	6	Bolt, Carriage, 5/16-18 x 3/4
22.	07-3522	19	Screw, Whiz Lock, M6 x 1 x 20 (48 & 60)
23.	07-3581	1	Assembly, Caster, Pneumatic, 4.10/3.50-4
	07-3516	1	Assembly, Caster, Heavy Duty Option
24.	07-3727	14	Plug, Cap, Plastic
25.	08-0005	2	Flange, Bearing, 2-Hole
26.	08-0006	1	Bearing, 1 Round, with Collar
27.	13-7754	1	Plate, Retainer, Core
28.	13-8021	2	Adjustment, Core, HBB
29.	13-8024	1	Mounting, Bearing/Flange, HBB, Single Motor
30.	13-8030	1	Mounting, Motor
31.	13-8033	4	Plate, 3/8 x 1 x 10, with Holes, HBB
32.	13-8034	4	Plate, 3/16 x 1.5 x 10, with Holes, HBB

Item	Part	Qty	Description
33.	13-8064	1	Plate, Support, Flap, Rear, HB48B
	13-8046	1	Plate, Support, Flap, Rear, HB60B
	13-8056	1	Plate, Support, Flap, Rear, HB72B
34.	13-8065	1	Flap, Rear, HB48B
	13-8047	1	Flap, Rear, HB60B
	13-8060	1	Flap, Rear, HB72B
35.	13-8066	1	Flap, Inner, HB48B
	13-8049	1	Flap, Inner, HB60B
	13-8058	1	Flap, Inner, HB72B
36.	13-8070	1	Flap, Front, HB48B
	13-8050	1	Flap, Front, HB60B
	13-8059	1	Flap, Front, HB72B
37.	13-8051	1	Plate, Support, Flap, Left, HBB
38.	13-8052	1	Plate, Support, Flap, Right, HBB
39.	13-8053	2	Flap, Side, HBB
40.	13-8068	2	Plate, Support, Flap, Front, HB48B
	13-8069	2	Plate, Support, Flap, Front, HB60B
	13-8067	2	Plate, Support, Flap, Front, HB72B
41.	13-8079	1	Sweeper, HB48BD
	13-8082	1	Sweeper, HB60BD
	13-8080	1	Sweeper, HB72BD
42.	13-8086	1	Core, 48, HBB
	13-8085	1	Core, 60, HBB
	13-8084	1	Core, 72, HBB
43.	13-8179	2	Pin, 1.00 x 7.5 with Hole
44.	07-3432	2	Screw, Cap, 1/4 x 3/4
45.	13-10060	4	Finger, Apron (Some Models)
61.	07-0210	1	Clip, Hairpin, 14 Gauge x 1 3/4
62.	07-1675	4	Rivet, Pop, 1/8 x 1/4
63.	07-2840	2	Chain, 1/4, 56 Links
64.	07-3112	2	Fitting, Zerk, 1/4-28, Self Tap (Not Shown)
65.	07-3311	4	Link, Quick, 5/16
67.	09-0066	4 ft	Hose, LP, 1 Fiber Braid
68.	51-3159	1	Manual, HBB Series, (Not Shown)

**NOTE** – Some items vary according to sweeper width. If you need parts be sure and order correct part number and quantity for sweeper width.

# Main Sweeper

Single Motor  
Models HB48B, HB60B & HB72B

CONFIGURATION OF CHAIN CONNECTING  
SWEEPER TO TRACTOR WILL VARY  
ACCORDING TO MAKE OF TRACTOR.

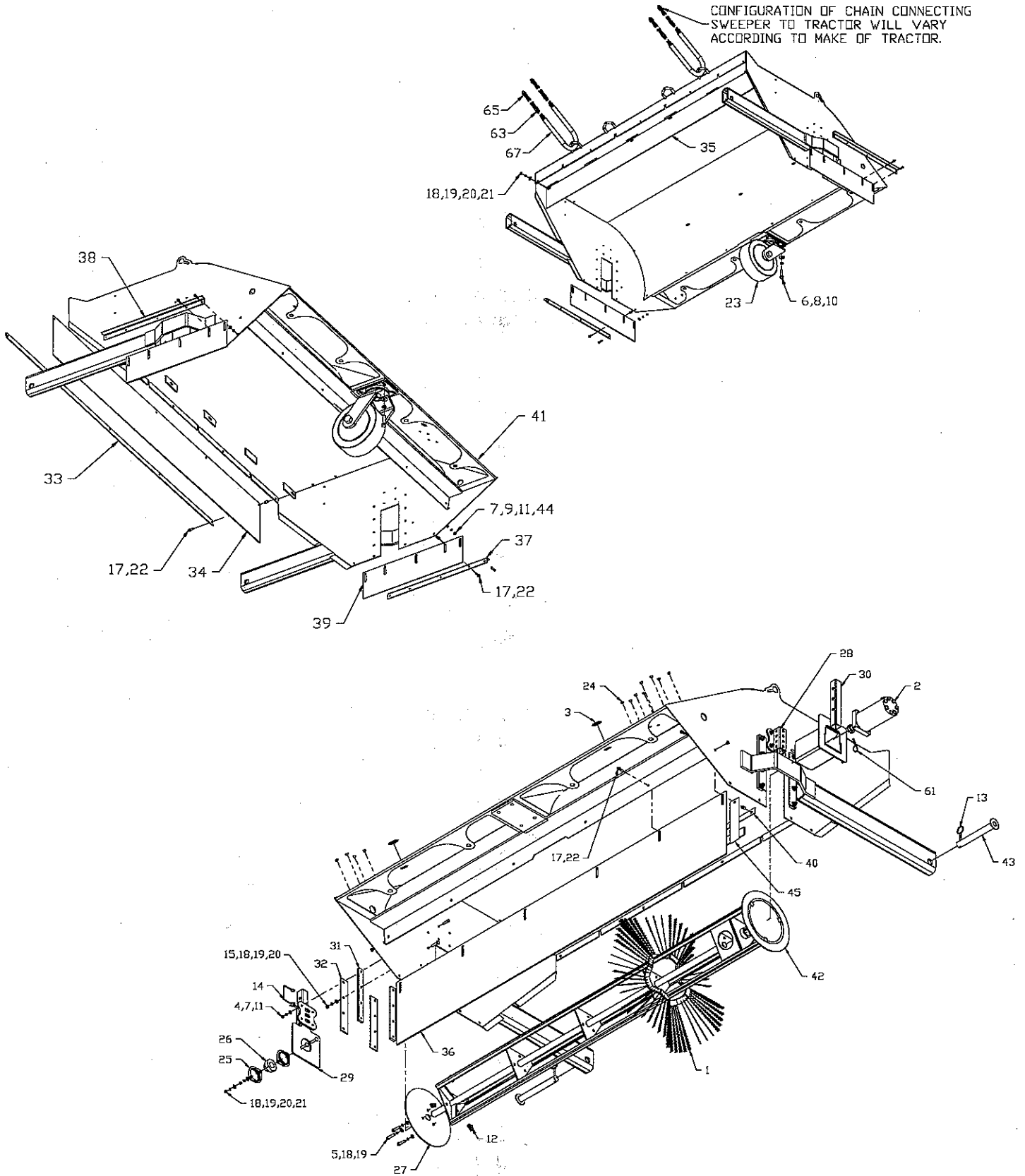

# Main Sweeper

Item	Part	Qty	Description
1.	01-0847	18	Section, 26, Poly, Convoluted, HB60CB
	01-0848	17	Section, 26, Wire, Convoluted, HB60CB
	01-0847	35	Section, 26, Poly, Convoluted, HB60PB
	01-0847	22	Section, 26, Poly, Convoluted, HB72CB
	01-0848	20	Section, 26, Wire, Convoluted, HB72CB
	01-0847	42	Section, 26, Poly, Convoluted, HB72PB
2.	03-2743	1	Motor, Hydraulic, 15.0, 1 in., Left, Tapered Shaft, Check Valve
3.	03-2936	2	Plug, Button, Flush Head, for 1.25 Hole
4.	03-3052	1	Motor, Hydraulic, 12.15, 1 in., Tapered Shaft, Check Valve
5.	07-3637	8	Screw, Cap, 1/4-20 x 1
6.	07-0018	3	Screw, Cap, 3/8 x 3/4
7.	07-3670	4	Screw, Cap, 1/2-13 x 1
8.	07-4032	10	Washer, Flat, 1/4
9.	07-3279	3	Washer, Flat, 3/8
10.	07-1763	4	Washer, Flat, 1/2
11.	07-4038	10	Washer, Lock, Split, 1/4
12.	07-1762	4	Washer, Lock, Split, 1/2
13.	07-4039	10	Nut, Hex, 1/4-20
14.	07-0244	2	Pin, Link, #1600
15.	07-1607	2	Pin, Lock, 5/16, Square Bail
16.	07-1973	16	Screw, Cap, 5/16-18 x 1-1/4
17.	07-2656	2	Pad, Non-slip, 4 x 24
18.	07-2956	19	Nut, Insert, M6 x 1
19.	07-3273	20	Washer, Lock, Split, 5/16
20.	07-3275	24	Washer, Flat, 5/16
21.	07-3278	20	Nut, Hex, 5/16-18
22.	07-3522	19	Screw, Whiz Lock, M6 x 1 x 20
23.	07-3581	1	Assembly, Caster, Pneumatic, 4.10/3.50-4
24.	07-3727	14	Plug, Cap, Plastic
25.	13-8021	2	Adjustment, Core, HBB
26.	13-8030	2	Mounting, Motor
27.	13-8033	4	Plate, 3/8 x 1 x 10, with Holes, HBB
28.	13-8034	4	Plate, 3/16 x 1.5 x 10, with Holes, HBB
29.	13-8046	1	Plate, Support, Flap, Rear, HB60B
	13-8056	1	Plate, Support, Flap, Rear, HB72B

Item	Part	Qty	Description
30.	13-8047	1	Flap, Rear, HB60B
	13-8060	1	Flap, Rear, HB72B
31.	13-8049	1	Flap, Inner, HB60B
	13-8058	1	Flap, Inner, HB72B
32.	13-8050	1	Flap, Front, HB60B
	13-8059	1	Flap, Front, HB72B
33.	13-8051	1	Plate, Support, Flap, Left, HBB
34.	13-8052	1	Plate, Support, Flap, Right, HBB
35.	13-8053	2	Flap, Side, HBB
36.	13-8069	2	Plate, Support, Flap, Front, HB60B
	13-8067	2	Plate, Support, Flap, Front, HB72B
37.	13-8082	1	Sweeper, HB60BD
	13-8080	1	Sweeper, HB72BD
38.	13-8087	1	Core, 48, HBB
	13-8088	1	Core, 60, HBB
	13-8089	1	Core, 72, HBB
39.	13-8102	1	Plate, End, Core, HBB
40.	13-8179	2	Pin, 1.00 x 7.5, with Hole
41.	07-3432	2	Screw, Cap, 1/4 x 3/4
42.	13-10060	4	Finger, Apron
43.	07-3280	4	Carriage, Bolt, 5/16-18 x 3/4
44.	07-1718	3	Washer, Lock, 3/8
45.	07-0210	2	Clip, Hairpin, 14 Gauge x 1 3/4
64.	07-1675	4	Rivet, Pop, 1/8 x 1/4 (Not Shown)
65.	07-2840	2	Chain, 1/4, 56 Links
66.	07-3112	2	Fitting, Zerk, 1/4-28, SelfTap (Not Shown)
67.	07-3311	4	Link, Quick, 5/16
69.	09-0066	4 ft	Hose, LP, 1 Fiber Braid
73.	51-3159	1	Manual, HBB Series (Not Shown)

**NOTE** – Some items vary according to sweeper width. If you need parts be sure and order correct part number and quantity for sweeper width.

# Main Sweeper

Dual Motor  
Models HB60BD & HB72BD

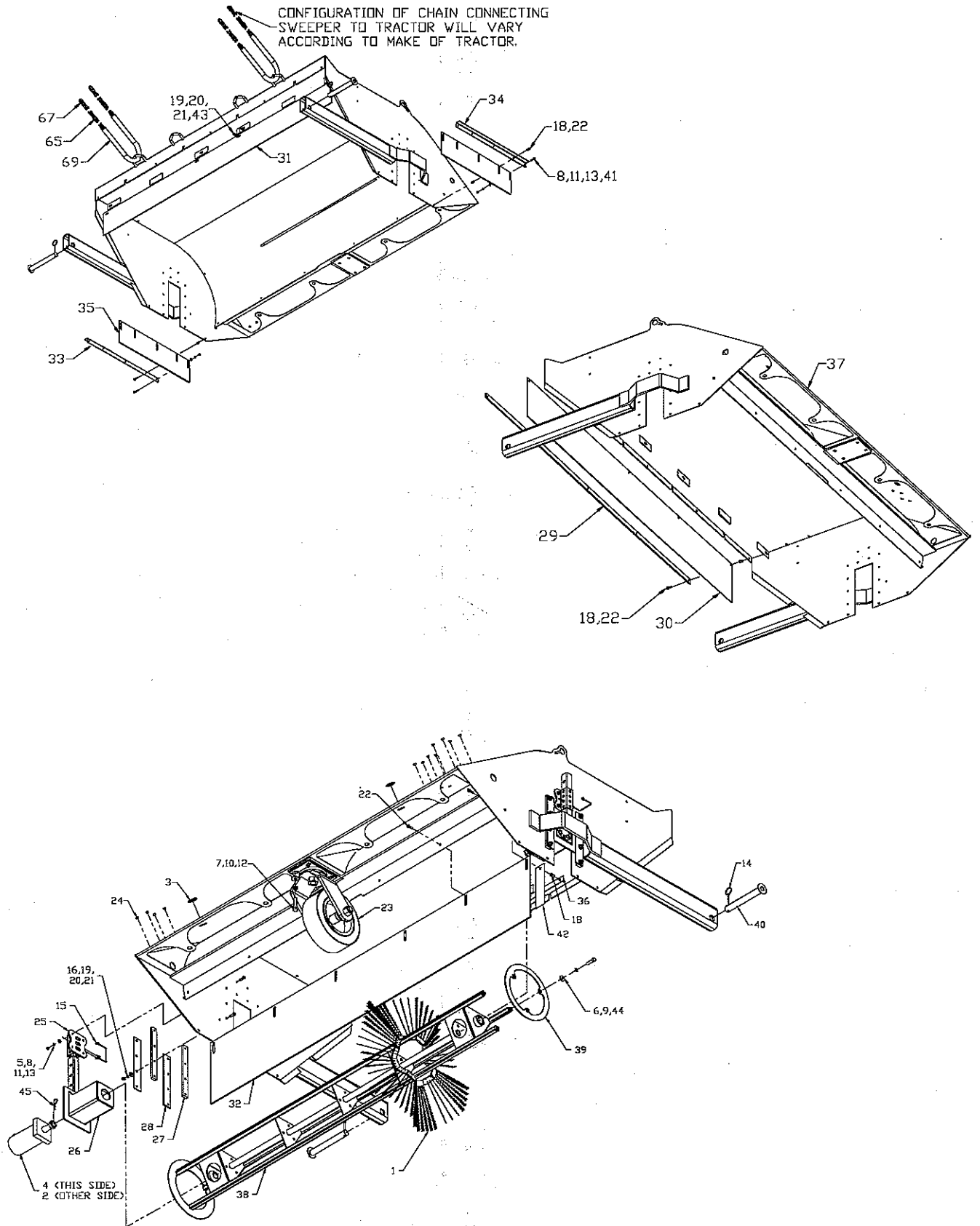

# Main Sweeper

## Hydraulic Hookup for Single Motor

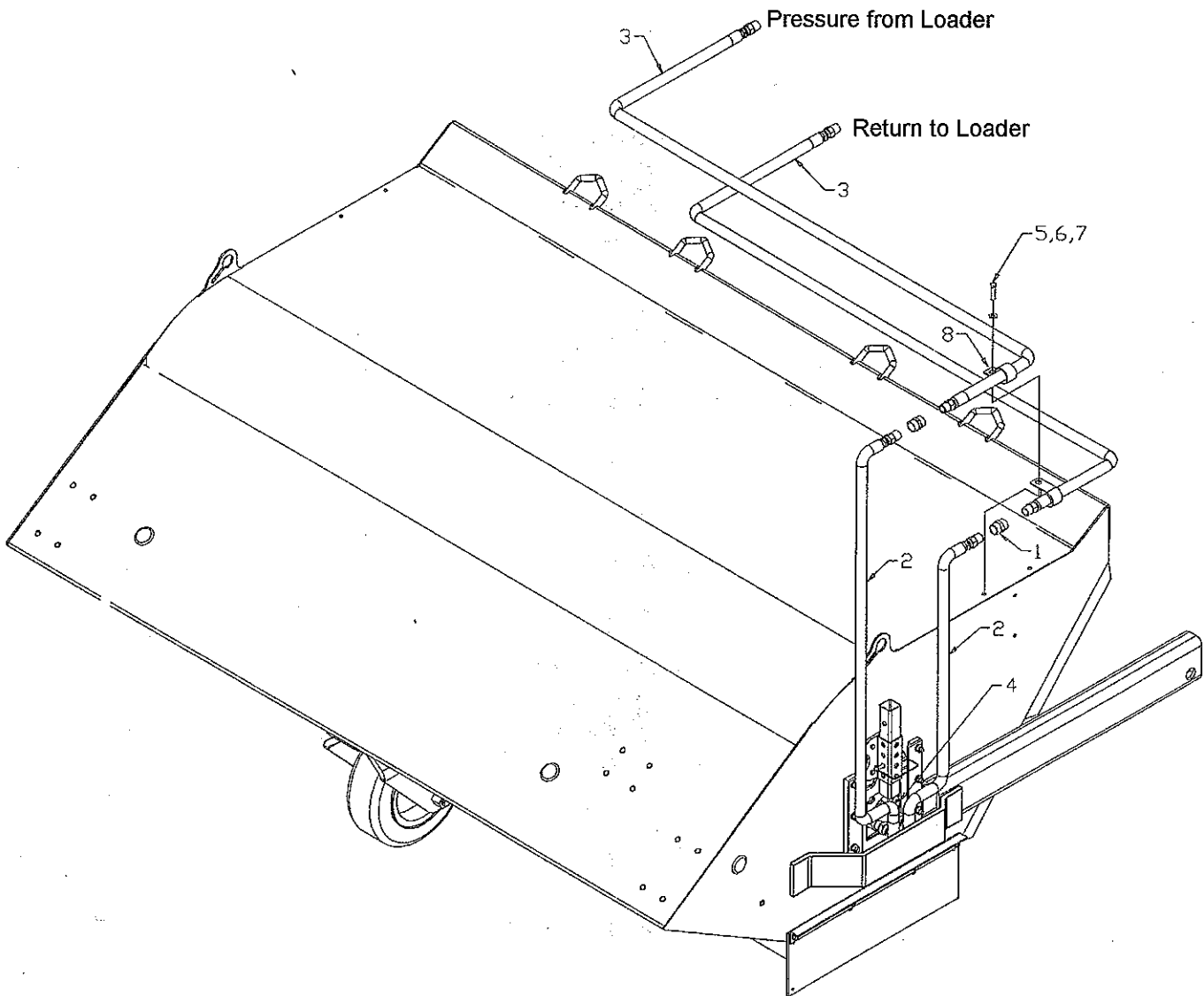

Item	Part	Qty	Description
1.	03-1919	2	Fitting, Union, 1/2 MFS, 1/2 MFS
2.	03-3811	2	Hose, 1/2 x 32, 451 AR, 1/2 FFS, 3/4 MORS, 90°
3.	03-3812	2	Hose, 1/2 x 72, 451 AR, 1/2 FFS, 1/2 FFS
4.	03-3204	1	Motor, Hydraulic, 15.0, 1 in., Left, Tapered Shaft, Check Valve
5.	07-1714	1	Screw, Cap, 5/16-18 x 1
6.	07-3275	2	Washer, Flat, 5/16
7.	07-3270	1	Nut, Hex, 5/16-18, Nylock
8.	07-1721	2	Clamp, Rubber Coat, 1-1/4 Hose

**NOTE** – For hookup with optional gutter brushes, see pages 37 and 38.



# Main Sweeper

## Hydraulic Hookup for Dual Motor

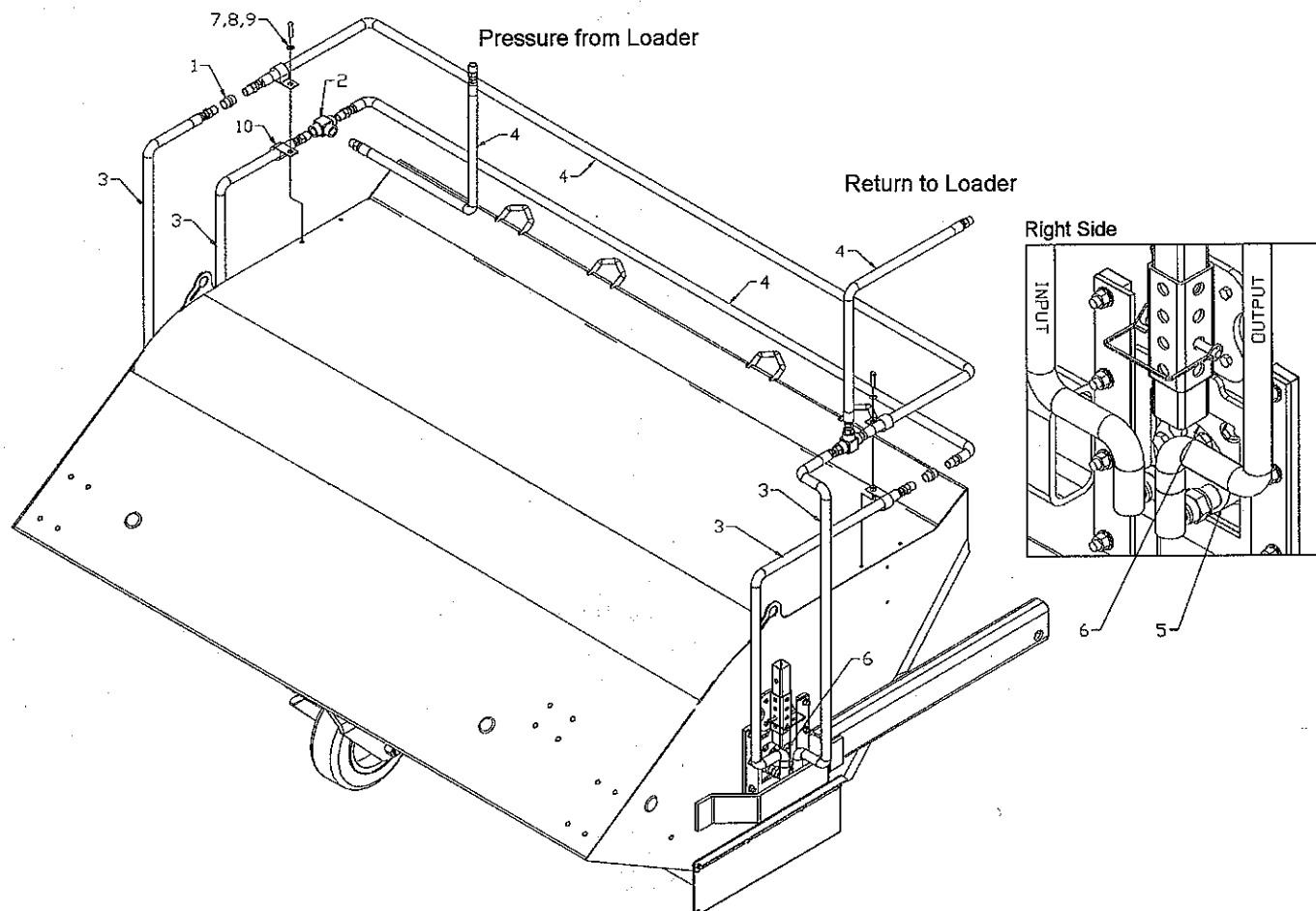

Item	Part	Qty	Description
1.	03-1919	2	Fitting, Union, 1/2 MFS, 1/2 MFS
2.	03-3484	2	Fitting, #8, Male, ORFS, Union, T
3.	03-3811	4	Hose, 1/2 x 32, 451 AR, 1/2 FFS, 3/4 MORS, 90°
4.	03-3812	4	Hose, 1/2 x 72, 451 AR, 1/2 FFS, 1/2 FFS
5.	03-2743	1	Motor, Hydraulic, 12.15, 1 in., Left, Tapered Shaft, Check Valve
6.	03-3052	1	Motor, Hydraulic, 12.15, 1 in., Right
7.	07-1714	2	Screw, Cap, 5/16-18 x 1
8.	07-3275	4	Washer, Flat, 5/16
9.	07-3270	2	Nut, Hex, 5/16-18, Nylock
10.	07-1721	4	Clamp, Rubber Coat, 1-1/4 Hose

**NOTE** – For hookup with optional gutter brushes, see pages 39 and 40.

# Hydraulic Motor

**IMPORTANT – Do not disassemble hydraulic motor(s).**

Disassembly may void warranty. If under warranty call SWEEPSTER Technical Service to arrange for replacement. If warranty has expired then contact SWEEPSTER for service parts and assembly drawing.

**Hydraulic Motor 03-3204**  
Typical of  
03-3052 and 03-2743

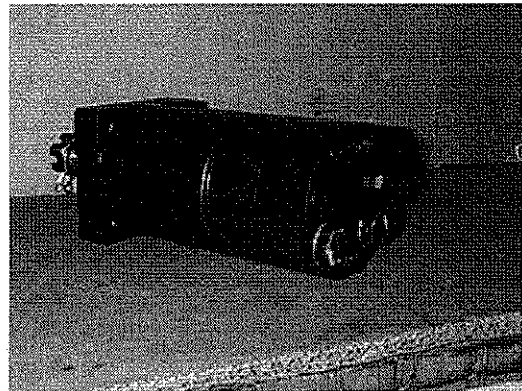

Seal kits available for hydraulic motors.  
Seal kit for motor number 03-3204 is part number 03-1409. Seal kit for motors 03-2743 and 03-3052 is part number 03-2941.

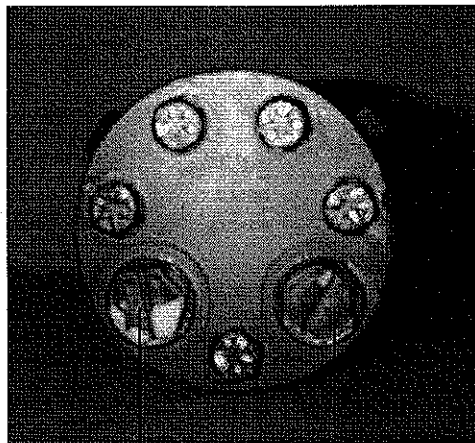

Input From  
Prime Mover

Output To  
Prime Mover

# Buckets

For Specific Prime Movers

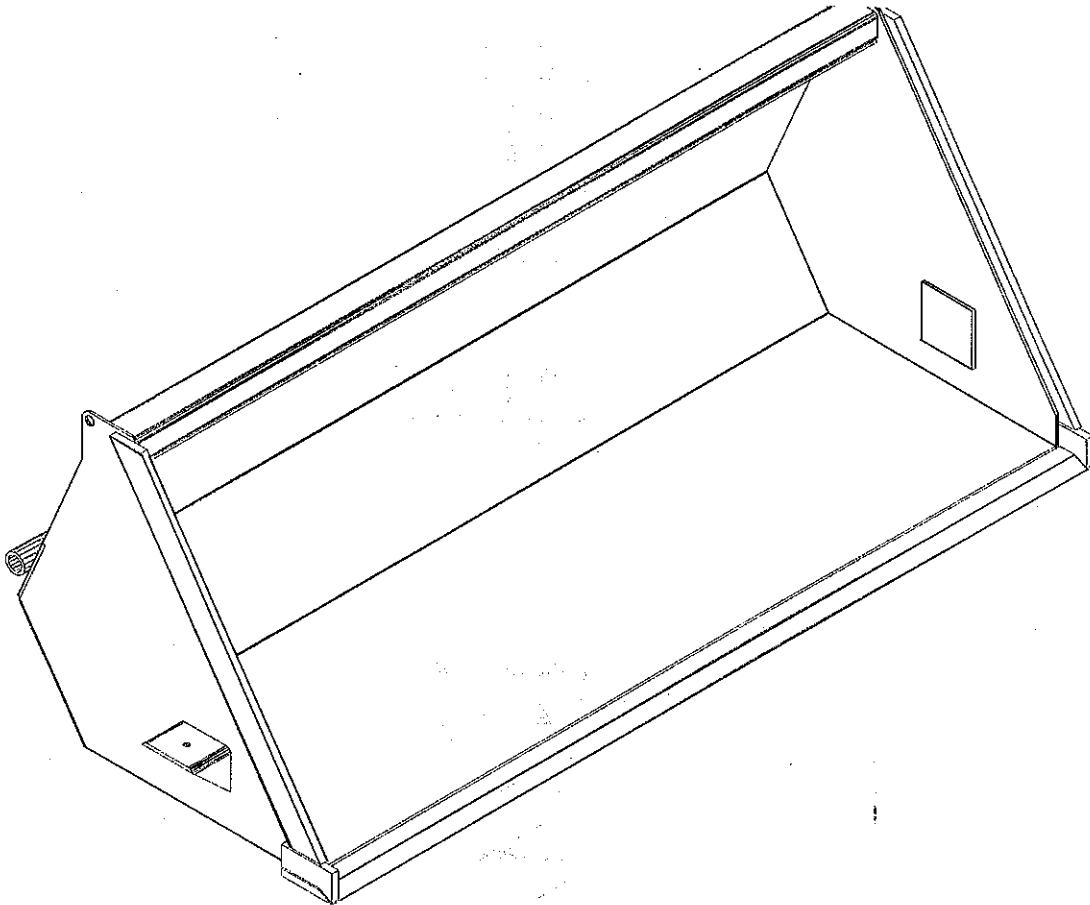

**Part Qty Description**

07-1930	1	Bucket, 60, Adj Fit
07-1994	1	Bucket, 60, Mustang 940/442, 960/552, 342
07-1999	1	Bucket, 60, FNH555/780, JD 675/875
07-2001	1	Bucket, 60, KOE 1300 HD, BOB 7-800, 2000
07-2004	1	Bucket, 60, Gehl, Dual Bolt-On, 4610/6620, QA
07-2253	1	Bucket, 60, Mustang, 545/552/450/960
07-2560	1	Bucket, 60, Trak, 1300, QA
07-4102	1	Bucket, 60, Gehl, Weld On, HK 4625 to 6625
07-4651	1	Bucket, 60, Mustang, Black

**Part Qty Description**

07-2483	1	Bucket, 72, Gehl, Dual, Bolt-On
07-2511	1	Bucket, 72, Ford, NH, 785
07-2635	1	Bucket, 72, Melroe, 743/873A, W/ Melroe QA
07-2635	1	Bucket, 72, Case, 1845C
07-2671	1	Bucket, 72, Adj Fit
07-3054	1	Bucket, 72, Trak, 1300 HD
07-3054	1	Bucket, 72, Trak, 1700
07-3215	1	Bucket, 72, JCB210S, New Style
07-3319	1	Bucket, 72, Hydra Mac 2650
07-3353	1	Bucket, 72, Case, 1845C, Dual, Bolt-On, Cut Edge
07-4103	1	Bucket, 72, Gehl, Weld On, HK 4625 to 6625
07-4424	1	Bucket, 72, Mustang, IP
07-4647	1	Bucket, Volvo, L 30/35, Zettlemeyer, 602

**NOTE** – This is only a partial list of available buckets. Please call SWEEPSTER sales department for buckets not listed.

# Buckets

Kits 11-4419 (HB60B & HB60BD) & 11-4421 (HB72B & HB72BD)

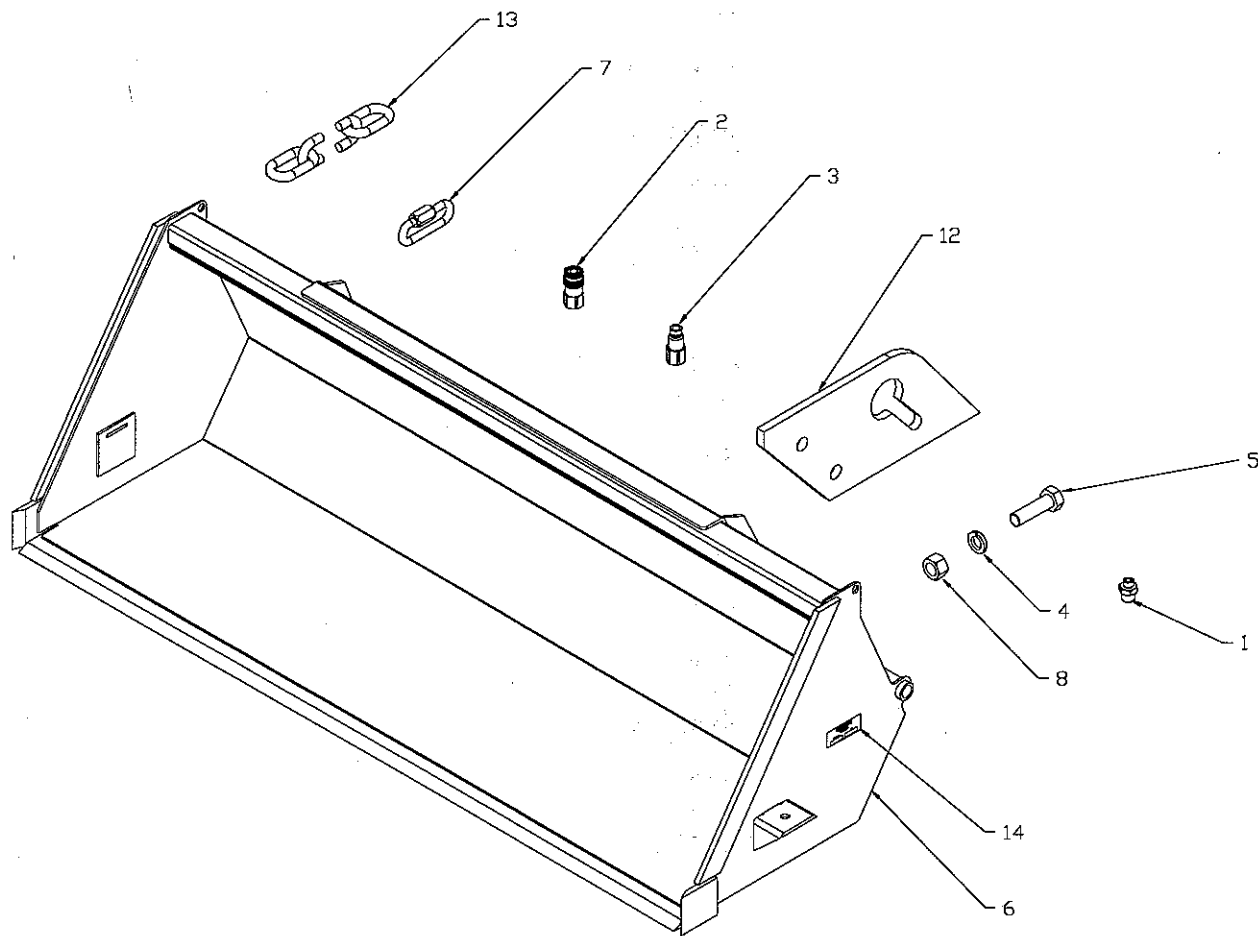

Item	Part	Qty	Description
1.	03-3515	2	Fitting, Cat 13/16-16 ORFS, Tend 1 1/16-12
2.	03-3859	1	Fitting, Quick Coupler, F1-1/16, FOR
3.	03-3860	1	Fitting, Quick Coupler, M1-1/16, FOR
4.	07-1718	4	Washer, Lock, Split, 3/8
5.	07-2116	4	Screw, Cap, 3/8-16 x 1 1/4
6.	07-2001	1	Bucket,60 (for kit 11-4419)
	07-2635	1	Bucket,72 (for kit 11-4421)
7.	07-3311	2	Link, Quick, 5/16
8.	07-3654	4	Nut, Hex, 3/8-16
12.	13-7370	2	Plate, Chain, Mounting
13.	13-7371	2	Chain, 1/4, 24 Links
14.	50-0249	1	Label, Plate, Part Number, Date

# Universal Mounting

Assemblies 11-17306 (HB60B & HB60BD)  
& 11-17358 (HB72B & HB72BD)

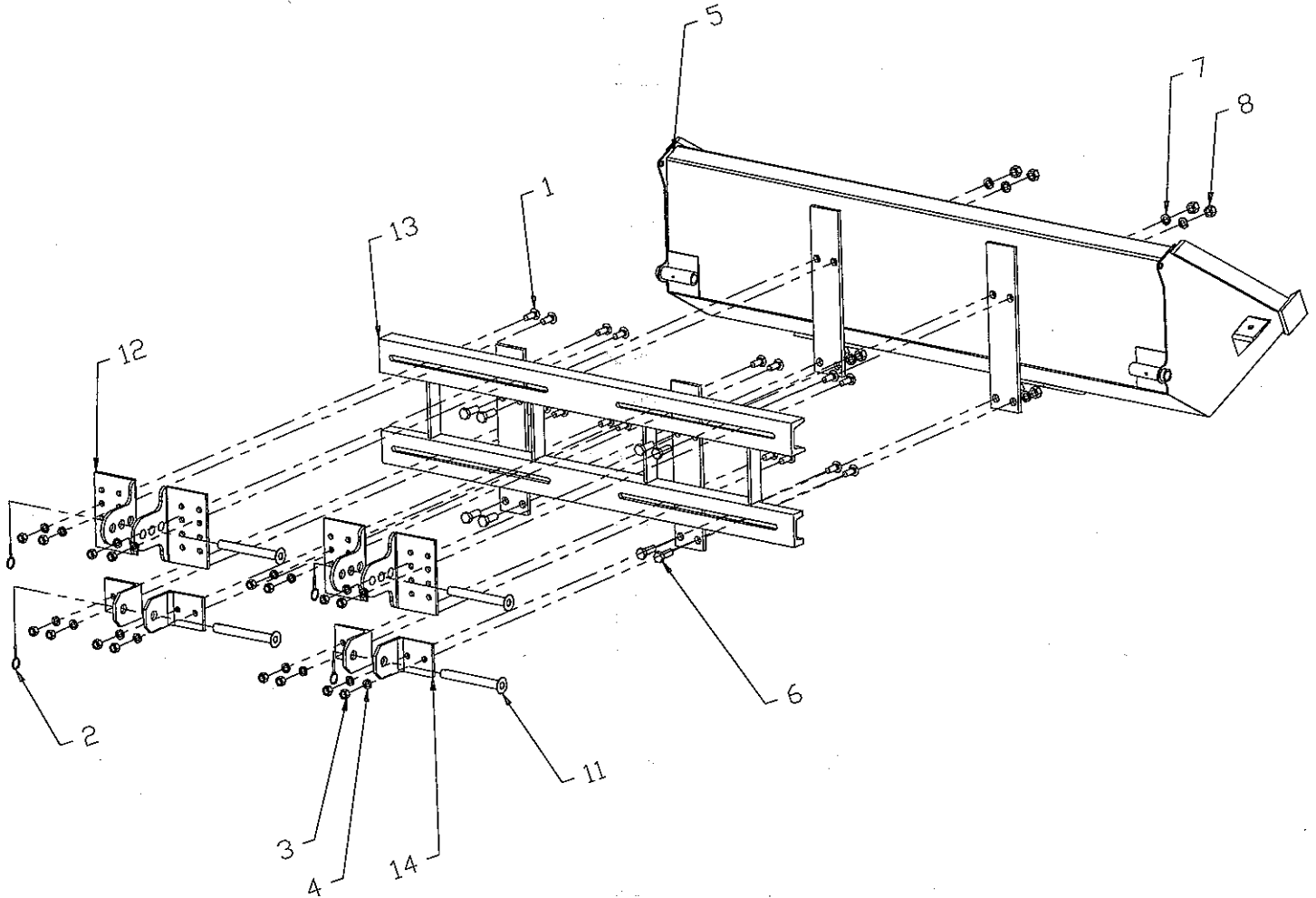

Item	Part	Qty	Description
1.	07-0119	16	Bolt, Carriage, 5/8 x 1 3/4
2.	07-0244	4	Pin, Link
3.	07-1294	16	Nut, Hex, 5/8-11
4.	07-1872	16	Washer, Lock, Split, 5/8
5.	07-1930	1	Weld, Bucket, Adj. Fit, HB60
	07-2671	1	Weld, Bucket, Adj. Fit, HB72
6.	07-3064	8	Screw, Cap, 3/4 x 2
7.	07-3065	8	Washer, Lock, Split, 3/4
8.	07-3066	8	Nut, Hex, 3/4
11.	13-1537	4	Weld, Pin, 8 1/2 W/Hole
12.	13-1872	4	Plate, Mounting, Top, HB, Universal
13.	13-1873	1	Frame, Mounting, HB, Universal
14.	13-1874	4	Plate, Mounting, HB, Universal

# Hook Points

For Sweeper Mounted on Thomas Skid Steer Loader

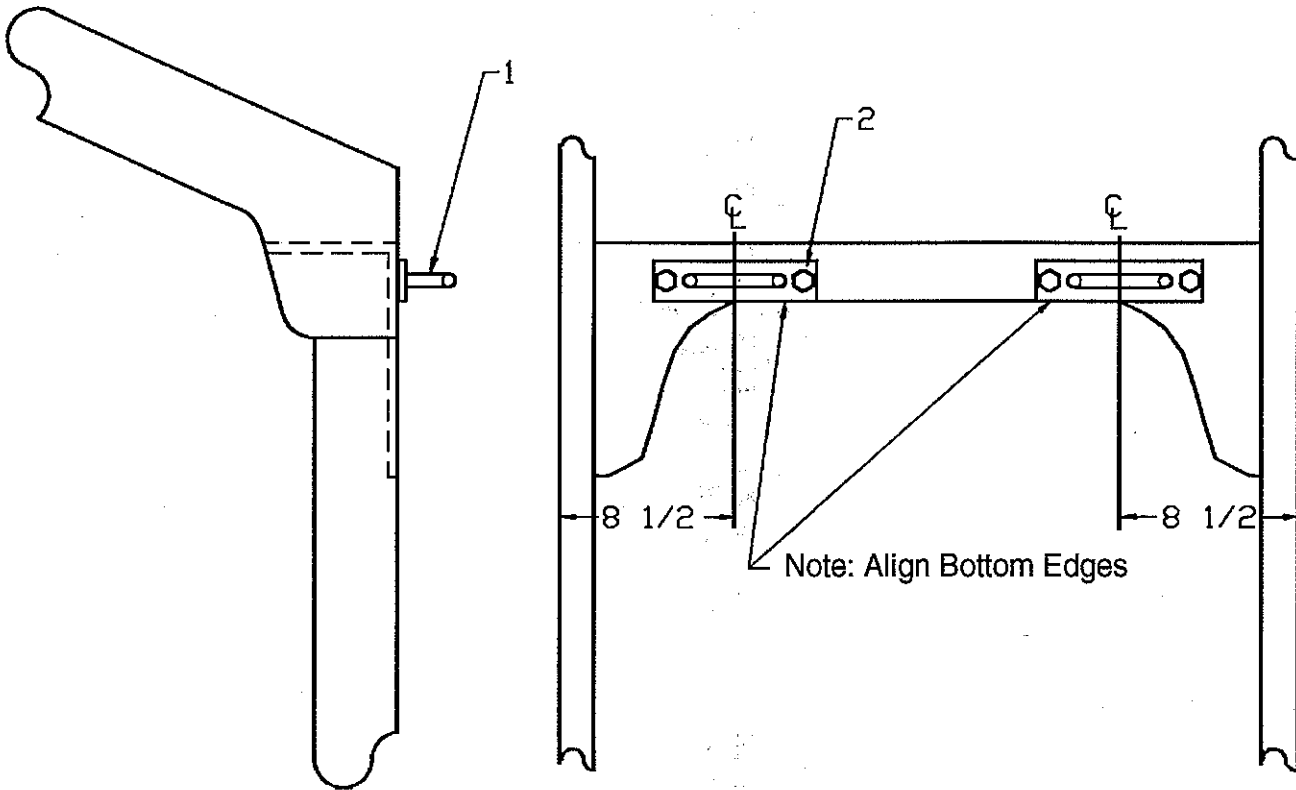

Item	Part	Qty	Description
1.	13-4278	2	Hook
2.	07-0039	4	Screw, Cap, 1/2

## Option – Dual Motor Kit

### Installation

**NOTE** – This option is available only for HB60B and HB72B units.

To change a single-motor unit to a dual-motor unit:

1. Disconnect hydraulic hoses from the motor and the prime mover (if connected).

**IMPORTANT** – Avoid contamination and hydraulic system damage. Cap the motor and hoses after disconnecting them.

2. Remove adjustment lock pins from both sides of the sweeper.
3. Lift the sweeper body off the brush head. Set the body aside.
4. Loosen the nut on the motor and remove the motor from the core.
5. Remove the end ring and sections from the core.
6. Place the motor just removed and the new motor in the motor housings in the new core. Secure by tightening the nut on each motor.

**NOTE** – Be sure to place old motor on the same end as before.

7. Install new sections by doing the following:
  - a. Number the tubes on the core as 1, 2 and 3 (figure 19).
  - b. Slide the first section onto the core with the drive pins on either side of tube 1 (figure 20). Make sure that the drive pins angle up.
  - c. Place the second section on the core with the drive pins on either side of tube 2. Be sure the drive pins angle down.
  - d. Put the third section on with the drive pins around tube 3. Be sure the drive pins angle up.
  - e. Slide sections on until the core is full, making sure to alternate the tubes used and the direction of the drive pins.
8. Place the sweeper on the core. Secure the core with adjustment lock pins.

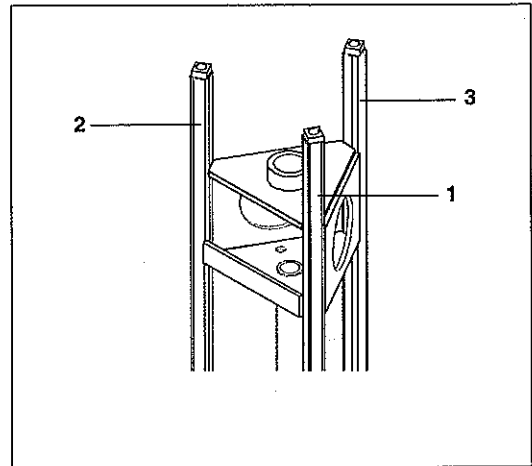

figure 19

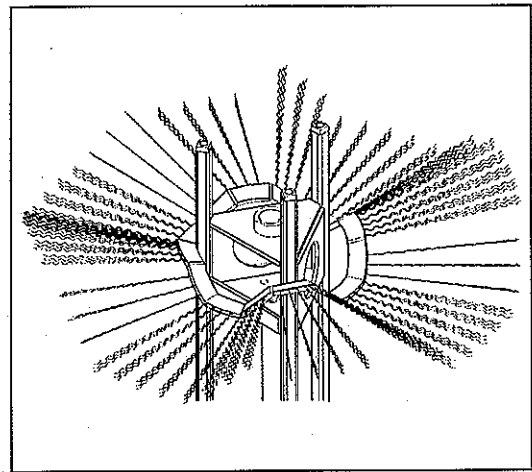

figure 20

9. Install hydraulic hoses.
  - a. Disassemble hoses used in the single-motor hydraulic system. Leave quick couplers on 72 in. (1.8 m) hoses.
  - b. Install 25 in. (635 mm) hoses on both motors.
  - c. Connect couplers, T-fittings and new 25 in. (635 mm) hoses so T-fittings match up with the prime mover remotes.
  - d. Install 72 in. (1.8 m) hoses (removed from the single-motor hydraulic system) on the T-fittings.
  - e. Connect quick couplers to the prime mover remotes.

## Option – Dual Motor Kit

To order, ask for kit 13-11032 (HB60B) or 13-11033 (HB72B).

### Option 13-11032

*Includes:*

13-8088 60" Core

13-10988 Kit, Hardware

### Option 13-11033

*Includes:*

13-8089 72" Core

13-10988 Kit, Hardware

Part	Qty	Description
13-10988	1	Kit, Hardware, HBB, Dual Motor
<i>Includes:</i>		
03-3484	2	Fitting, #8, Male, ORFS, Union T
03-3811	2	Hose, 1/2 x 32, 451 AR, 1/2 FFS, 3/4 MORS, 90°
03-3812	2	Hose, 1/2 x 72, 451 AR, 1/2 FFS, 1/2 FFS
07-0023	3	Screw, Cap, 3/8 x 3/4
07-0154	3	Washer, Flat, 3/8
13-8030	1	Mounting, Motor, HBB
13-8102	1	Plate, End, Core, HBBD



## Option – Gutter Brush

### Installing Gutter Brushes

The following describes installing a single gutter brush. Repeat on the opposite side for a second gutter brush.

1. On 1 side, remove 4 plugs (figure 21) from holes in the sweeper hood.
2. Attach a sleeve plate (figure 21) to the sweeper hood where plugs were just removed. Use 4 screws, washers, lock washers and nuts.
3. Insert a nylon bushing into each side of the sleeve.
4. Slide the gutter brush pin (figure 22) into the sleeve. Place the round plate on the gutter brush pin and secure with a roll pin.
5. Place the gutter brush arm (figure 22) on the gutter brush pin and secure with the welded pin (figure 22) and cotter pin.
6. Attach the motor mounting plate (figure 22) to the gutter brush arm.
7. Place motor on motor mounting plate (figure 22) and secure with screws indicated in parts list.
8. Attach brush plate to brush with hardware indicated in parts list.
9. Attach the brush assembly to the motor (figure 22) using the set screw and screw provided.
10. Place the chain in the keyhole slot (figure 23) on top of the hood. The chain end goes to the outside. If desired, place the chain end inside the adjustment tube to reduce rattling.
11. Attach hydraulic hoses. (Refer to hydraulic diagrams on pages 37-40 for setup.)

**IMPORTANT** – Avoid hydraulic system damage. Make sure hose ends and gutter brush motor ports are clean before installation.

**IMPORTANT** – Avoid hose damage. Make sure that hoses do not get pinched or twisted. Do not allow hoses to drag on the ground.

12. Adjust according to Adjusting Gutter Brush Contact Area and Adjusting Gutter Brush Swing on page 34.

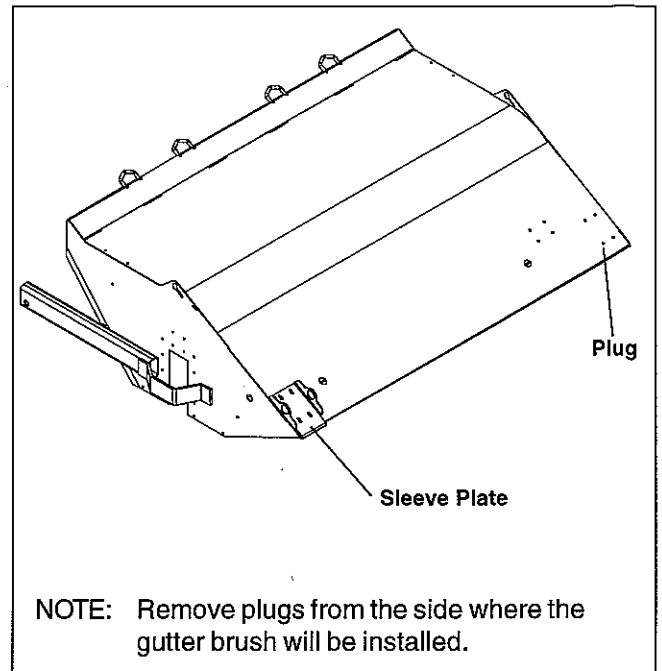

figure 21

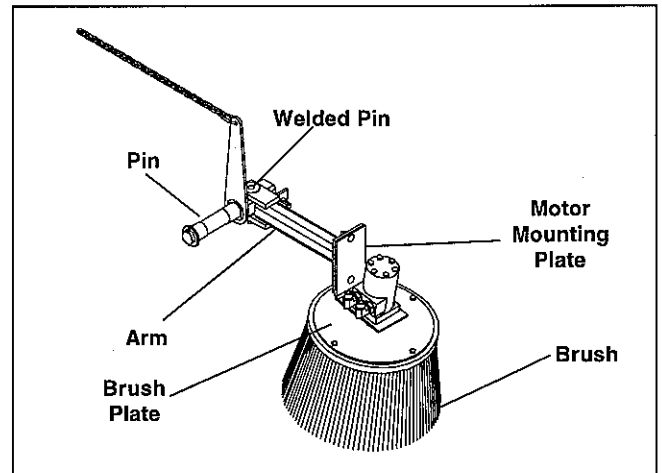

figure 22

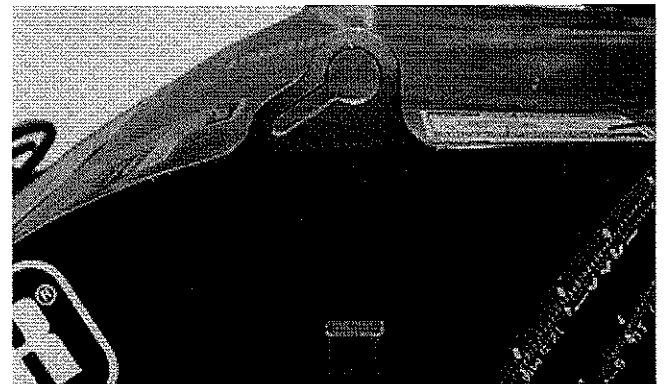

figure 23

## Option – Gutter Brush

### Adjusting Gutter Brush Contact Area

On a properly adjusted gutter brush, only a portion of the brush contacts the sweeping surface. figure 24 shows proper contact areas for both left and right gutter brushes.

To adjust the gutter brush contact area:

1. Lower the gutter brush onto the surface to be swept.
2. Loosen the bolts holding the gutter brush motor mounting plate to the gutter brush arm.
3. Turn the motor mounting plate right or left and adjust the tension chain to create the correct contact area.
4. Tighten the bolts.

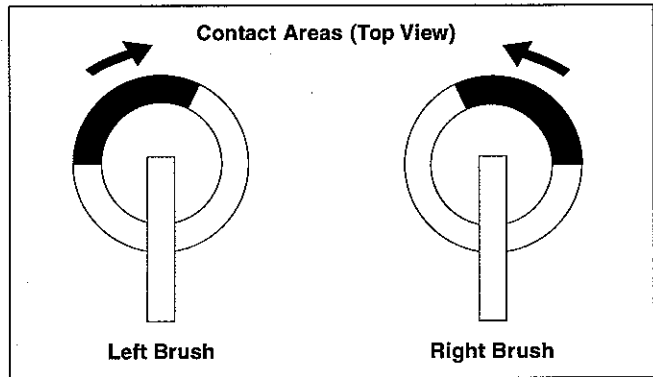

figure 24

### Adjusting Gutter Brush Swing

The gutter brush should swing out only 1/2 in. (13 mm). To adjust the amount of swing:

1. Loosen the nut (figure 25).
2. Adjust the bolt in for more swing or out for less (figure 25).
3. Tighten the nut.

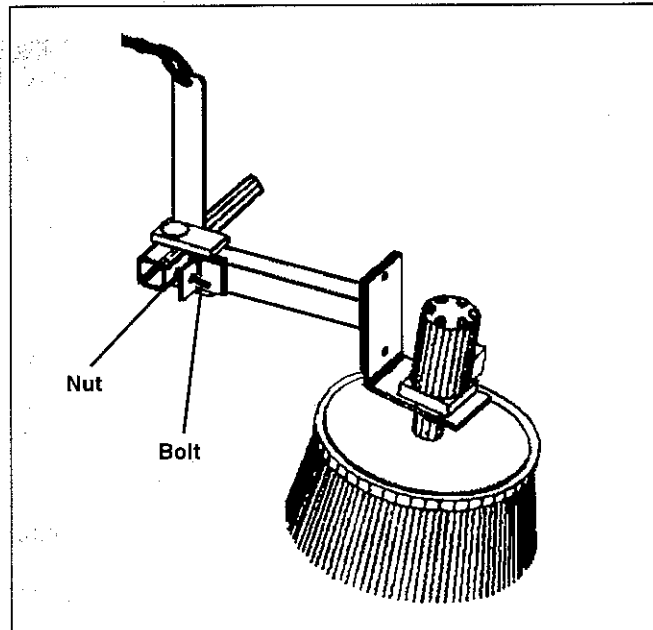

figure 25

## Option – Gutter Brush

### Using Gutter Brushes

Gutter brushes are only for sweeping forward.

When sweeping next to a curb or wall, sweep so only the bristle tips touch the vertical surface.

When not using a gutter brush for a short time, raise it with the tension chain. During extended periods of nonuse, unhook the hydraulic hoses from the gutter brush motor, remove the gutter brush assembly and connect the hydraulics to run only the main brush.

**IMPORTANT** – Contaminates can damage the hydraulic system. Cap gutter brush hoses and couplers during extended periods of nonuse.

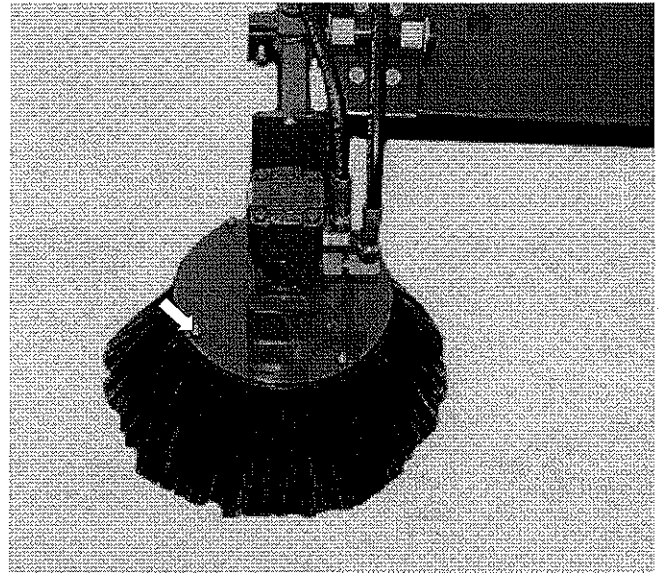

figure 26

### Replacing Gutter Brush

1. Remove 4 screws from the gutter brush plate (figure 26) to detach the worn gutter brush.
2. Attach a new gutter brush to the plate with the 4 screws just removed.
3. Adjust according to Adjusting Gutter Brush Contact Area and Adjusting Gutter Brush Swing.

# Option – Gutter Brush

To order, ask for HBBGB (Wire) or HBBGBP (Poly).

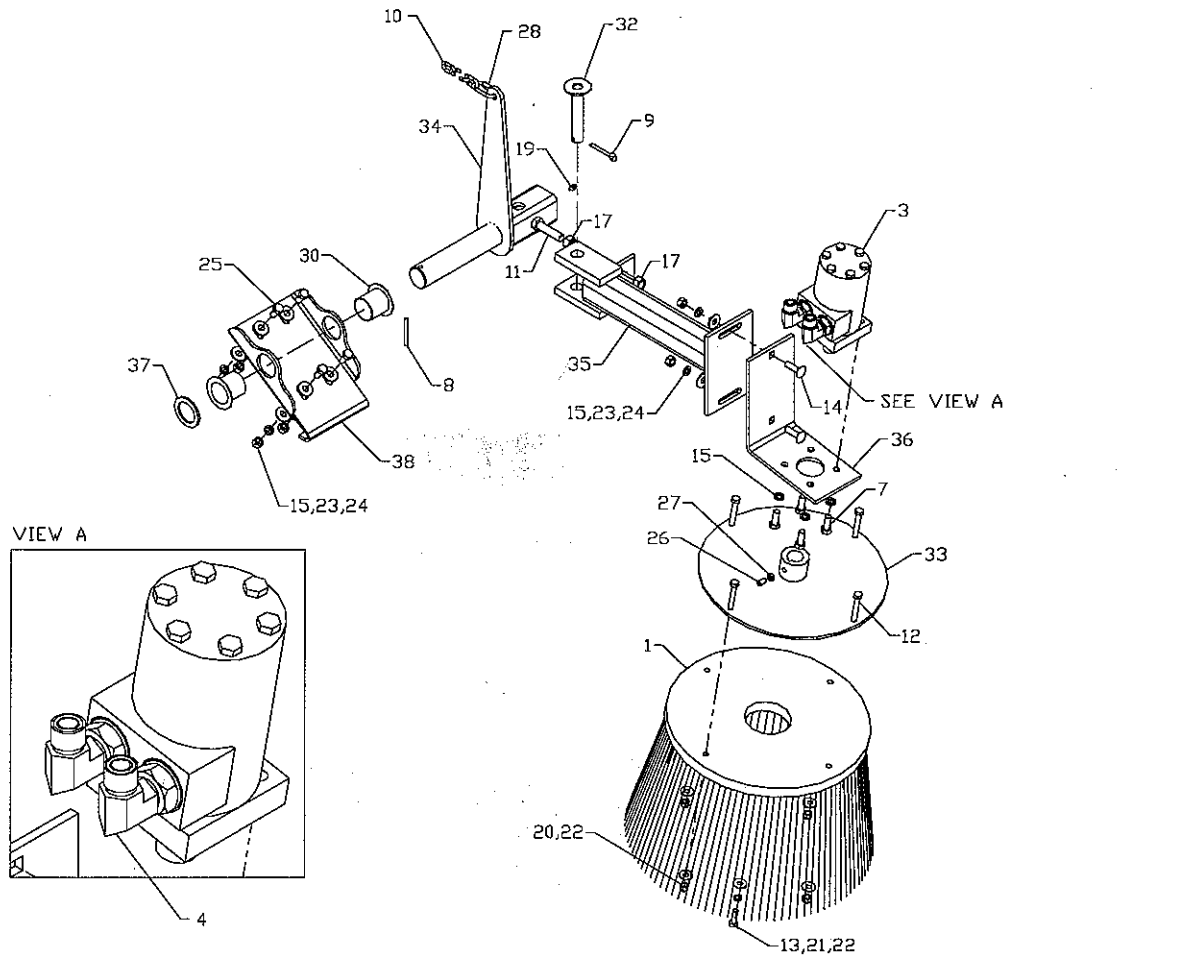

Item	Part	Qty	Description
1.	01-0523	1	Gutterbroom, 13, Woodback, Wire
	01-0704	1	Gutterbroom, 13, Woodback, Poly
2.	03-1919	2	Fitting, Union, 1/2 MFS, 1/2 MFS
3.	03-3153	1	Motor, White, RC12-12.5, Cu. In
4.	03-3489	2	Fitting, Adapter, 90°, M 10SAE/M 8ORFS
5.	03-3813	1	Hose, 1/2 x 120, 451 AR, 1/2FFS, 1/2 FFS
6.	03-3814	2	Hose, 1/2 x 56, 451 AR, 1/2 FFS, 1/2 FFS
7.	07-0018	4	Screw, Cap, 3/8-16 x 1
8.	07-0204	1	Pin, Roll, 1/4 x 2
9.	07-0206	1	Pin, Cotter, 3/16 x 2
10.	07-0387	1	Chain, 3/16, 26 Links
11.	07-1125	1	Screw, Cap, Tap, 1/2-13 x 2
12.	07-1698	4	Screw, Cap, 5/16-18 x 2
13.	07-1714	4	Screw, Cap, 5/16-18 x 1
14.	07-1717	2	Bolt, Carriage, 3/8-16 x 1 1/4
15.	07-1718	14	Washer, Lock, Split, 3/8
16.	07-1721	3	Clamp, Rubber Coat, 1 1/4 Hose
17.	07-1764	2	Nut, Hex, 1/2-13

Item	Part	Qty	Description
19.	07-3112	1	Fitting, Zerk, 1/4-28 Self Tap
20.	07-3270	7	Nut, Hex, 5/16-18, Nylock
21.	07-3273	1	Washer, Lock, Split, 5/16
22.	07-3275	11	Washer, Flat, 5/16
23.	07-3279	10	Washer, Flat, 3/8
24.	07-3654	6	Nut, Hex, 3/8-16
25.	07-4052	4	Screw, Cap, 3/8 x 3/4
26.	07-4724	1	Screw, Set, 5/16-18 x 5/8, Cup Point
27.	07-4725	1	Nut, Hex, Jam, 5/16-18
28.	07-5054	1	Link, Quick, 3/16
30.	09-0156	2	Flange, Bearing, Nylon
32.	11-3163	1	Weld, Pin, 3/4 W/Hole
33.	13-0374	1	Weld, Plate, Gutter Broom
34.	13-10254	1	Weld, Pin, Mounting, Gutterbroom
35.	13-2264	1	Weld, Arm, Gutterbroom
36.	13-2265	1	Plate, Mounting, Gutterbroom
37.	13-7004	1	Plate, Round, 10 Gauge x 2.125 x 1.505
38.	13-8130	1	Plate, Mounting, Gutterbroom

## Option – Gutter Brush

### Hydraulic Hookup for Single Motor Unit with Single Gutter Brush

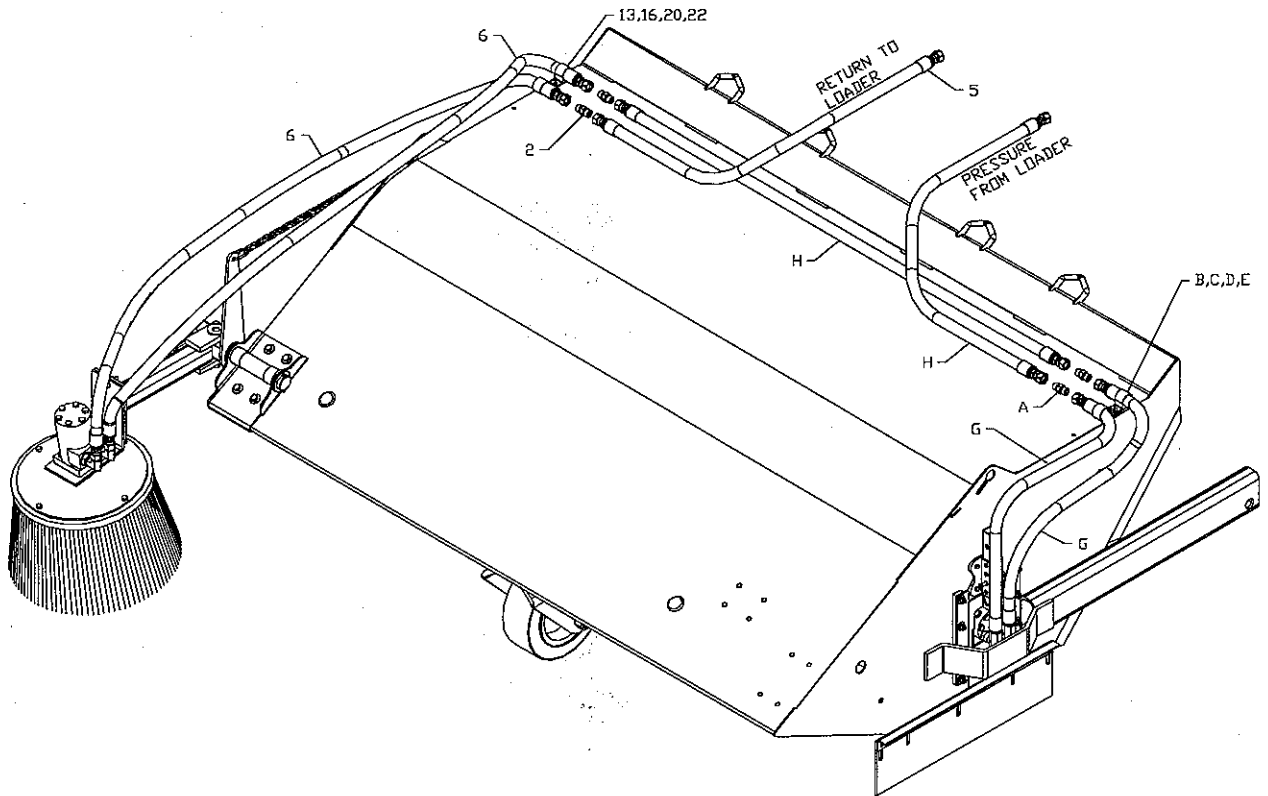

Item	Part	Qty	Description
2.	03-1919	2	Fitting, Union, 1/2 MFS, 1/2 MFS
5.	03-3813	1	Hose, 1/2 x 120, 451 AR, 1/2 FFS, 1/2 FFS
6.	03-3814	2	Hose, 1/2 x 56, 451 AR, 1/2 FFS, 1/2 FFS
13.	07-1714	4	Screw, Cap, 5/16-18 x 1
16.	07-1721	3	Clamp, Rubber Coat, 1 1/4 Hose
20.	07-3270	7	Nut, Hex, 5/16-18, Nylock
22.	07-3275	11	Washer, Flat, 5/16
A.	03-1919		Fitting, Union, 1/2 MFS, 1/2 MFS
B.	07-1714		Screw, Cap, 5/16-18 x 1
C.	07-1721		Clamp, Rubber Coat, 1 1/4 Hose
D.	07-3270		Nut, Hex, Nylock, 5/16-18
E.	07-3275		Washer, Flat, 5/16
G.	03-3811		Hose, 1/2 x 32, 451 AR, 1/2 FFS, 3/4 MORS, 90°
H.	03-3812		Hose, 1/2 x 72, 451 AR, 1/2 FFS Both Ends

**NOTE** – Alpha call outs are included with the sweeper assembly.

## Option – Gutter brush

### Hydraulic Hookup for Single Motor Unit with Dual Gutter Brush

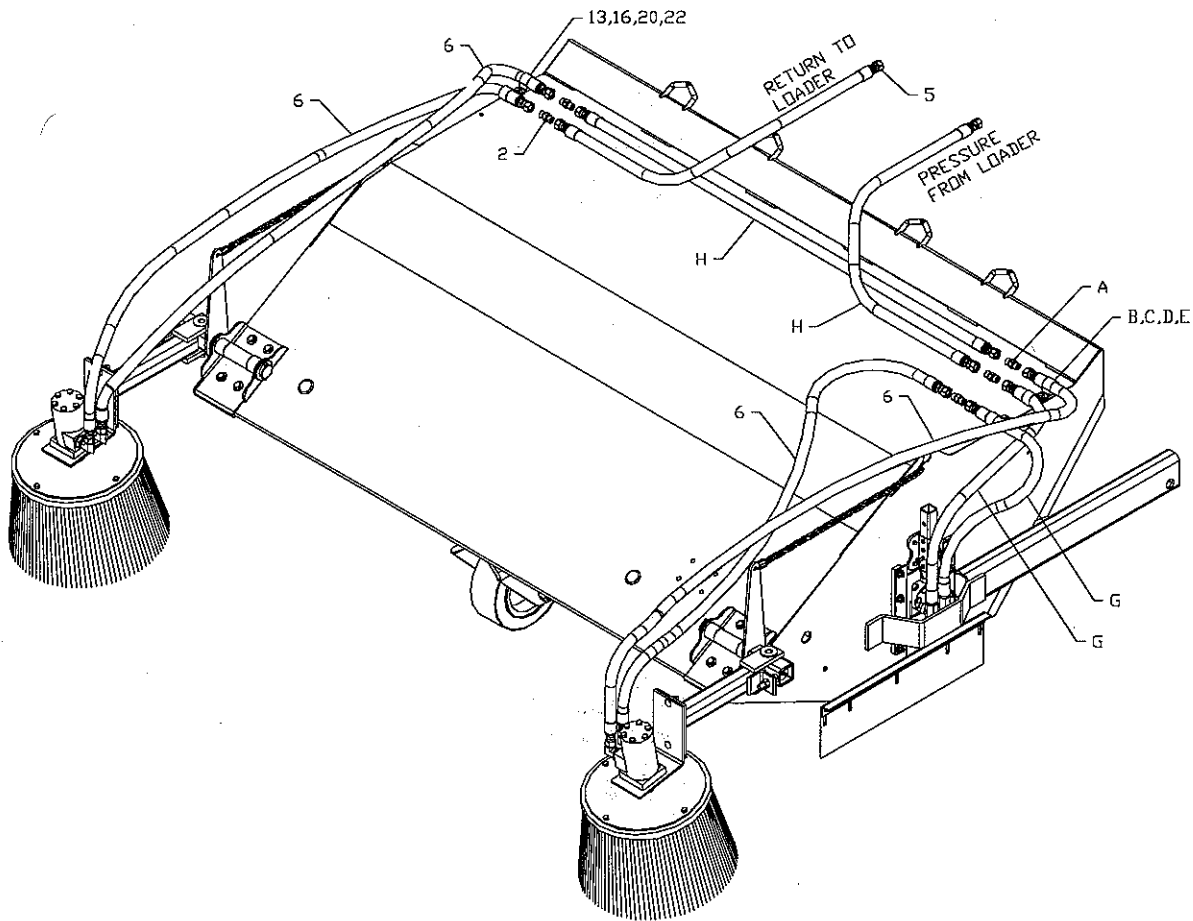

Item	Part	Qty	Description
2.	03-1919	2	Fitting, Union, 1/2 MFS, 1/2 MFS
5.	03-3813	1	Hose, 1/2 x 120, 451 AR, 1/2 FFS, 1/2 FFS
6.	03-3814	2	Hose, 1/2 x 56, 451 AR, 1/2 FFS, 1/2 FFS
13.	07-1714	4	Screw, Cap, 5/16-18 x 1
16.	07-1721	3	Clamp, Rubber Coat, 1 1/4 Hose
20.	07-3270	7	Nut, Hex, 5/16-18, Nylock
22.	07-3275	11	Washer, Flat, 5/16
A.	03-1919		Fitting, Union, 1/2 MFS, 1/2 MFS
B.	07-1714		Screw, Cap, 5/16-18 x 1
C.	07-1721		Clamp, Rubber Coat, 1 1/4 Hose
D.	07-3270		Nut, Hex, Nylock, 5/16-18
E.	07-3275		Washer, Flat, 5/16
G.	03-3811		Hose, 1/2 x 32, 451 AR, 1/2 FFS, 3/4 MORS, 90°
H.	03-3812		Hose, 1/2 x 72, 451 AR, 1/2 FFS Both Ends

**NOTE** – Alpha call outs are included with the sweeper assembly.

## Option – Gutter brush

### Hydraulic Hookup for Dual Motor Unit with Single Gutter Brush

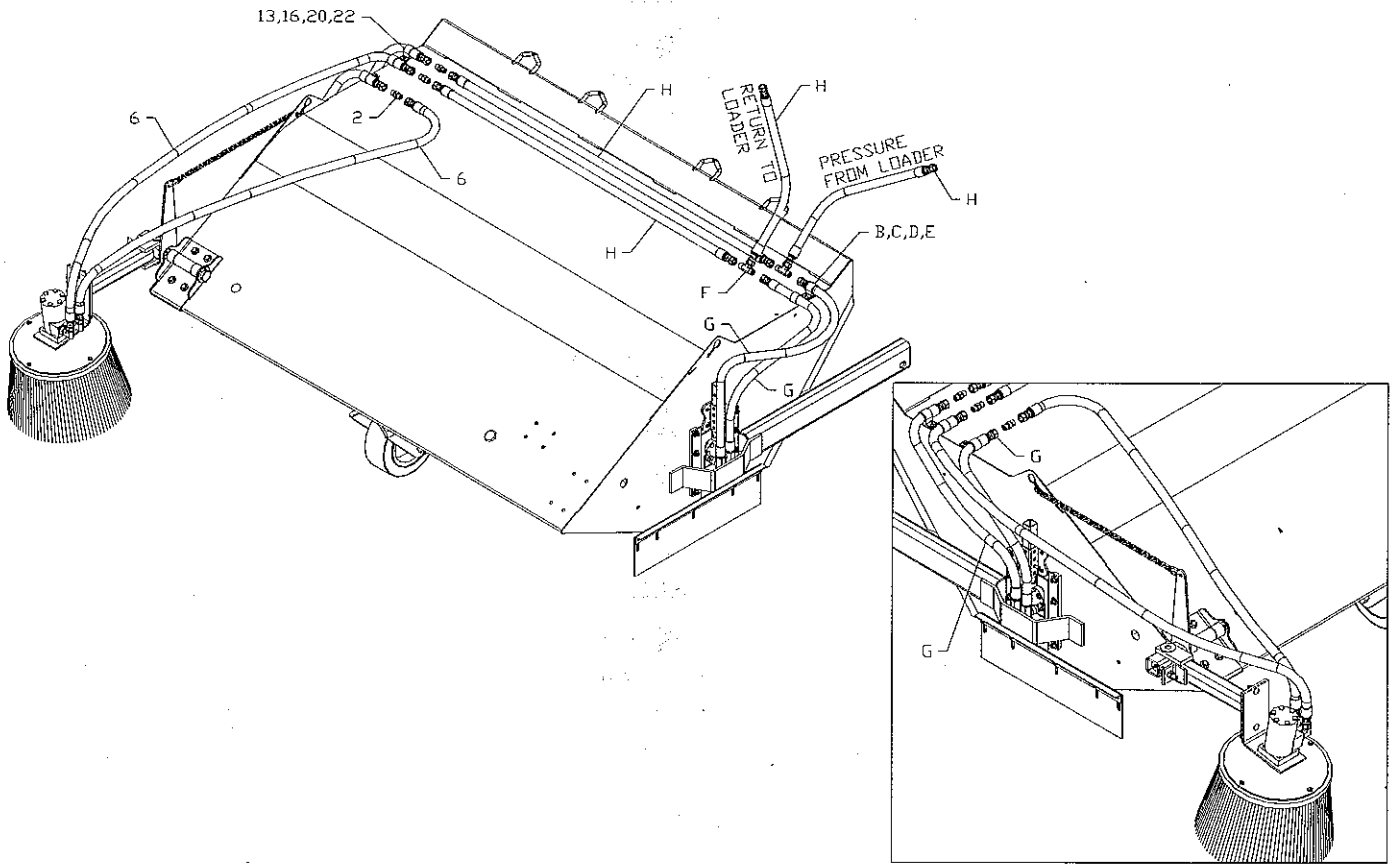

Item	Part	Qty	Description
2.	03-1919	2	Fitting, Union, 1/2 MFS, 1/2 MFS
6.	03-3814	2	Hose, 1/2 x 56, 451 AR, 1/2 FFS, 1/2 FFS
13.	07-1714	4	Screw, Cap, 5/16-18 x 1
16.	07-1721	3	Clamp, Rubber Coat, 1 1/4 Hose
20.	07-3270	7	Nut, Hex, 5/16-18, Nylock
22.	07-3275	11	Washer, Flat, 5/16
B.	07-1714		Screw, Cap, 5/16-18 x 1
C.	07-1721		Clamp, Rubber Coat, 1 1/4 Hose
D.	07-3270		Nut, Hex, Nylock, 5/16-18
E.	07-3275		Washer, Flat, 5/16
F.	03-3484		Fitting, #8 Male ORFS Union T
G.	03-3811		Hose, 1/2 x 32, 451 AR, 1/2 FFS, 3/4 MORS, 90°
H.	03-3812		Hose, 1/2 x 72, 451 AR, 1/2 FFS Both Ends

**NOTE** – Alpha call outs are included with the sweeper assembly.

## Option – Gutter brush

### Hydraulic Hookup for Dual Motor Unit with Dual Gutter Brushes

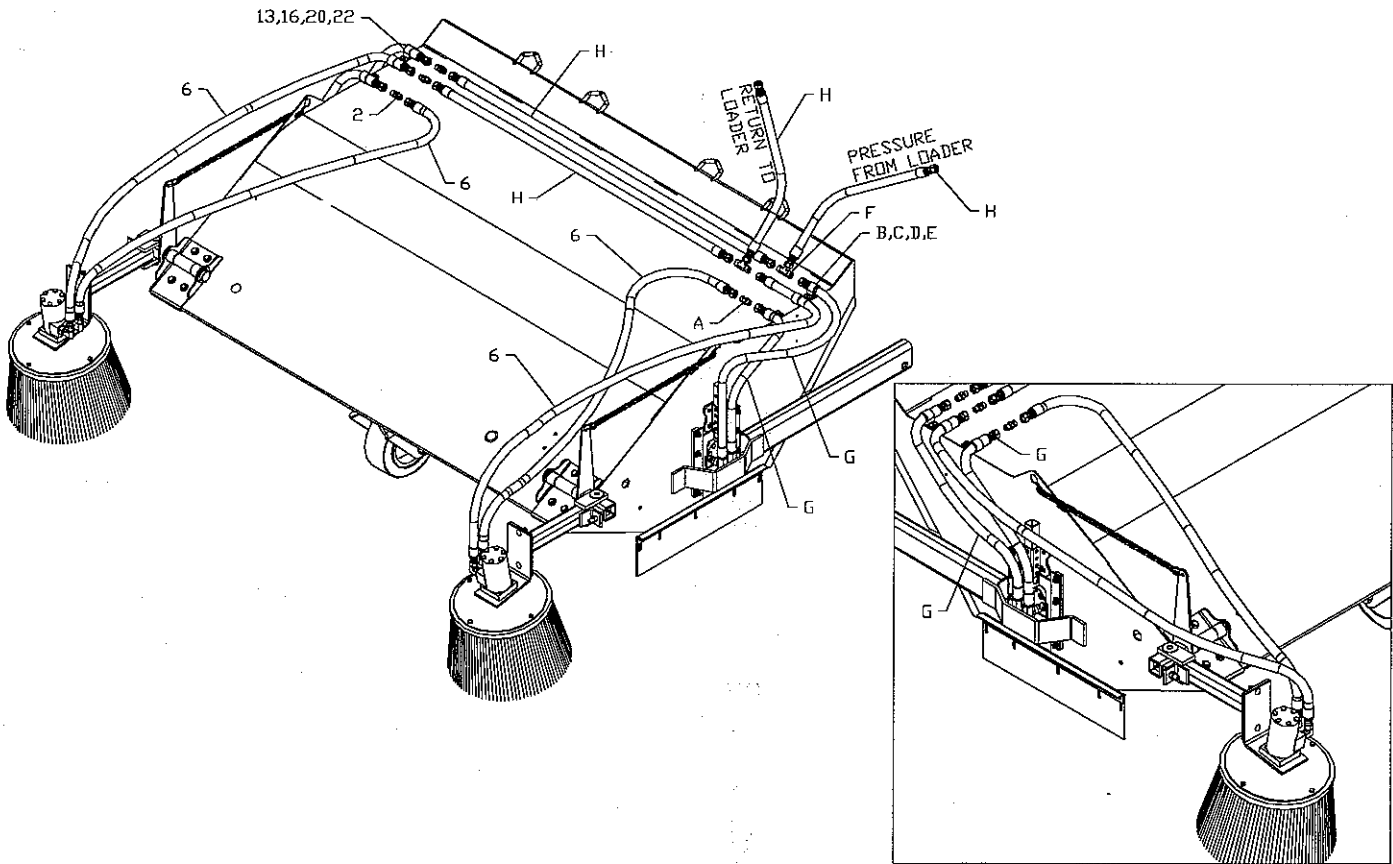

Item	Part	Qty	Description
2.	03-1919	2	Fitting, Union, 1/2 MFS, 1/2 MFS
6.	03-3814	4	Hose, 1/2 x 56, 451 AR, 1/2 FFS, 1/2 FFS
13.	07-1714	4	Screw, Cap, 5/16-18 x 1
16.	07-1721	3	Clamp, Rubber Coat, 1 1/4 Hose
20.	07-3270	7	Nut, Hex, 5/16-18, Nylock
22.	07-3275	11	Washer, Flat, 5/16
A.	03-1919		Fitting, Union, 1/2 MFS, 1/2 MFS
B.	07-1714		Screw, Cap, 5/16-18 x 1
C.	07-1721		Clamp, Rubber Coat, 1 1/4 Hose
D.	07-3270		Nut, Hex, Nylock, 5/16-18
E.	07-3275		Washer, Flat, 5/16
F.	03-3484		Fitting, #8 Male ORFS Union T
G.	03-3811		Hose, 1/2 x 32, 451 AR, 1/2 FFS, 3/4 MORS, 90°
H.	03-3812		Hose, 1/2 x 72, 451 AR, 1/2 FFS Both Ends

**NOTE** – Alpha call outs are included with the sweeper assembly.



## Option – Sprinkler

### Installation

1. Install the tank.
  - a. Position the tank on top of the sweeper body as far back as possible. Align the left-to-right centerlines of the tank and the sweeper. The outlet must face the left-hand side of the sweeper. See figure 27.
  - b. Transfer holes from the tank to the sweeper.
  - c. Drill holes.
  - d. Secure the tank to the sweeper with washers and screws.
  - e. Install a 5/8 in.–1/2 in. barb fitting on the tank outlet.
  - f. Connect the 10 ft (3 m) hose to the barb fitting. Secure it with a 7/8 in. (22 mm) hose clamp.
2. Remove 4 small plugs from the sweeper hood (figure 27).
3. Connect the filter to the pump. Place this assembly over the holes and secure it to the sweeper hood with 4 screws, nuts and washers (figure 28).
4. Attach a 5/8 in.–1/2 in. barb fitting to the strainer.
5. Connect the 10 ft (3 m) hose to the barb fitting. Secure it with a 7/8 in. (22 mm) hose clamp.
6. For sweepers with gutter brushes, on each gutter brush:
  - a. Remove 2 screws from the motor mounting plate.
  - b. Place the spraybar underneath the motor mounting plate.
  - c. Reinstall the hardware.
  - d. Clamp an elbow nozzle to the spraybar.

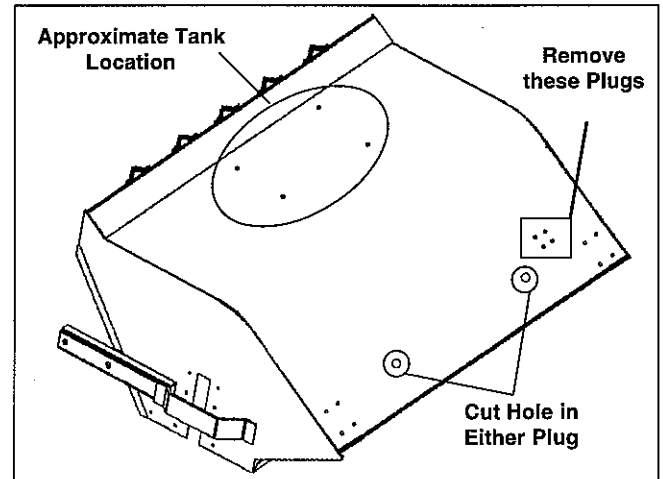

figure 27



figure 28

**Continued on next page**

## Option – Sprinkler

7. Measure and cut the 25 ft (7.6 m) hose into required lengths. Depending on the setup, you may have extra hose, nozzles and clamps.

### No Gutter Brush

- 2 – 14 in. (356 mm) lengths
- 1 – 18 in. (458 mm) length
- 1 – 32 in. (813 mm) length

### Single Gutter Brush on Right-Hand Side

- 2 – 14 in. (356 mm) lengths
- 1 – 18 in. (458 mm) length
- 1 – 32 in. (813 mm) length
- 1 – 42 in. (1067 mm) length

### Single Gutter Brush on Left-Hand Side

- 2 – 14 in. (356 mm) lengths
- 1 – 18 in. (458 mm) length
- 2 – 32 in. (813 mm) length
- 1 – 42 in. (1067 mm) length

### Dual Gutter Brush

- 2 – 14 in. (356 mm) lengths
- 1 – 18 in. (458 mm) length
- 2 – 32 in. (813 mm) length
- 2 – 42 in. (1067 mm) lengths

8. Assemble hoses and nozzles.

**NOTE** – Refer to figure 29 for a hose schematic. The view is from the perspective of facing the front of the unit.

- a. Connect a hose to the pump.
- b. Cut a hole through the middle of either large plug (figure 26).
- c. For dual gutter brush setup, add a T-fitting to the end of the hose. Then, connect a 42 in. (1067 mm) hose to the T-fitting's branch. Next, add an elbow nozzle to the end of the 42 in. (1067 mm) hose. Now, install the elbow nozzle on the spraybar fitting. To the other side of the T-fitting, add a 32 in. (813 mm) hose.
- d. Insert the hose through the plug.
- e. Attach a T-nozzle to the hose; secure it with a clamp.
- f. Add a 14 in. (356 mm) hose to the other side of the T-nozzle. Secure with a clamp. g. Install the T-nozzle on the first eyelet (figure 30).

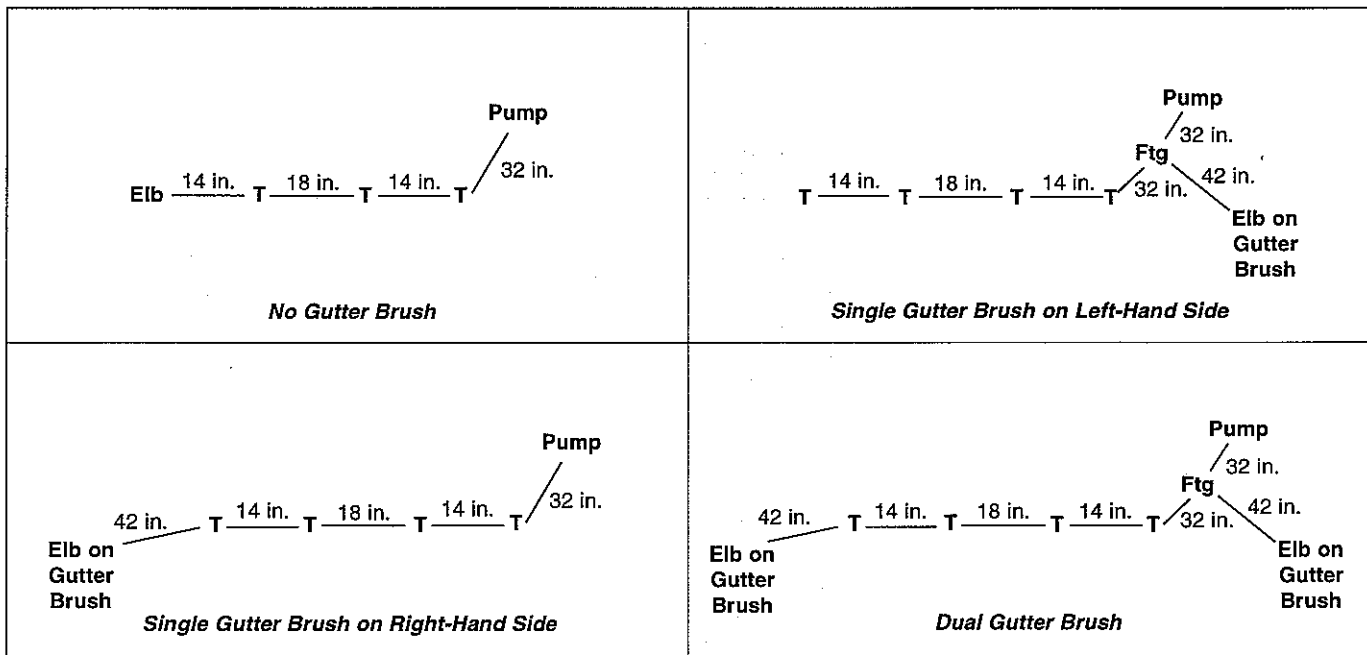

figure 29

## Option – Sprinkler

- g. Add a T-nozzle to the end of the hose; secure it with a clamp.
- h. Connect an 18 in. (458 mm) hose to the other side of the T-nozzle. Secure it with a clamp.
- i. Install the T-nozzle on the second eyelet.
- j. Thread the hose through the hole in the gusset in the middle of the beak.
- k. Add a T-nozzle to the end of the hose. Secure with a clamp.
- l. Add a 14 in. (356 mm) hose to the other side of the T-nozzle. Secure with a clamp.
- m. Add a nozzle to the end of the 14 in. (356 mm) hose.
  - For setup without gutter brushes, install an elbow nozzle.
  - For setup with gutter brushes, install a T-nozzle.
- n. Install the T-nozzle on the third eyelet and the nozzle added in step n on the last eyelet.
  - For setup without gutter brushes, hose and nozzle installation is complete. Go on to step 5.
  - For setup with gutter brushes, go on to step p.
- o. Add a 42 in. (1067 mm) hose to the other side of the T-nozzle.
- p. Cut a hole in the middle of the other large plug and then route the 42 in. (1067 mm) hose up through it.
- q. Attach an elbow nozzle to the end of the 42 in. (1067 mm) hose. Secure with a hose clamp.
- r. Install the elbow nozzle on the gutter brush.

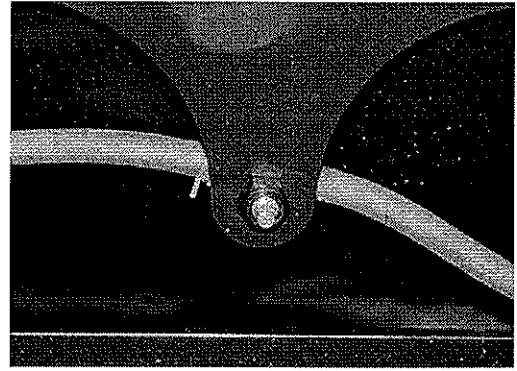
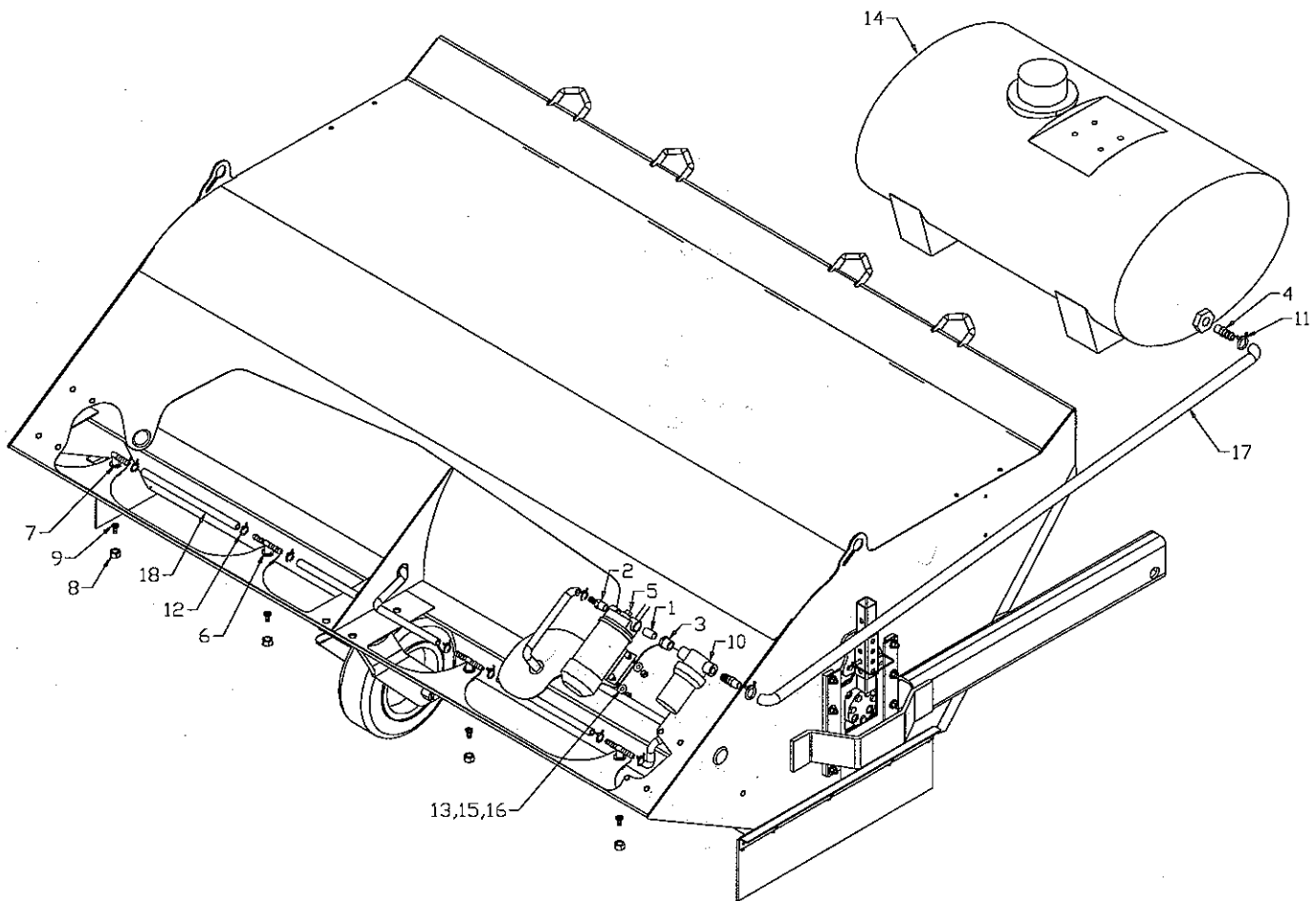

figure 30

## Option – Sprinkler

**For Sweeper without Gutter Brushes  
To order, ask for kit 11-5781 or 11-5784 (NoTank).**



Item	Part	Qty	Description	Item	Part	Qty	Description
1.	03-0076	1	Fitting, Nipple, BP, Close, 3/8	14.	07-3150	1	Tank, Water, 25 gal (11-5781 Only)
2.	03-0457	1	Fitting, Barb, Nylon, 3/8-3/8 MP	15.	07-3270	4	Nut, Hex, 5/16-18, Nylock
3.	03-0819	1	Fitting, Reducer Bushing, BP, 1/2-3/8	16.	07-3275	4	Washer, Flat, 5/16
4.	03-1226	2	Fitting, Barb, HP, 5/8-1/2 MP	17.	09-0028	10 ft	Hose, Heater, 5/8
5.	03-1326	1	Pump, Flojet, Water, 2.9 gpm	18.	09-0056	25 ft	Hose, Heater, 3/8
6.	07-0411	3	Nozzle, Tee, with Clamp	NS.	07-0343	1	Switch, Toggle, Two Position
7.	07-0412	1	Nozzle, Elbow, with Clamp	NS.	07-0917	15 ft	Wire, Cord, 16 Gauge
8.	07-0413	4	Nozzle, Cap, Nylon	NS.	07-3416	1	Fitting, Cap, 25 Gal., Water, Tank
9.	07-0414	4	Nozzle, Tip, Brass	NS.	07-3417	1	Cap, 25 Gal., Water Tank
10.	07-0532	1	Strainer, Water				
11.	07-0547	2	Clamp, Spring, 7/8, Hose				
12.	07-0549	8	Clamp, Spring, 5/8, Hose				
13.	07-1714	4	Screw, Cap, 5/16-18 x 1				

## Option – Sprinkler

**For Sweeper with Gutter Brush On Left-Hand Side  
To order, ask for kit 11-5780 or 11-5786 (No Tank).**

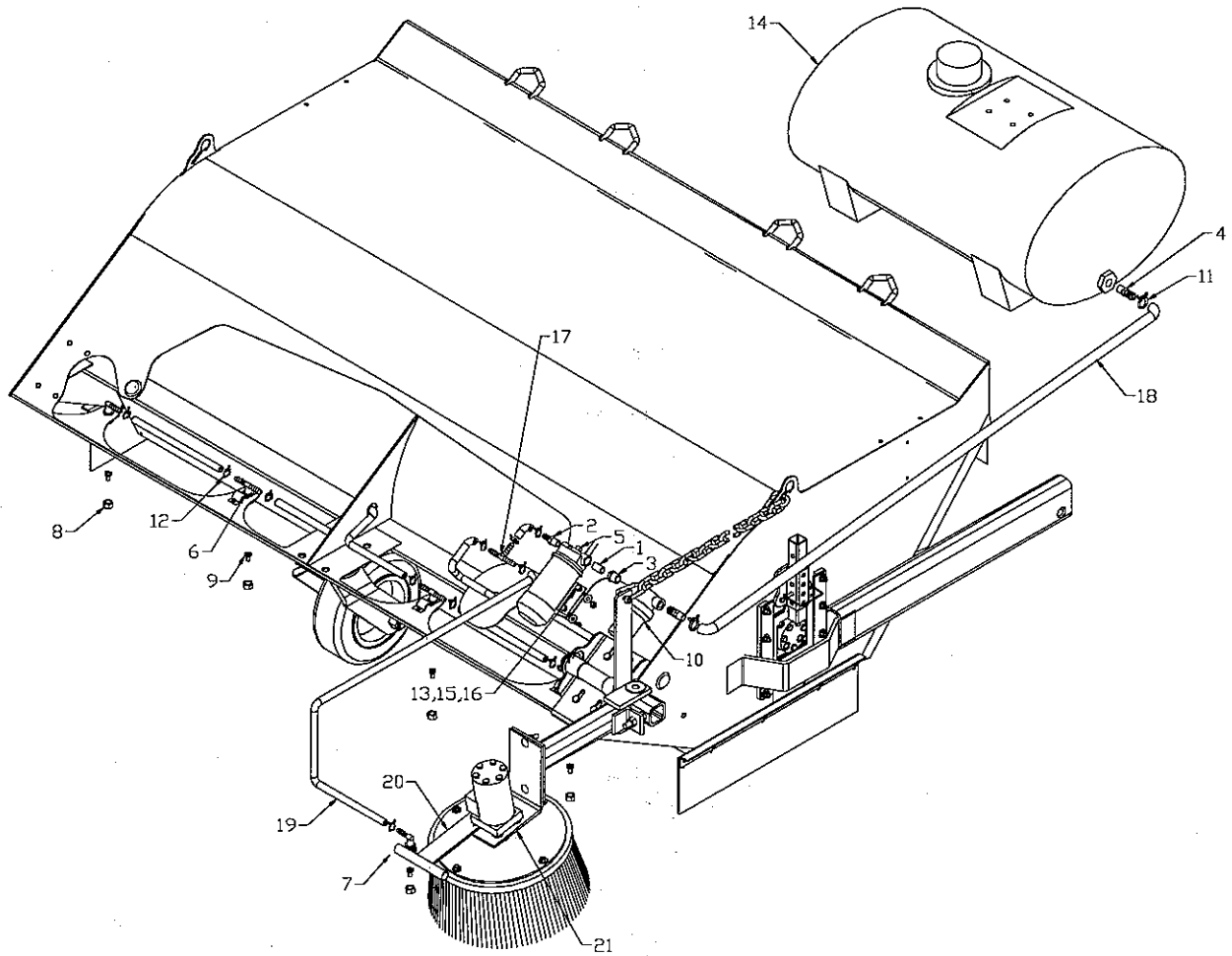

Item	Part	Qty	Description
1.	03-0076	1	Fitting, Nipple, BP, Close, 3/8
2.	03-0457	1	Fitting, Barb, Nylon, 3/8-3/8 MP
3.	03-0819	1	Fitting, Reducer Bushing, BP, 1/2-3/8
4.	03-1226	2	Fitting, Barb, HP, 5/8-1/2 MP
5.	03-1326	1	Pump, Flojet, Water, 2.9 gpm
6.	07-0411	3	Nozzle, Tee, with Clamp
7.	07-0412	1	Nozzle, Elbow, with Clamp
8.	07-0413	4	Nozzle, Cap, Nylon
9.	07-0414	4	Nozzle, Tip, Brass
10.	07-0532	1	Strainer, Hypro, Water
11.	07-0547	2	Clamp, Spring, 7/8, Hose
12.	07-0549	8	Clamp, Spring, 5/8, Hose
13.	07-1714	4	Screw, Cap, 5/16-18 x 1

Item	Part	Qty	Description
14.	07-3150	1	Tank, Water, 25 gal (11-5780 Only)
15.	07-3270	4	Nut, Hex, 5/16-18, Nylock
16.	07-3275	4	Washer, Flat, 5/16
17.	07-3869	1	Fitting, Barb, Tee, Nylon, 3/8
18.	09-0028	10 ft	Hose, Heater, 5/8
19.	09-0056	25 ft	Hose, Heater, 3/8
20.	13-2490	2	Spraybar, Gutterroom
21.	HBBGB	1	Gutterbrush, Attachment, Wire
	HBBGBP	1	Gutterbrush, Attachment, Poly
NS.	07-0343	1	Switch, Toggle, Two Position
NS.	07-0917	15 ft	Wire, Cord, 16 Gauge
NS.	07-3416	1	Fitting, Cap, 25 Gal., Water, Tank
NS.	07-3417	1	Cap, 25 Gal., Water Tank

## Option – Sprinkler

For Sweeper with Gutter Brush on Right-Hand Side  
To order, ask for kit 11-5780 or 11-5786 (NoTank).

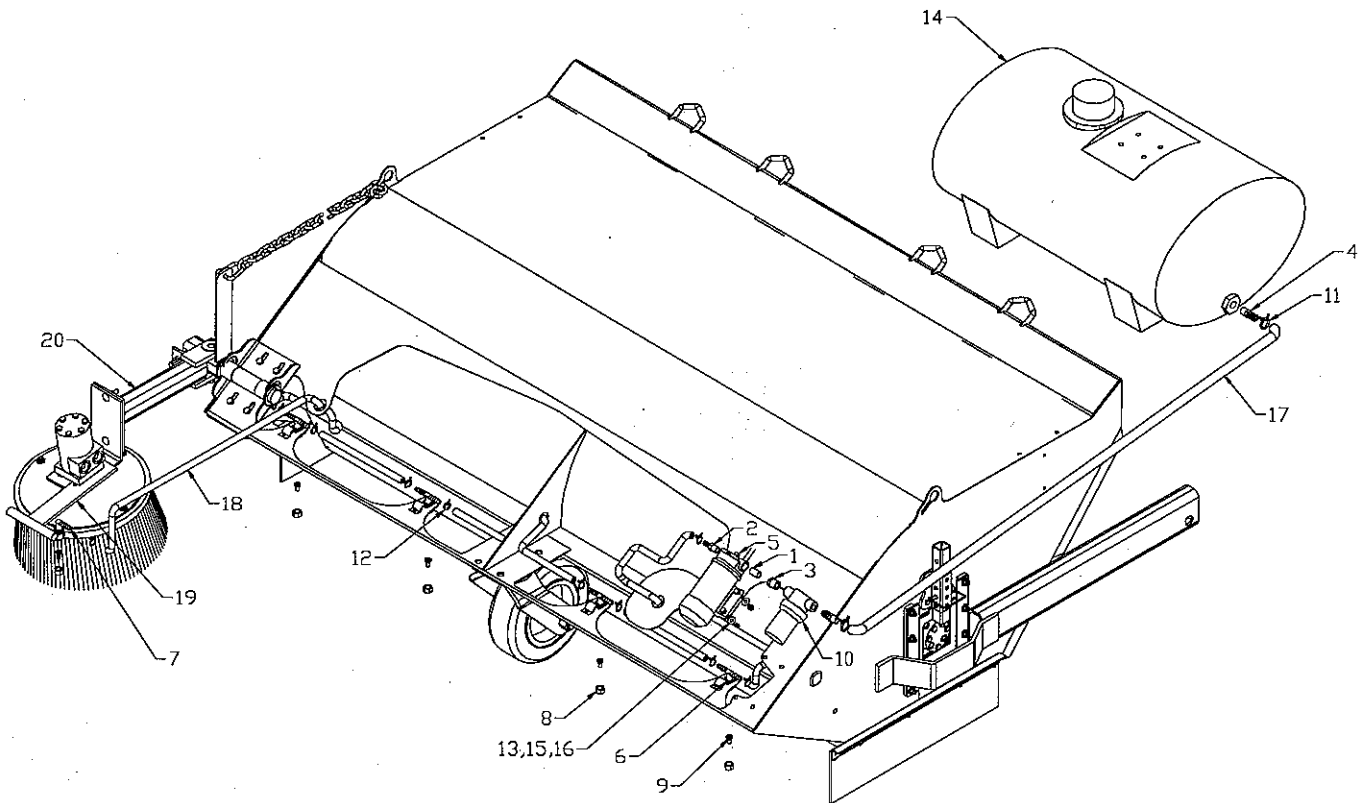

Item	Part	Qty	Description
1.	03-0076	1	Fitting, Nipple, BP, Close, 3/8
2.	03-0457	1	Fitting, Barb, Nylon, 3/8-3/8 MP
3.	03-0819	1	Fitting, Reducer Bushing, BP, 1/2-3/8
4.	03-1226	2	Fitting, Barb, HP, 5/8-1/2 MP
5.	03-1326	1	Pump, Flojet, Water, 2.9 gpm
6.	07-0411	4	Nozzle, Tee, with Clamp
7.	07-0412	2	Nozzle, Elbow, with Clamp
8.	07-0413	6	Nozzle, Cap, Nylon
9.	07-0414	6	Nozzle, Tip, Brass, TK 1.5
10.	07-0532	1	Strainer, Hypro, Water
11.	07-0547	2	Clamp, Spring, 7/8, Hose
12.	07-0549	14	Clamp, Spring, 5/8, Hose
13.	07-1714	4	Screw, Cap, 5/16-18 x 1
14.	07-3150	1	Tank, Water, 25 gal (11-5780 Only)

Item	Part	Qty	Description
15.	07-3270	4	Nut, Hex, 5/16-18, Nylock
16.	07-3275	4	Washer, Flat, 5/16
17.	09-0028	10 ft	Hose, Heater, 5/8
18.	09-0056	25 ft	Hose, Heater, 3/8
19.	13-2490	2	Spraybar, Gutterbroom
20.	HBBGB	2	Gutterbroom, Attachment, Wire
	HBBGBP	2	Gutterbroom, Attachment, Poly
NS.	07-0343	1	Switch, Toggle, Two Position
NS.	07-0917	15 ft	Wire, Cord, 16 Gauge
NS.	07-3416	1	Fitting, Cap, 25 Gal., Water, Tank
NS.	07-3417	1	Cap, 25 Gal., Water, Tank

# Option – Sprinkler

For Sweeper with Dual Gutter Brushes  
To order, ask for kit 11-5780 or 11-5786 (No Tank).

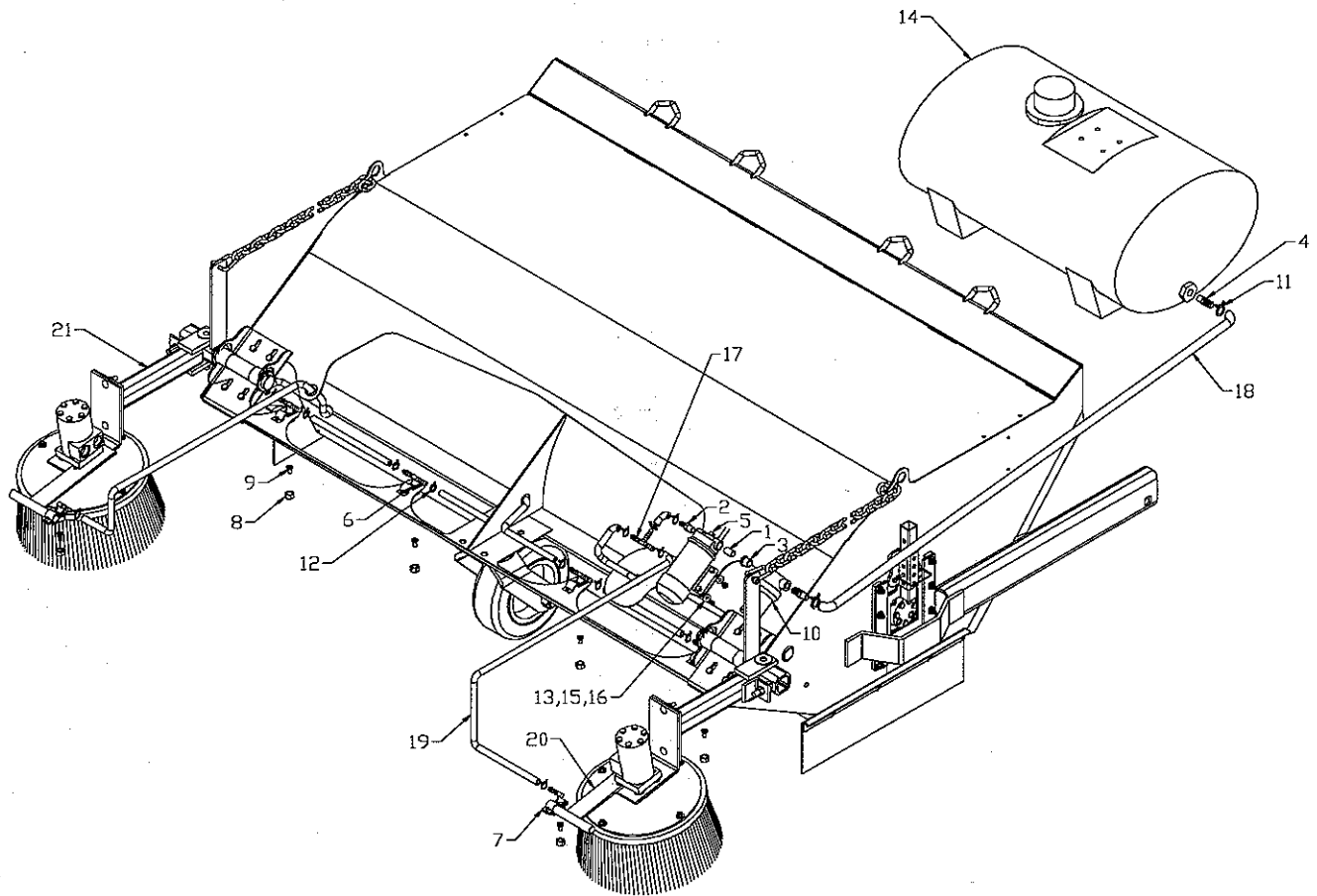

Item	Part	Qty	Description
1.	03-0076	1	Fitting, Nipple, BP, Close, 3/8
2.	03-0457	1	Fitting, Barb, Nylon, 3/8, 3/8 MP
3.	03-0819	1	Fitting, Reducer Bushing, BP, 1/2, 3/8
4.	03-1226	2	Fitting, Barb, HP, 5/8, 1/2 MP
5.	03-1326	1	Pump, Flojet, Water, 2.9 gpm
6.	07-0411	4	Nozzle, Tee, with Clamp
7.	07-0412	2	Nozzle, Elbow, with Clamp
8.	07-0413	6	Nozzle, Cap, Nylon
9.	07-0414	6	Nozzle, Tip, Brass, TK 1.5
10.	07-0532	1	Strainer, Hypro, Water
11.	07-0547	2	Clamp, Spring, 7/8, Hose
12.	07-0549	14	Clamp, Spring, 5/8, Hose
13.	07-1714	4	Screw, Cap, 5/16-18 x 1
14.	07-3150	1	Tank, Water, 25 gal (11-5780 Only)

Item	Part	Qty	Description
15.	07-3270	4	Nut, Hex, 5/16-18, Nylock
16.	07-3275	4	Washer, Flat, 5/16
17.	07-3869	1	Fitting, Barb, Tee, Nylon, 3/8
18.	09-0028	10 ft	Hose, Heater, 5/8
19.	09-0056	25 ft	Hose, Heater, 3/8
20.	13-2490	2	Spraybar, Gutterbroom
21.	HBBGB	2	Gutterbroom, Attachment, Wire
	HBBGP	2	Gutterbroom, Attachment, Poly
NS.	07-0343	1	Switch, Toggle, Two Position
NS.	07-0917	15 ft	Wire, Cord, 16 Gauge
NS.	07-3416	1	Fitting, Cap, 25 Gal., Water, Tank
NS.	07-3417	1	Cap, 25 Gal., Water, Tank

## Option – Flow Divider

### Hydraulic Hookup Assembly 13-11203

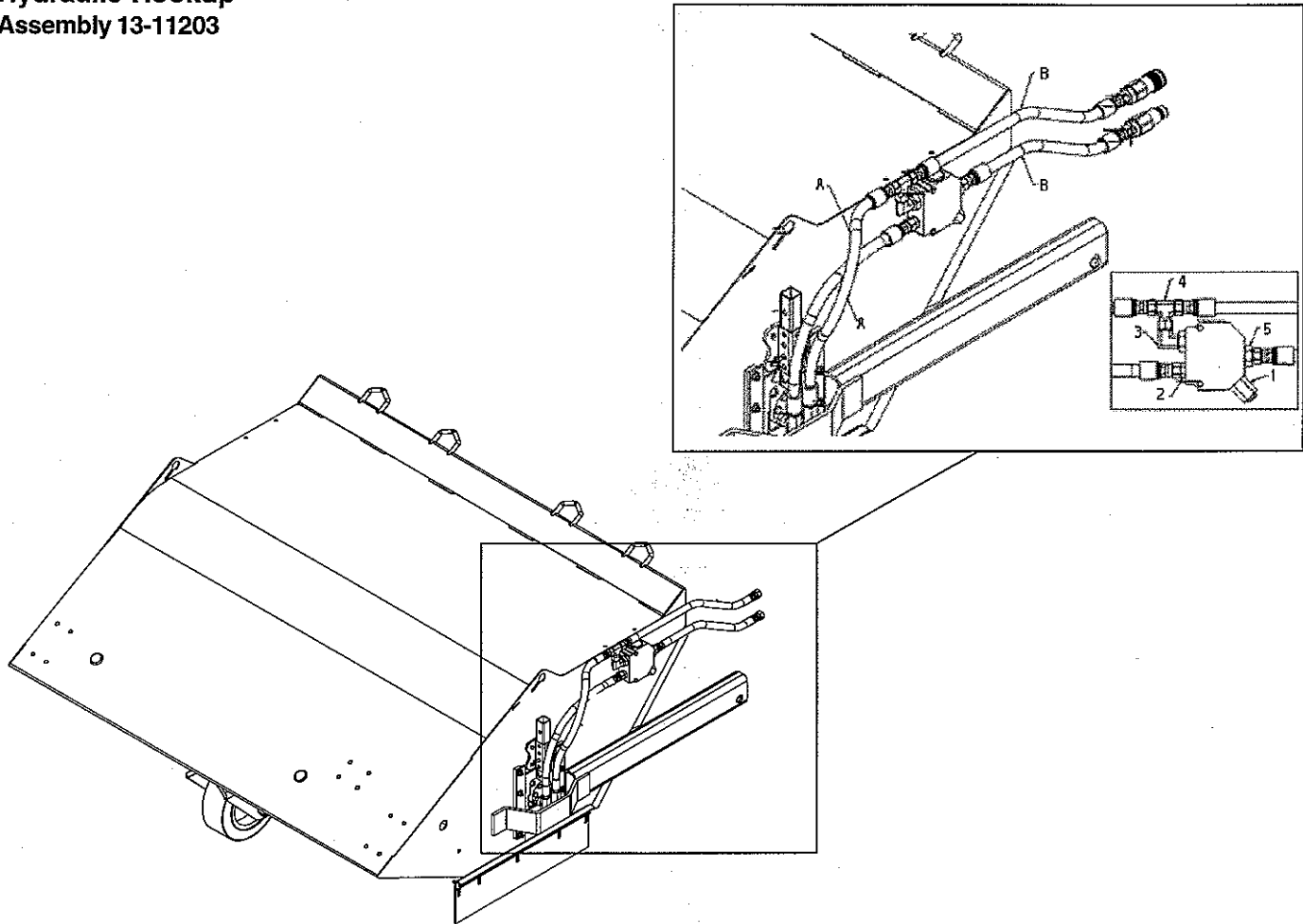

Item	Part	Qty	Description
1.	03-3607	1	Valve, Flow Divider, Fix, 12 GPM
2.	03-3514	1	Fitting, 13/16-16 ORFS, Tube End, 3/4-16 STOR
3.	03-3571	1	Fitting, Elbow, #8 ORFS, Tube End, #12 STOR
4.	03-3572	1	Fitting, Tee, #8 ORFS, Tube End, #8 ORFS Swivel
5.	03-3515	3	Fitting, 13/16-16 ORFS, Tube End, 1 1/16-12 STOR
A.	03-3811	2	Hose, 1/2 x 32, 451 AR, 1/2 FFS, 3/4 MORS, 90°
B.	03-3812	2	Hose, 1/2 x 72, 451 AR, 1/2 FFS, Both Ends

**NOTE** – Alpha call outs are included with the sweeper assembly.



# Option – Flow Divider

## Hydraulic Hookup with Single Gutter Brush Assembly 13-11203

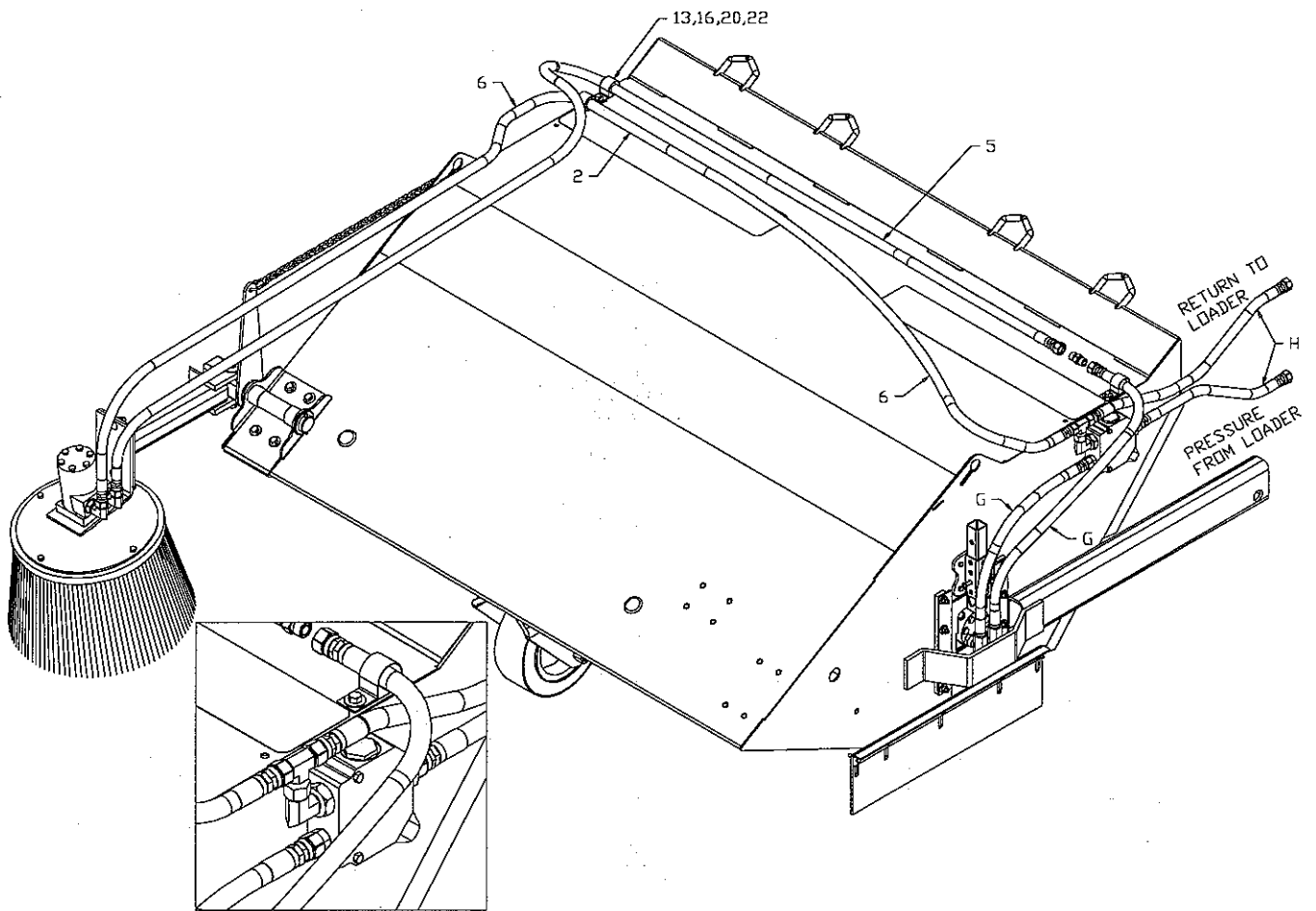

**NOTE** – Drawing for hydraulic hook-up only. See page 48 for 13-11203 parts list.

## Option – Flow Divider

### Hydraulic Hookup with Dual Gutter Brush Assembly 13-11203

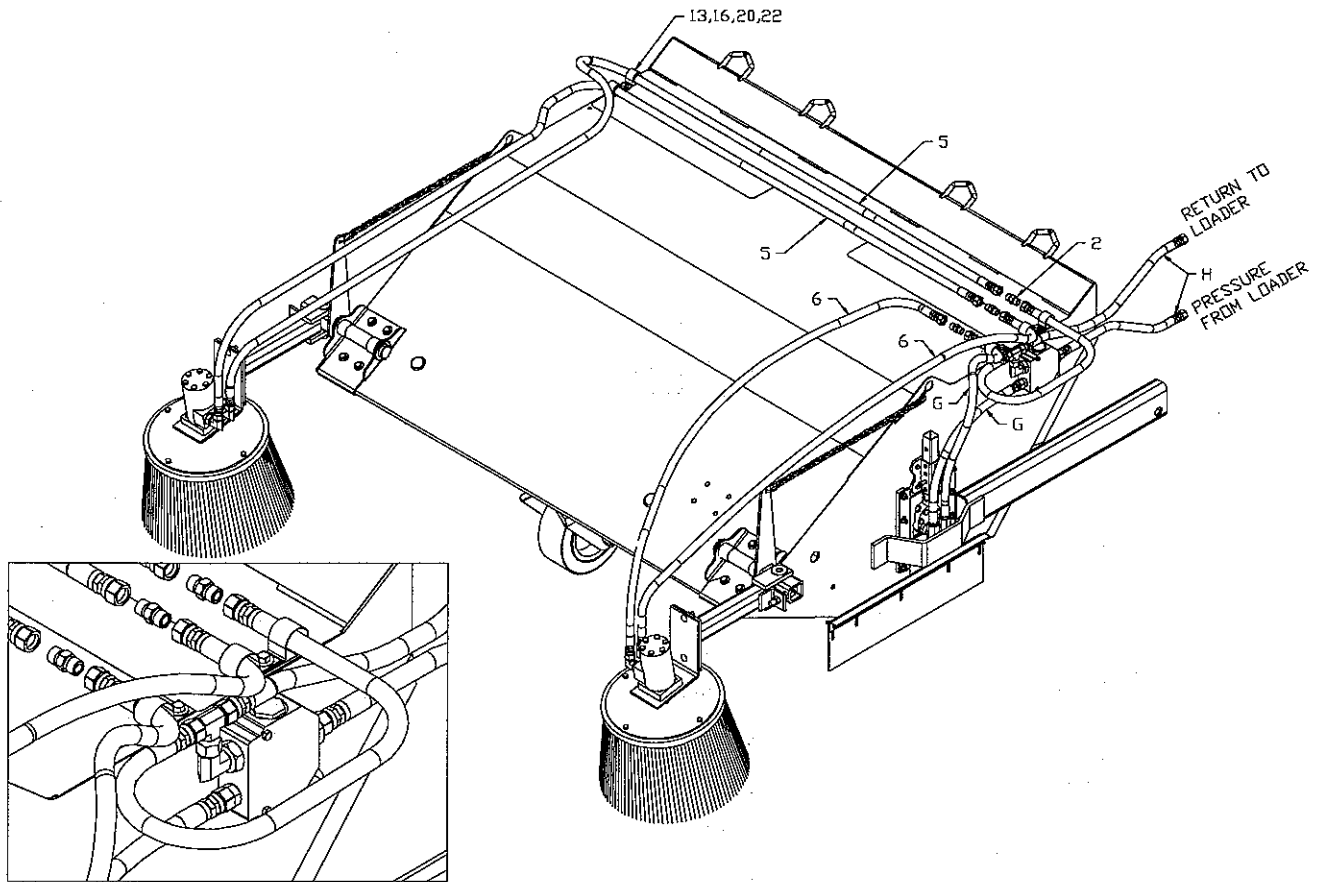

**NOTE** – Drawing for hydraulic hook-up only. See page 48 for 13-11203 parts list.

# Torque Values

## Bolt Torque Specifications

Body Size Grade 5	Ft-lbs		Body Size Class 8.8	Ft-lbs
1/4 - 20	6 ± 1		M6 - 1.0	5 ± 1
- 28	7 ± 1		n/a	-
5/16 - 18	13 ± 3		n/a	-
- 24	14 ± 3		n/a	-
3/8 - 16	23 ± 5		M8 - 1.25	14 ± 3
- 24	26 ± 5		- 1.0	-
7/16 - 14	37 ± 8		M10 - 1.5	29 ± 6
- 20	41 ± 9		- 0.75	-
1/2 - 13	56 ± 11		M12 - 1.75	50 ± 10
- 20	63 ± 12		- 1.0	-
9/16 - 12	82 ± 14		M14 - 2.0	80 ± 14
- 18	91 ± 16		- 1.5	-
5/8 - 11	113 ± 20		M16 - 2.0	125 ± 22
- 18	127 ± 23		- 1.5	-
3/4 - 10	201 ± 26		n/a	-
- 16	223 ± 29		n/a	-
7/8 - 9	321 ± 41		M20 - 2.5	244 ± 31
- 14	355 ± 46		- 1.5	-
1 - 8	483 ± 62		M24 - 3.0	422 ± 54
- 12	528 ± 68		- 2.0	-

Body Size Grade 8	Ft-lbs		Body Size Class 10.9	Ft-lbs
1/4 - 20	9 ± 2		M6 - 1.0	8 ± 1
- 28	10 ± 2		n/a	-
5/16 - 18	18 ± 4		n/a	-
- 24	20 ± 4		n/a	-
3/8 - 16	32 ± 7		M8 - 1.25	20 ± 4
- 24	37 ± 8		- 1.0	-
7/16 - 14	52 ± 11		M10 - 1.5	40 ± 8
- 20	58 ± 12		- 0.75	-
1/2 - 13	80 ± 16		M12 - 1.75	69 ± 14
- 20	90 ± 18		- 1.0	-
9/16 - 12	115 ± 20		M14 - 2.0	110 ± 20
- 18	128 ± 23		- 1.5	-
5/8 - 11	159 ± 28		M16 - 2.0	173 ± 31
- 18	180 ± 32		- 1.5	-
3/4 - 10	282 ± 36		n/a	-
- 16	315 ± 41		n/a	-
7/8 - 9	454 ± 59		M20 - 2.5	337 ± 44
- 14	500 ± 65		- 1.5	-
1 - 8	681 ± 88		M24 - 3.0	583 ± 75
- 12	746 ± 97		- 2.0	-

Foot-pounds may be converted to Newton Meters by multiplying by 1.35582.

Foot-pounds may be converted to Inch-pounds by dividing by 12.

If the nut and screw are not the same grade, the lower grade will always be used.

**NOTE** – Nylock nuts are utilized when greater resistance to vibrating loose is required, and greater operating temperatures are not a factor. In addition, like lock nuts, nylock nuts have a safety feature that if the bolt does vibrate loose, the nut will remain on the screw. Install nylock nuts to the standard torque shown above.

# Warranty Information

## Warranty Registration

Return form to: 734-996-9014



PALADIN LIGHT CONSTRUCTION

### Warranty Registration Form and Delivery Inspection Report

**IMPORTANT!** Warranty Void if card is not returned within 10 days.  
All Applicable sections must be filled in.

This section to be filled out and signed by Dealer at time of delivery.

#### Warranty Registration

Customer's Name _____	Dealer's Name _____
Address _____	Address _____
City _____ State _____ Zip _____	City _____ State _____ Zip _____
Phone _____	CHECK ONE:
Loader / Tractor Model _____	Construction Use _____
Delivery Date _____	Agricultural Use _____
Model or Part # _____	Landscape Use _____
Serial # _____	Other: _____

#### Dealer Inspection (check items applicable)

- |  |  |
|--|--|
| <input type="checkbox"/> All Decals installed (see operator's manual)<br><input type="checkbox"/> Hydraulic fittings tight and free of leaks<br><input type="checkbox"/> Fasteners tight | <input type="checkbox"/> Review Operating and Safety Instructions<br><input type="checkbox"/> Guards and covers in place and secure<br><input type="checkbox"/> Does Product Function Properly |
|--|--|

I have thoroughly instructed the buyer on the above described equipment. This review included: The Operator's manual content, equipment care, adjustments, safe operation and applicable warranty policy.

Date \_\_\_\_\_ Dealer's Rep. signature \_\_\_\_\_

#### This section to be completed and signed by the customer

	1 Excellent	2 Good	3 Average	4 Unsatisfactory	5 Poor
<b>QUALITY ASSURANCE RATING</b>					
Question:		Sweepster		Local Dealer	
Quality of Product: Appearance .....		_____		_____	
Construction .....		_____		_____	
Quality of Service .....		_____		_____	
Value (Priced Fairly) .....		_____		_____	
Does it perform as claimed .....		_____		_____	

The above described equipment and Operator's Manual have been received by me and I have been thoroughly instructed as to care, adjustments, safe operation and applicable warranty policy.

Date: \_\_\_\_\_ Owner's signature \_\_\_\_\_

**NOTE!** Make one copy each for the dealer's and owner's records. Mail original to Sweepster.

Comments: \_\_\_\_\_  
 \_\_\_\_\_  
 \_\_\_\_\_

Sweepster, Inc  
 2800 N. Zeeb Rd.  
 Dexter, MI 48130-9499  
 800-456-7100  
 fax 734-996-9014



## SWEEPSTER Limited Six Month Warranty

For a period of six (6) months from date of delivery of product to the original user, Sweepster, Inc. of Dexter, Michigan warrants each product to be free from manufacturing defects, subject to the limitations contained in this policy.

This warranty does not apply to defect caused, in whole or in part, by unreasonable use while in the possession of the user, including, but not limited to: failure to properly set up product; failure to provide reasonable and necessary maintenance; normal wear; routine tune ups or adjustments; improper handling or accidents; operation at speed or load conditions contrary to published specifications; improper or insufficient lubrication; improper storage. This warranty is also not a guarantee that the performance of each product will meet the expectations of the purchaser.

Sweepster, Inc. shall not be liable for consequential damages of any kind, including, but not limited to: consequential labor costs or transportation charges in connection with the replacement of repair of defective parts; lost time or expense which may have accrued because of said defects. In no event shall Sweepster, Inc.'s total liability hereunder exceed the product purchase price.

Sweepster, Inc. makes no warranty with respect to trade accessories or any component or accessory of the product which was not manufactured by Sweepster, Inc. including any purchased components of any kind. These are subject to the warranties of their respective manufacturers. The warranty will be considered void if the product or any part of the product is modified or repaired in any way not expressly authorized by Sweepster, Inc., or if closed components are disassembled prior to return. Closed components include, but are not limited to: gearboxes, hydraulic pumps, motors, cylinders, and actuators.

Our obligation under the warranty is expressly limited, at our option, to the replacement or repair at Sweepster, Inc. of Dexter, Michigan, or at a service facility designated by us, or such part or parts as inspection shall disclosed to have been defective. We are not responsible for unauthorized repairs or replacements. Any implied or statutory warranties, including any warranty of merchantability or fitness for a particular purpose, are expressly limited to the duration of this written warranty. We make no other express warranty, nor is anyone authorized to make any in our behalf. This warranty cannot be extended, broadened, or changed except in writing by an authorized officer of Sweepster, Inc.

## Glossary – Terms & Abbreviations

**BP** – black pipe

**brush head assembly** – assembly that includes the core, hood and brush frame.

**brush pattern** – area of dirt removed from sweeping surface; with a properly adjusted sweeper, the pattern is the same width for the entire length.

**caution** – indicates a potentially hazardous situation which, if not avoided, may result in minor or moderate injury.

**CV** – constant velocity; usually refers to a drive shaft.

**core** – weldment that holds brush sections.

**dirt deflector** – kit made of metal and/or rubber parts designed to direct debris away from the operator.

**electric lift** – means of raising the brush head assembly electrically.

**F** – female.

**FS** – face seal.

**gpm** – gallons per minute.

**HP** – high pressure.

**hood** – brush shield.

**hydraulic angle kit** – means of swinging the brush head assembly hydraulically.

**hydraulic lift** – means of raising the brush head assembly hydraulically.

**important** – used for instructions when machine damage may be involved.

**in.** – inches.

**kph** – kilometers per hour.

**lb** – pounds.

**left-hand** – side that is on the left when facing the normal forward direction of travel of the machine.

**lps** – liters per second.

**M** – male.

**mm** – millimeters.

**mph** – miles per hour.

**manual angle kit** – means of swinging the brush head assembly mechanically.

**mid pump unit** – sweeper in which the pump is mounted on the mid PTO.

**mounting assembly** – portion of the sweeper that attaches to the prime mover; designed specifically for each prime mover.

**NPT** – national pipe thread.

**note** – indicates supplementary information.

**OR** – O-ring.

**psi** – pounds per square inch.

**PTO** – power take off; shaft on the prime mover used to drive attachments.

**power pack** – auxiliary hydraulic packaged used when prime mover hydraulics do not have enough flow available.

**prime mover** – refers to the tractor, truck, loader or other vehicle to which a sweeper is attached.

**qty** – quantity.

**rpm** – revolutions per minute.

**rear pump unit** – sweeper in which the pump is mounted on a rear PTO.

**retainer** – removable plate or set of plates that keeps sections on the core.

**right-hand** – side that is on the right when facing the normal forward direction of travel of the machine.

## Glossary – Terms & Abbreviations

**section** – single brush wafer.

**section set** – replacement brush wafers.

**spring-chain assembly** – assembly that helps keep the sweeper in proper adjustment yet allows it to pivot up and down.

**sprinkler system** – system that sprays water ahead of the sweeper; used to reduce dust.

**sprinkler tank** – assembly that includes the water reservoir and mounting used in a sprinkler system.

**stands** – devices designed to keep the brush off the ground when the sweeper is dismounted.

**swing assembly** – portion of the sweeper that allows the brush head assembly to angle.

**swing cylinder** – means of angling the brush head assembly hydraulically.

**tank assembly, hydraulic** – assembly that includes the hydraulic reservoir, filter and fittings; may also incorporate valves.

**transport chain** – chain that supports the weight of the brush head assembly during transport between work sites and during adjustment of the spring-chain assemblies.

**warning** – indicates a potentially hazardous situation which, if not avoided, could result in death or serious injury.

**weld** – weldment.

**windrow** – pile of debris.

**zerk** – grease fitting.