

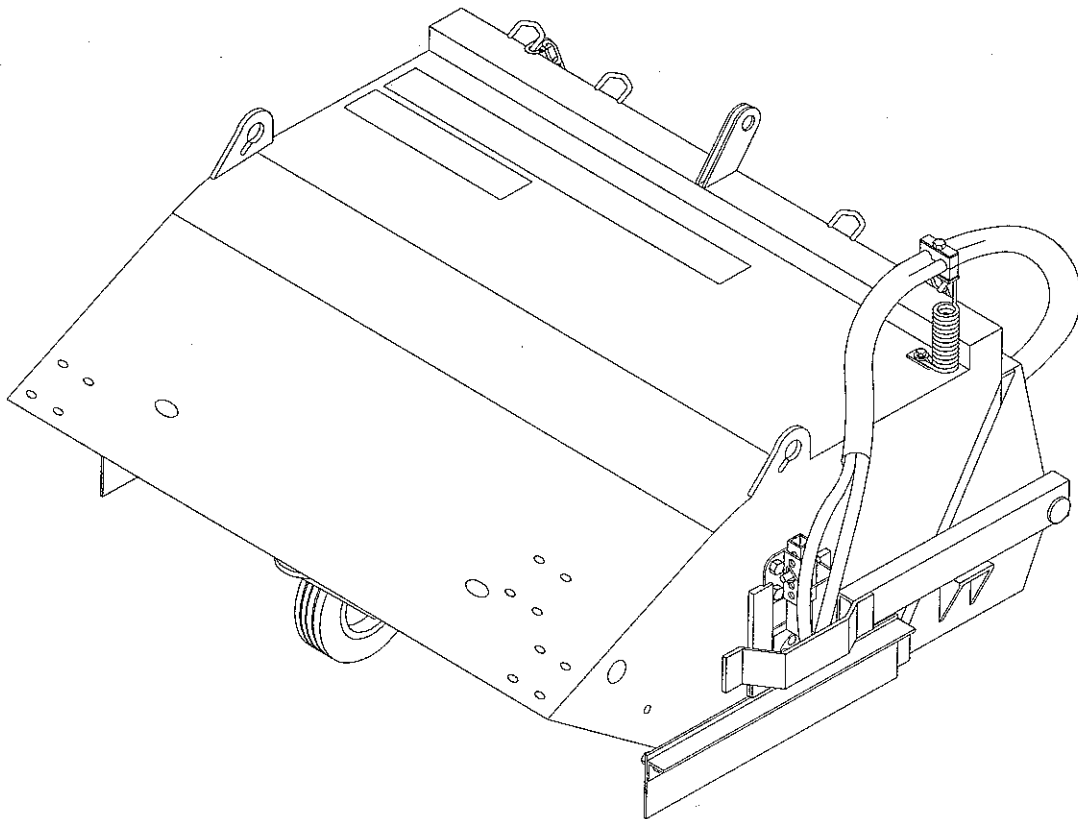

A SWEEPSTER COMPANY

PICK-UP BROOM

OWNERS & OPERATORS MANUAL



Models covered:
LAF8253, LAF8254, LAF2864,
and **LAF8307**

OWNER'S & OPERATOR'S MANUAL
FFC PART # MR05588

FFC Attachments
100 East Lee Road
Lee, IL 60530
(800)-747-2132
www.ffcattachments.com

03-24-04

TABLE OF CONTENTS

Introduction, General Information, Serial Number.....	1
Owner and Operator Safety Information.....	2-5
Definitions of Safety Terms and Symbols, Accident Prevention.....	2
Safety Instructions.....	3-4
Safety Signs.....	5
Power Unit Specifications, Mounting.....	6
Hydraulic Connection	7
Setup	8
Operation	9
Maintenance	9-10
Service	11-12
Storage	12
Trouble Shooting.....	13
Parts Illustration.....	14
Parts List.....	15-16
Specifications	16
Warranty	i

INTRODUCTION

Congratulations on your purchase of a new **FFC Attachments Pick-Up Broom**. This product has been designed and built to sweep up and collect loose, dry debris and other light materials from relatively hard, flat surfaces while moving forward. This product can also be used for picking up small amounts of material near a wall or other obstruction while reversing the brush rotation for a short distance. You or any other person who will be assembling, operating, maintaining, or working with this product are required to read and completely understand the information and instructions contained in this manual. If anyone does not fully understand every part of this manual, please obtain further assistance by contacting the dealer from which this product was purchased or by contacting FFC at the telephone number or address listed on the cover of this manual. Keep this manual available for reference whenever this product is being handled or used. Provide this manual to any new owners and/or operators.

This manual covers model(s) **LAF8253, LAF8254, LAF2864 and LAF8307**. The difference between the models is the width and power of the product, details of which are covered on the parts list and specifications page(s).

GENERAL INFORMATION

The purpose of this manual is to assist in assembling, mounting, operating, and maintaining your **Pick-Up Broom**. Read this manual carefully to obtain valuable information and instructions that will help you achieve years of safe and dependable service.

The illustrations and data used in this manual were current at the time of printing, but due to possible engineering and/or production changes, this product may vary slightly in detail. FFC reserves the right to redesign and/or change components as may be necessary without notification to anyone.

Throughout this manual, references may be made to:

Power Unit	The engine-driven machine to which this product must be attached.
Right, Left, Front, Rear	Directions that are determined in relation to the operator of the equipment when seated in the normal operating position.

IMPORTANT NOTICE

Precautions that must be followed to prevent damage to equipment.

Precautions that must be followed to prevent substandard performance.

SERIAL NUMBER LOCATION

Always refer to the model and serial number when ordering parts or requesting information from your dealer. The serial number plate for this product is located **on the top left rear corner** of your **Pick-Up Broom**.

Reference Information

Model Number _____	Loader Make _____
Serial Number _____	Loader Model _____
Date Purchased _____	Loader Serial # _____

DEFINITION OF SAFETY TERMS AND SYMBOLS

Throughout this manual, the terms **DANGER**, **WARNING**, and **CAUTION** are used to indicate the degree of hazard to personnel if proper safety procedures are not followed. These words will be used in conjunction with the Safety Alert Symbol: a dark triangle containing a white exclamation mark.



The Safety Alert Symbol means:

ATTENTION! BECOME ALERT! YOUR SAFETY IS INVOLVED!

DANGER Indicates an imminently hazardous situation which, if not avoided, **WILL result in death or serious injury.**

WARNING Indicates a potentially hazardous situation which, if not avoided, **could result in death or serious injury.**

CAUTION Indicates a potentially hazardous situation which, if not avoided, **may result in minor or moderate injury;**

OR

may also be used to alert against unsafe practices that may result in personal injury.

ACCIDENTS CAN BE PREVENTED WITH **YOUR HELP!**

No accident prevention program can be successful without the wholehearted cooperation of the person who is directly responsible for the operation of the equipment.

To read equipment accident reports from all over the country is to be convinced that a large number of accidents can be prevented only by operators who consistently anticipate the results of their actions and thus prevent accidents from ever occurring. No power-driven equipment, whether it is on the highway, in a farm field, or in an industrial plant, can be any safer than is allowed by the person who is at the controls.

If accidents are to be prevented (and accidents can be prevented), that prevention will come from equipment operators who accept their complete responsibility.

The designer, the manufacturer, and the safety engineer all help create a safe product, but the operator of that product can wipe out their combined efforts with a single careless act.

The best safety device is a careful operator. FFC and your dealer ask that **YOU** be that careful, responsible operator.

YOU ARE THE KEY TO SAFETY BECAUSE:

YOU are responsible for the SAFE operation and maintenance of **YOUR** Pick-Up Broom.

YOU are responsible to familiarize yourself, and anyone else who will assemble, operate, maintain, or work around this product, with the SAFETY information contained in this manual.

YOU are responsible to read ALL information contained in this manual to any operators or maintenance personnel who are not fully able to read the written English language. Whether **YOU** read the manual as written or translate it into another language, **YOU** must make certain that all operators and maintenance personnel have a complete understanding of the full and exact contents of this manual. Translations of this manual into other languages are available by submitting an order to FFC.

YOU can reduce the risk of injury or death by following all safety precautions and by using good safety practices.

SAFETY INSTRUCTIONS

WORK SAFELY - A CAREFUL OPERATOR IS THE BEST INSURANCE AGAINST ACCIDENTS !!

WARNING SECTION



WARNING

Obey all the safety instructions listed in this section and throughout this manual. Failure to obey instructions in this section could result in death or serious injury.

BEFORE ATTEMPTING ANY TYPE OF ASSEMBLY, OPERATION, MAINTENANCE, OR OTHER WORK ON OR NEAR THIS PRODUCT:

- **READ AND COMPLETELY UNDERSTAND THIS MANUAL.**
- **READ AND COMPLETELY UNDERSTAND THE MANUALS PROVIDED WITH YOUR *power unit, loader, and quick-attach.***
- Read and understand all safety signs on this product and on your power unit, loader, and quick-attach.
- Know all your controls and know how to quickly stop all power unit movement, the Pick-Up Broom movement, and the engine in case of an emergency.
- Know and obey all applicable government rules, O.S.H.A. regulations, local laws and other professional guidelines for your operation.
- Make sure that anyone who will be assembling, mounting, maintaining, repairing, removing, and/or storing this product:
 - has been instructed in the safe operation of this product and of the power unit, loader, and quick-attach to which this product is attached.
 - is physically and mentally capable of the safe operation of this type of equipment.
 - is not under the influence of drugs or alcohol.
 - is carefully supervised from a safe distance, especially if such person is inexperienced.
 - wears appropriate protective equipment (i.e. hardhat, safety glasses, work gloves, protective shoes, respirator, ear protection, etc.).
 - does not wear loose fitting clothing, loose or uncovered hair, or any accessories (jewelry, necktie, scarf, wrist watch, etc.) that can catch in moving parts.
 - has annually reviewed all safety instructions.
- Know and follow good work practices when assembling, mounting, maintaining, repairing, removing, and storing this product:
 - Work on a level surface in a well-lit area.
 - Keep the area clean and dry.
 - Use properly grounded electrical outlets & tools.
 - Use the right tool for the job at hand.

WHEN YOUR POWER UNIT IS USED DURING ANY TYPE OF ASSEMBLY, OPERATION, MAINTENANCE, OR OTHER WORK ON OR NEAR THIS PRODUCT:

- Before leaving the operator's station or before beginning any type of work on this product, lower this product to the ground, apply your power unit's parking brake, stop the engine, remove the starter key, wait for all moving parts to stop, and then relieve all pressure in the hydraulic lines. Refer to your power unit's operator's manual for instructions on how to relieve hydraulic pressure in lines.
- Know your loader's safe lifting and operating capacity and the weight of this product. See the specifications in this manual for the weight of this product and refer to your power unit's and your loader's operator's manuals for safe operating limits. Lift capacity may be reduced if using a quick-attach.
- Never allow anyone, except the operator, to be around the power unit or this product when either is in motion. Do not startup unless others are clear of the work area.
- Do not allow riders on this product or the power unit.
- Do not stand or climb on this product when raised.
- Never lift the lowest portion of the bucket higher than 5'-0" above the ground.
- Do not place any part of your body under any part of this product unless this product is securely resting on adequate blocking or on the ground.
- Do not use blocking made of concrete blocks, logs, buckets, barrels or any other material that could suddenly collapse or shift positions. Do not use wood or steel blocking that shows any signs of material decay. Do not use blocking that is warped, twisted, or tapered.
- Never operate controls from the ground. Operate the controls only from the operator's station.
- Never leave equipment unattended with the engine running or with this product raised on the loader.
- Be aware of the added weight and width of this product. Reduce travel speeds accordingly, especially when traveling over rough ground.
- Keep this product close to the ground and under control when transporting.

SAFETY INSTRUCTIONS

WORK SAFELY - A CAREFUL OPERATOR IS THE BEST INSURANCE AGAINST ACCIDENTS !!

WARNING SECTION (CONTINUED)



WARNING

Obey all the safety instructions listed in this section and throughout this manual. Failure to obey instructions in this section could result in death or serious

injury.

WHEN DEALING WITH HYDRAULICS DURING ANY TYPE OF ASSEMBLY, OPERATION, MAINTENANCE, OR OTHER WORK ON OR NEAR THIS PRODUCT:

- Hydraulic fluid under pressure can penetrate the skin and cause serious injury or death. Hydraulic leaks under pressure may not be visible!
- If any fluid penetrates the skin, **GET IMMEDIATE MEDICAL ATTENTION!!**
- Wear safety glasses, protective clothing, and use a sound piece of cardboard or wood when searching for hydraulic leaks. **DO NOT USE YOUR HANDS!**
- Before connecting or disconnecting hydraulic hoses, read your power unit's operator's manual for detailed instructions on connecting and disconnecting hydraulic attachments.
- Make certain that all parts meet the specifications for this product when installing or replacing hydraulic hoses or fittings.
- After connecting hydraulic lines:
 - Slowly and carefully raise the loader and cycle the rollback / dump cylinders to check hose clearances and to check for any interference.
 - Operate the hydraulics on this product to check hose clearances and to check for any interference.
 - Make certain that the hoses cannot interfere with or actuate the quick-attach mechanism.
 - Make certain that hoses will not be pinched, or get tangled, in any equipment.
- Do not lock the auxiliary hydraulics of your power unit in the "ON" position.
- Refer to your power unit's operator's manual and this manual for procedures and intervals, then inspect and maintain the entire hydraulic system to insure that the fluid remains clean, that all devices function properly, and that there are no fluid leaks.

WHEN MOUNTING THIS PRODUCT TO YOUR POWER UNIT:

- Refer to the operator's manuals of your power unit, your loader, and your quick-attach for special or detailed mounting instructions.
- This product should fit onto the quick-attach or loader arms of your power unit the same as the original products that were designed by your loader / quick-attach manufacturer.
- If this product does not fit properly, contact FFC before operating.
- Never place your finger into the mounting plate or loader holes. A slight movement of the power unit or this product could cause serious injury.

BEFORE EACH USE, THOROUGHLY INSPECT THIS PRODUCT AND:

- Make certain that all safety signs are in place and legible. Refer to the safety sign page in this manual for the placement of safety signs for this product.
- Replace all damaged or excessively worn parts and hardware only with genuine FFC parts or with properly rated fasteners, hydraulic hoses, or fittings.
- Make certain that all locking pins, latches, and connection devices are properly installed and secured.
- Make certain that all protective guards, canopies, doors, etc. are in place and secure.

WHEN OPERATING THIS PRODUCT IN ACCORDANCE WITH DESIGN INTENTIONS:

- Do not sweep toward others. Flying debris may cause serious injury.
- Minimize flying debris by operating at the slowest brush speed needed to achieve the desired results.
- Make sure that the dump restraint chains are clear of the quick-attach release lever. Entanglement of the chains could disengage this product from your power unit.

WHEN ADJUSTING, SERVICING OR REPAIRING THIS PRODUCT:

- Make no modifications to your Pick-Up Broom.
- When making repairs, use only genuine FFC parts or, for fasteners, hydraulic hoses, or hydraulic fittings, use only properly rated parts.
- Replacement parts, for parts with safety signs attached, must also have safety signs attached.

SAFETY SIGN LOCATIONS

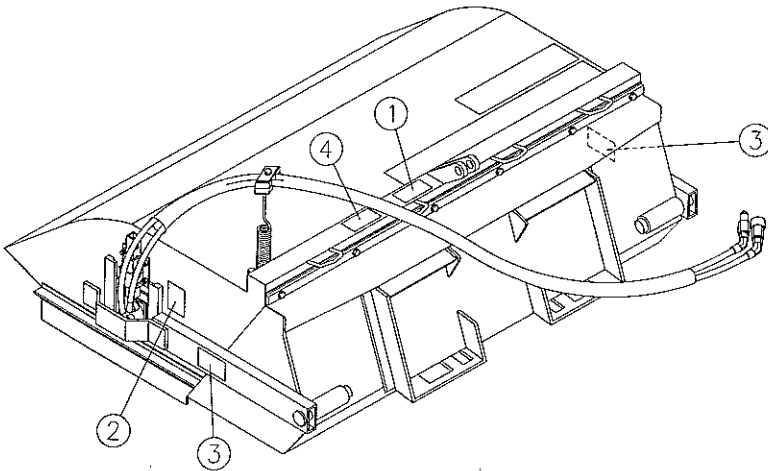

ITEM	QTY.	PART # - DESCRIPTION
1	1	RDL3141-Read Manual
2	1*	RDL3129-Hydraulics
3	2	RDL3127-Pinch Point
4	1	RDL3162-Flying Objects

* NOTE: Provide two for dual motor units.

INSTRUCTIONS

- Keep all safety signs clean and legible.
- Replace all missing, illegible, or damaged safety signs.
- Replacement parts for parts with safety signs attached must also have safety signs attached.
- Safety signs are available, free of charge, from your dealer or from FFC.

PLACEMENT OR REPLACEMENT OF SAFETY SIGNS

1. Clean the area of application with non-flammable solvent, and then wash the same area with soap and water.
2. Allow the surface to fully dry.
3. Remove the backing from the safety sign, exposing the adhesive surface.
4. Apply the safety sign to the position shown in the diagram above and smooth out any bubbles.

ITEM 1

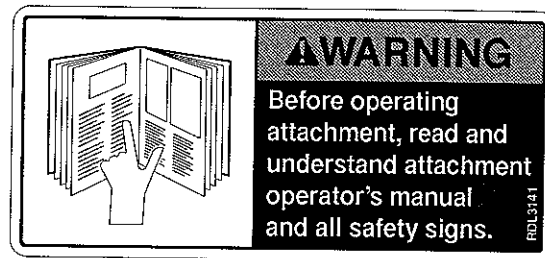

ITEM 2



ITEM 3



ITEM 4

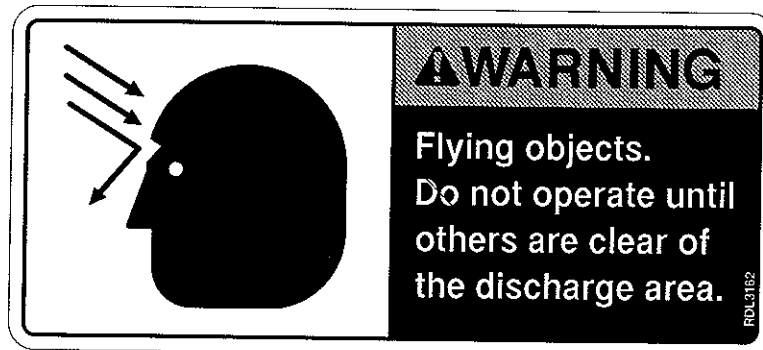

POWER UNIT SPECIFICATIONS

IMPORTANT

Exceeding any of the maximum recommended power unit specifications **CAN** result in damage to this product and **WILL** void all FFC warranties.

DESCRIPTION

Hydraulic Pressure Output
Hydraulic Flow

SPECIFICATIONS

3,300 psi. maximum
15 gpm maximum per motor (i.e. 30 gpm max. for dual motor unit)

Rear Ballast

As required to maintain full power unit stability.
(Note the Shipping Weight on page 16, then see the operator's manual(s) for your power unit, loader, and quick-attach for ballasting needs.)

PICK-UP BROOM MOUNTING



SAFETY FIRST!! READ AND UNDERSTAND THE SAFETY INSTRUCTIONS (pages 2-5 of this manual) BEFORE BEGINNING ANY PICK-UP BROOM MOUNTING

1. Place this product on a firm, level surface that is large enough to safely accommodate this product, your power unit and all workers involved in the mounting process.

IMPORTANT

Lifting this product before Step 7 below **CAN** result in damage to this product and **WILL** void all FFC warranties.

2. Refer to the operator's manual(s) for your power unit, loader, and quick-attach and follow the mounting instructions contained therein.
3. Once mounted, place your power unit's transmission in "Park" and engage the parking brake.
4. Shut off your power unit's engine, remove the starter key, wait for all moving parts to come to a stop, and relieve all pressure in the hydraulic lines.
5. Wrap the rubber sleeve covered portion of one chain around the torque tube between your loader's arms and secure the chain back to itself using a connecting link. Repeat for the other chain. (NOTE: The "torque tube" is the main horizontal structural element that secures the lower portion of your loader's arms together. If your power unit does not have a torque tube between the loader arms or if hydraulic lines, wiring, or other components could be damaged when force is applied to the installed chain, wrap the chains through the "grab handles" if they are on your loader arms. If required, please contact FFC for assistance.)
6. Slide the chains apart, out toward the loader arms, and feed the free end of each chain through the closest loop on the upper rear edge of the sweeper housing. The choice of which pair of loops to use (the pair of loops that are closest to the center of the sweeper housing verses the pair of loops that are closest to the left and right sides of the sweeper housing) is determined by which pair of loops will keep the chains in the most straight front-to-rear alignment. Secure each chain back to itself with a connecting link. Once fastened, the chains should be equal in length and should be relatively loose.
7. Restart your power unit. Fully retract the tilt cylinders and shorten the chain connections as needed so they can **NOT** extend downward enough to de-activate the loader's quick attach locking mechanism(s) once the tilt cylinders are extended again. Carefully raise the loader and cycle the tilt cylinders to check clearances and to verify that all mounting procedures have been successfully completed. When your loader arms are raised and the bucket is dumped, the sweeper housing should remain approximately parallel with the ground.
 - If the sweeper housing is level or slopes up from your loader arms, continue with Step 8 below.
 - If the sweeper housing slopes down from your loader arms, return this product to the position found in Step 2 above, repeat Steps 3 and 4 above, and then relocate the front chain connection link one or two links further back toward your power unit. Repeat this step until the sweeper housing is level.
8. **IMPORTANT** Lubricate all grease fittings before connecting this product to your power unit's hydraulic system. Refer to **PICK-UP BROOM MAINTENANCE** on page 10 and follow the instructions.

PICK-UP BROOM HYDRAULIC CONNECTION



SAFETY FIRST!! READ AND UNDERSTAND THE SAFETY INSTRUCTIONS (pages 2-5 of this manual) BEFORE BEGINNING ANY PICK-UP BROOM HYDRAULIC CONNECTION

1. Disconnect the hydraulic hose quick couplers from one another and attach the quick couplers to your power unit as per the instructions in your power unit's operator's manual.
2. Carefully raise the loader and cycle the tilt cylinders to check hose clearances and to check for any interference.



WARNING

Do not lock the auxiliary hydraulics of your power unit in the "ON" position. Failure to obey this warning could result in death or serious injury.

PICK-UP BROOM SETUP



SAFETY FIRST!! READ AND UNDERSTAND THE SAFETY INSTRUCTIONS (pages 2-5 of this manual) BEFORE BEGINNING ANY PICK-UP BROOM SETUP

ADJUSTING THE BRUSH HEIGHT (Refer to the Setup Illustration below)

1. Place this product on a dusty, smooth surface that is large enough to safely accommodate the Pick-Up Broom, your power unit, and all workers involved in the mounting process.
2. Apply your power unit's parking brake, but leave the engine running.
3. Start the sweeper at a slow speed.
4. Lower the bucket until there is 1" of clearance under the bucket.
5. Run the sweeper for approximately 10 seconds, then raise the sweeper, release the parking brake, and back the power unit away.
6. Stop the sweeper, fully lower the sweeper, apply your power unit's parking brake, stop the engine, remove the starter key, wait for all moving parts to stop, and relieve all pressure in the hydraulic lines before leaving the operator's position.
7. Measure the brush pattern in the dust. The desired pattern should be a consistent 2" to 3" (51 to 76 mm) wide for the full length of the brush.
 - If the actual pattern matches the desired pattern, then the brush height is correct.
 - If the actual pattern is too wide, then remove the safety latch pin from the adjustment tube on one side of the unit, raise the brush one position, and resecure the adjustment tube with the safety latch pin. Repeat exactly for the other side.
 - If the actual pattern is too narrow or there is no pattern, then remove the safety latch pin from the adjustment tube on one side of the unit, lower the brush one position, and resecure the adjustment tube with the safety latch pin. Repeat exactly for the other side.
8. Repeat Steps 1 through 7 until the desired pattern is achieved.
9. Loosen the nuts holding the front and side flaps in position, then adjust the height of the flaps until the bottom of the flaps just make contact with the sweeping surface. Resecure the flaps by tightening the appropriate nuts.
10. Once the brush height is established, restart your power unit and roll back the bucket.
11. Apply your power unit's parking brake, stop the engine, remove the starter key, and wait for all moving parts to stop before leaving the operator's position.
12. Loosen the nuts on the full-threaded bolts on each side of the bucket.
13. Turn the head of each full-threaded bolt to move the position of the bucket edge relative to the brush bristles. The bucket edge should just barely clear the brush bristle ends when the brush is rotating.
14. Retighten the nuts on both of the full-threaded bolts.

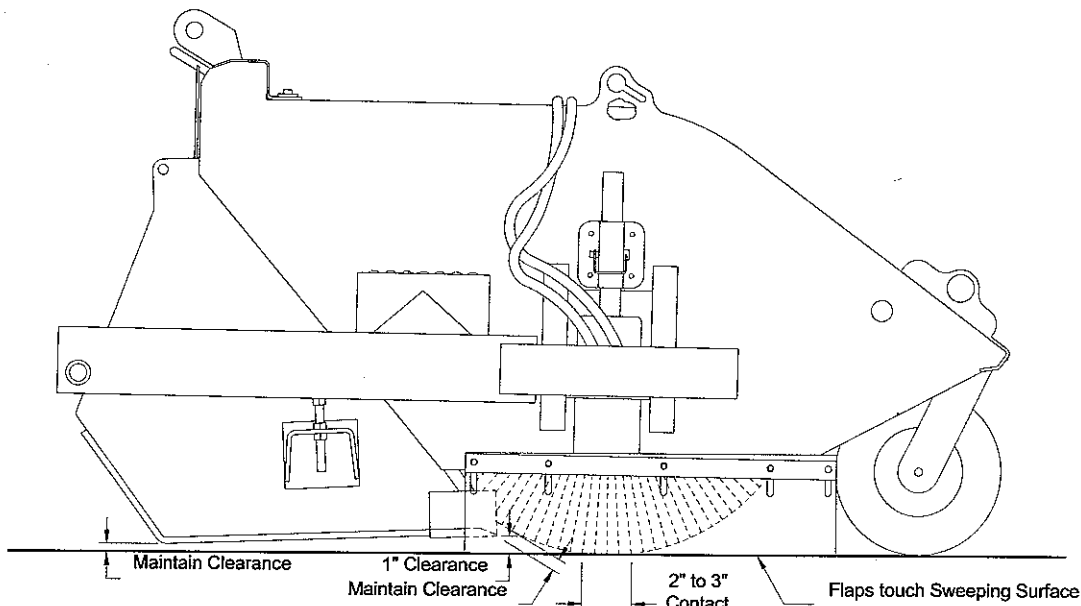

PICK-UP BROOM OPERATION



SAFETY FIRST!! READ AND UNDERSTAND THE SAFETY INSTRUCTIONS (pages 2-5 of this manual) BEFORE BEGINNING ANY PICK-UP BROOM OPERATION

WARNING



Failure to obey the following procedures could result in death or serious injury.

- Never lift the lowest portion of the bucket higher than 5'-0" above the ground.
- Do not lock the auxiliary hydraulics of your power unit in the "ON" position.
- Do not sweep toward others. Flying debris may cause serious injury.
- Minimize flying debris by operating at the slowest brush speed needed to achieve the desired results.
- Make sure that the dump restraint chains are clear of the quick-attach release lever. Entanglement of the chains could disengage this product from your power unit.

IMPORTANT

Starting or stopping the hydraulic flow to the brush motor at high engine speed **CAN** result in damage to this product and **WILL** void all FFC warranties.

GENERAL

- The brush is activated by the use of your power unit's auxiliary hydraulic control.
- Normal operation requires that the sweeper move forward while the brush rotates away from the operator at the sweeping surface and toward the operator on the top of the brush, bringing the swept material up over the brush.
- The bucket should never touch the sweeping surface during normal operations.

IMPORTANT

Using the bucket for standard bucket operations (i.e. digging, scraping, etc.) **CAN** result in damage to this product and **WILL** void all FFC warranties.

CLEAN-UP

- To collect the small ridge of material that forms in front of the brush during normal operation:
 1. Slow the power unit's engine and stop the brush rotation.
 2. Dump the bucket slightly so that the bucket edge nearly drags on the sweeping surface.
 3. Slowly activate the brush in the opposite direction of rotation. (i.e. The bristles move toward the operator at the sweeping surface and away from the operator on the top of the brush.)
 4. Move forward until the brush has swept the ridge of material directly back into the bucket.
 5. To complete the process, move your power unit backward across the same area to sweep up any material that may have slid under the bucket edge during the forward pass.
- Using the clean-up mode for normal sweeping will provide less than satisfactory results. Some of the material that should be picked up will be missed when such material is carried over the top of the brush or is thrown under the bucket and out of the range of the sweeper.

PICK-UP BROOM MAINTENANCE



SAFETY FIRST!! READ AND UNDERSTAND THE SAFETY INSTRUCTIONS (pages 2-5 of this manual) BEFORE BEGINNING ANY PICK-UP BROOM MAINTENANCE

BEFORE EACH USE

- Make sure that all nuts and bolts are in place and properly tightened.
- Make sure that all other fasteners are in place and are performing their specified function.
- Make sure that tires are inflated to maximum load pressure indicated on tire. Do not overinflate.
- Make sure that all hydraulic fittings are tightened and that there are no leaks in any fittings or hoses.
- Make sure that all safety signs are in place, are clean, and are legible.
(SEE THE SAFETY SIGN SECTION ON PAGE 5.)
- Replace any damaged parts and excessively worn parts.



SAFETY FIRST!! READ AND UNDERSTAND THE SAFETY INSTRUCTIONS (pages 2-5 of this manual) BEFORE BEGINNING ANY PICK-UP BROOM MAINTENANCE

AFTER EVERY 10 HOURS OF USE

- Grease 4 fittings: one on the under side of the caster wheel swivel, one on the caster wheel axle, and one on each of the two sweeper attachment pin sleeves on the rear of the bucket.

ANNUALLY

Repack the bearings in the wheels as described in steps 1-4 below.

1. Make sure that there is no weight on the wheels. If the wheels are partially supporting the weight of this product, restart your power unit and move the loader and/or dump cylinders. Repeat the specified shutdown procedure.
2. Remove each wheel using two 15/16" wrenches and remove the bearing components from the wheels.
3. Clean the bearing components, then use a high quality waterproof grease to repack the bearing components & hub.
4. Reassemble all components using a new seal.

IF DEBRIS (Wire, Banding, etc.) BECOMES WRAPPED AROUND THE BRUSH

1. Park your power unit on a level surface with this product properly attached.
2. Place your power unit's transmission in "Park" and engage the parking brake.
3. Lower this product (the bucket portion) onto preplaced blocking as specified below:



WARNING

Failure to obey the following procedures could result in death or serious injury.

- Do not use blocking made of concrete blocks, logs, buckets, barrels or any other material that could suddenly collapse or shift positions. Do not use wood or steel blocking that shows any signs of material decay. Do not use blocking that is warped, twisted, or tapered.

Compressive Strength of Each Blocking Unit	1,000 psi or the capability to support 1,000 lbs. without crushing or collapsing when the load is applied
Quantity and Location of Blocking Units	Two: one under each end of the bucket.
Direction of Placement	Place the blocks parallel to the direction of travel just inside the end plates of the bucket.
Length of Each Blocking Unit	2'-0" minimum
Height of Each Blocking Unit	5-1/2" maximum
Base Width of Each Blocking Unit	Equal to or greater than that Blocking Unit's Height

If blocking units are made up of smaller pieces:

these pieces must be stacked in a pyramid that must adhere to all the blocking unit specifications above, the width of each piece, 3-1/2" minimum, must be equal to or greater than the height of that same piece, there should never be a larger piece stacked on top of a smaller piece, every piece in a given layer must be the same height, and each piece should be centered over the line where two pieces in the layer below are in contact.

4. Shut off your power unit's engine, remove the starter key, wait for all moving parts to come to a stop, and relieve all pressure in the hydraulic lines.

IMPORTANT

Allowing dirt or other foreign material into the motor or hydraulic hoses CAN result in damage to this product and WILL void all FFC warranties.

5. Disconnect the hydraulic hoses from your power unit and connect the couplers together.
6. With proper safety equipment on (i.e. eye protection, gloves, protective clothing, etc.), rotate the brush in the reverse direction while pulling on the debris. In some cases, a wrench or bar can be used to assist in rotating the brush.

TORQUE SPECIFICATION FOR STANDARD MACHINE HARDWARE

Bolt Size	SAE Grade Bolt	Torque Ft./Lbs	Bolt Size	SAE Grade Bolt	Torque Ft./Lbs
0.25-20	5	8	0.50-13	5	75
0.31-18	5	17	0.75-16	5	125
0.38-16	5	30			

PICK-UP BROOM SERVICE



SAFETY FIRST!! READ AND UNDERSTAND THE SAFETY INSTRUCTIONS (pages 2-5 of this manual) BEFORE BEGINNING ANY PICK-UP BROOM SERVICE

REPLACING BRUSH SECTIONS

Repeat steps 1 - 5 from page 10.

6. FOR DUAL MOTOR UNITS ONLY: Cap the hydraulic coupler ends rather than connecting them together. Also remove the left end of the hose connecting the two motors. Cap the open port on the left motor and the loose end of the hose.
7. Loosen the appropriate nuts and bolts and remove the two side flaps.
8. Remove the safety snap pins that secure the height adjustment tubes.
9. Restart your power unit and raise the sweeper housing up off the brush assembly. Watch to make sure that the hoses are not catching on anything as they, the hoses, feed down past the motor guard(s).
10. Back your power unit up just enough for the brush assembly to clear the front of the sweeper housing and then lower the sweeper housing back down to the level surface. Again, be aware of where the hydraulic hoses are and avoid damaging them.
11. Place your power unit's transmission in "Park" and engage the parking brake.
12. Shut off your power unit's engine, remove the starter key, wait for all moving parts to come to a stop, and relieve all pressure in the hydraulic lines.
13. Slide the bearing and height adjustment bracket off the shaft of the core and remove the retainer plate from the core. FOR DUAL MOTOR UNITS ONLY: Remove the hairpin cotter pin and the castle nut from the right side motor, remove the motor and motor housing, and then remove the retainer ring from the core.
14. Set a block under the motor on the core while standing the other end of the core up vertically.
15. Slide all the old brush sections off the core.
16. Install a polypropylene section first on the core so that the drive pins on the section straddle one tube on the core. When correctly installed, the drive pins will prevent the section from being able to rotate on the core.

IMPORTANT

Failure to install a polypropylene section on each end of the core (first and last) CAN result in damage to this product and WILL void all FFC warranties.

17. Rotate a second section 120 degrees and then install that section with the drive pins straddling a tube that is next to the tube straddled by the drive pins of the first section.
18. Rotate a third section an additional 120 degrees and then install that section with the drive pins straddling the only tube that was not straddled by either the first or second section.
19. Continue installing sections, rotating each section 120 degrees until the core is full. If the last section will take more space than what remains and there is more than ½" (13 mm) of the core yet to be filled, set the last section in without rotating 120 degrees so that the drive pins are on the same tube as the previous section. This last section will then nest into the next-to-last section.
20. Replace the retainer plate or ring.

(Continued on page 12)

PICK-UP BROOM SERVICE (Continued)



SAFETY FIRST!! READ AND UNDERSTAND THE SAFETY INSTRUCTIONS (pages 2-5 of this manual) BEFORE BEGINNING ANY PICK-UP BROOM SERVICE

21. Lay the core down in a horizontal position and then slide the bearing and height adjustment bracket onto the core shaft. FOR DUAL MOTOR UNITS ONLY: Reinstall the motor housing and motor on the right end of the core. Secure the motor to the core with the castle nut and hairpin cotter pin.

IMPORTANT Failure to pull the motor flange tight against the housing on the brush frame **CAN** result in damage to this product and **WILL** void all FFC warranties.

22. Make sure that the height adjustment tubes on the brush assembly are left in a vertical position.
23. Restart your power unit, raise the sweeper housing, move forward, and lower the sweeper housing down on to the brush assembly. The hydraulic hoses should be fed through the motor guard while the sweeper housing is being lowered.
24. If the height adjustment tubes on the brush assembly are not sliding into the height adjustment sleeves on the sweeper housing, then lower the sweeper housing only to a height where the height adjustment tube could be started into the height adjustment sleeve. Repeat Steps 11 and 12 from page 11 without relieving the hydraulic pressure. Move the height adjustment tubes by hand until both have started to slide into the height adjustment sleeves. Restart your power unit and continue lowering the sweeper housing.
25. Resecure the brush assembly to the sweeper housing by inserting a safety snap pin through the height adjustment tube on each end of the brush assembly.
26. From page 11, replace the side flaps removed in Step 7 and reinstall the hydraulic hoses removed in Steps 5 and 6.
27. Readjust the height of the brush assembly by performing the nine steps listed under "Brush Height Adjustment" on page 8.

PICK-UP BROOM STORAGE



SAFETY FIRST!! READ AND UNDERSTAND THE SAFETY INSTRUCTIONS (pages 2-5 of this manual) BEFORE BEGINNING ANY PICK-UP BROOM STORAGE

NOTICE Allowing the brush to rest on the ground and deform during periods of storage will result in erratic performance and reduced sweeping effectiveness.

When removing this product from your power unit, lower the caster wheel and bucket down onto blocking that is thick enough to keep the brush completely off the storage area floor / ground surface.

PICK-UP BROOM TROUBLE SHOOTING



SAFETY FIRST!! READ AND UNDERSTAND THE SAFETY INSTRUCTIONS (pages 2-5 of this manual) BEFORE BEGINNING ANY PICK-UP BROOM TROUBLE SHOOTING

NOTICE See the Owner's / Operator's Manual of your power unit for any adjustment or service of your power unit that is listed as a POSSIBLE REMEDY below.

<u>PROBLEM</u>	<u>POSSIBLE CAUSE</u>	<u>POSSIBLE REMEDY</u>
Brush does not turn.	Brush bearing is seized.	Replace the bearing. (Single motor units only)
	Obstruction (i.e. rock, etc.) is lodged against the brush.	Remove the obstruction. Make sure that all safety procedures are followed. (Similar to removing debris that is wrapped around the brush on page 10.)
	Low level of hydraulic fluid in the power unit.	Add hydraulic fluid to the power unit.
	Defective hydraulic valve on the power unit.	Repair or replace the hydraulic valve on the power unit.
	Defective hydraulic pump on the power unit.	Repair or replace the hydraulic pump on the power unit.
Loss of power to brush.	Defective motor.	Replace motor.
	Hydraulic fitting is leaking.	Tighten or replace the hydraulic fitting.
	Hydraulic motor seal is leaking.	Replace the hydraulic motor seal.
	Low level of hydraulic fluid in the power unit.	Add hydraulic fluid to power unit.
Brush turns erratically.	Air in the power unit's hydraulic system.	Bleed the power unit's hydraulic system.
	Hydraulic fitting is leaking.	Tighten or replace the hydraulic fitting.
	Hydraulic motor seal is leaking.	Replace the hydraulic motor seal.
Overheating of power unit.	Low level of hydraulic fluid in the power unit.	Add hydraulic fluid to power unit.
	Air in the power unit's hydraulic system.	Bleed the power unit's hydraulic system.
Swept material not being collected in bucket.	Air in the power unit's hydraulic system.	Bleed the power unit's hydraulic system.
	Brush is hitting bucket edge.	Adjust the full-threaded bolts. (See SETUP on page 8. Especially note steps 10 to 14.)
	Front or side flaps not properly adjusted.	Adjust the flap height. (See SETUP on page 8.)
Excessive bucket wear.	Brush rotating in the wrong direction.	Reverse the brush rotation. (See GENERAL on page 9.)
	Material falling back out of bucket.	Empty or roll back bucket.
Excessive bucket wear.	Bucket touching sweeping surface.	Raise bucket to specified height. (See SETUP on page 8.)

PARTS ILLUSTRATION

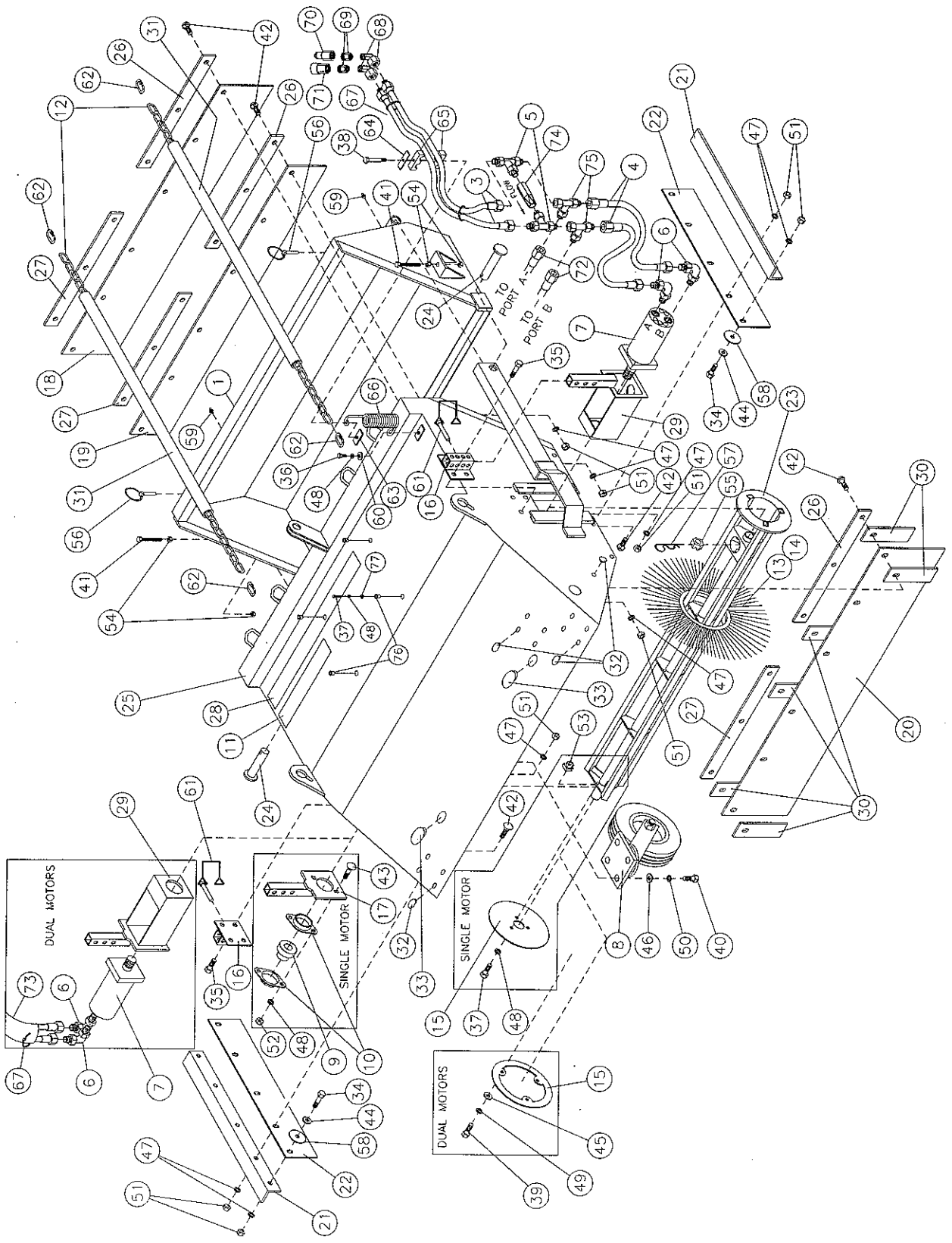

PICK-UP BROOM PARTS LIST

ITEM	QTY.	LAF8253 60" Single	LAF8254 72" Single	LAF2864 72" Dual	LAF8307 84" Dual	DESCRIPTION
1	1	LAF2859	LAF2871	LAF2871	LAF8306	Bucket Weldment
3	2				LAF4385	Hydraulic Hose: 1/2" I.D. x 6'-6" with (1) #12 Male O-Ring Boss and (1) #8 Female JIC
4	2				LAF4338	Hydraulic Hose: 1/2" I.D. x 2'-2" long with (2) #8 Female JIC
5	2				LAF4403	Hydraulic Branch Tee: (2) #8 Male JIC Fittings and (1) Male O-Ring Boss
6	Varies	(2)	(4)	(4)	(4) LAF4503	Hydraulic Elbow: 90° #8 Male JIC x #8 Male O-Ring Boss
7	Varies	(1)	(1)	(2)	(2) LAF4597H	Hydraulic Motor
8	1				LAF8222	Caster Wheel Assembly (Includes 2 Grease Fittings)
9	1	LAF8225	LAF8225	Not Used	Not Used	Core Shaft Bearing
10	2	LAF8226	LAF8226	Not Used	Not Used	Core Shaft Bearing Flange
11	1				LAF8231	Anti-Slip Abrasive Tape: 4" x 2'-0" Black
12	2				LAF8244	Chain: 1/4" Dia. Link x 56 links
13	Varies	35	41	41	49	01-0847 Brush Section: 26" O.D. With Poly Bristles -or-
14	Varies	35	41	41	49	01-5010 Brush Section: 26" O.D. With Poly/Wire Bristles
15	1	LAF8259	LAF8259	LAF8284	LAF8284	Brush Section Retainer
16	2				LAF8260	Height Adjustment Sleeve Bracket
17	1	LAF8261	LAF8261	Not Used	Not Used	Height Adjustment Tube Bearing Bracket
18	1	LAF8266	LAF8279	LAF8279	LAF8311	Rear Flap
19	1	LAF8267	LAF8277	LAF8277	LAF8309	Inner Flap
20	1	LAF8268	LAF8278	LAF8278	LAF8310	Front Flap
21	2				LAF8269	Side Flap Retaining Angle
22	2				LAF8271	Side Flap
23	1	LAF8273	LAF8281	LAF8283	LAF8308	Core Weldment
24	2				LAF8274	Sweeper Housing Connection Pin
25	1	LAF8275	LAF8282	LAF8282	LAF8304	Sweeper Housing
26	Varies	(6)	(3)	(3) LAF8301	Not Used	Flap Retainer: 2'-4 1/2" Long
27	Varies	Not Used	(3)	(3)	(6) LAF8302	Flap Retainer: 3'-4 1/2" Long
28	1				LAF8303	Anti-Slip Abrasive Tape: 4" x 3'-6" Black
29	Varies	(1)	(1)	(2)	(2) LAF8312	Hydraulic Motor Housing
30	6				LAF9577	Blue Tempered Spring Steel Strap
31	2				LAF9851	Rubber Chain Sleeve
32	14				LAF9853	Plug: 3/8" Dia., Black
33	2				LAF9854	Plug: 1/4" Dia., Black
34	2				RHW1004	Hex Head Cap Screw: 1/4" Dia. x 3/4" Long, Grade 5
35	8				RHW1006	Hex Head Cap Screw: 1/4" Dia. x 1" Long, Grade 5
36	1				RHW1101	Hex Head Cap Screw: 5/16" Dia. x 1/2" Long, Grade 5
37	Varies	(6)	(6)	(3)	(3) RHW1105	Hex Head Cap Screw: 5/16" Dia. x 1" Long, Grade 5
38	1				RHW1112	Hex Head Cap Screw: 5/16" Dia. x 2-1/2" Long, Grade 5
39	3	Not Used	Not Used	RHW1203	RHW1203	Hex Head Cap Screw: 3/8" Dia. x 3/4" Long, Grade 5
40	4				RHW1404	Hex Head Cap Screw: 1/2" Dia. x 1-1/4" Long, Grade 5
41	2				RHW1465	Hex Head Cap Screw: 1/2" Dia. x 4" Lg, Full Thread, Grd. 5
42	Varies	(26)	(29)	(29)	(32) RHW2003	Carriage Bolt: 1/4" Dia. x 1" Long, Grade 5
43	2	RHW2202	RHW2202	Not Used	Not Used	Carriage Bolt: 5/16" Dia. x 1" Long, Grade 5
44	2				RHW5062	Flat Washer: 1/4" Dia. USS
45	3	Not Used	Not Used	RHW5262	RHW5262	Flat Washer: 3/8" Dia. USS
46	4				RHW5462	Flat Washer: 1/2" Dia. USS

NOTE: All parts are the same as the LAF8307 except for those parts numbered under the other models.

NOTE: The poly side of a brush section must always be installed at the ends (see note on Pick Up Broom Service page).

PICK-UP BROOM PARTS LIST (Continued)

		LAF8253	LAF8254	LAF2864	LAF8307		
ITEM	QTY.	60" Single	72" Single	72" Dual	84" Dual	DESCRIPTION	
47	Varies	(36)	(39)	(39)	(42) RHW6002	Lock Washer: 1/4" Dia. Medium Split	
48	Varies	(9)	(9)	(4)	(4) RHW6102	Lock Washer: 5/16" Dia. Medium Split	
49	3	Not Used	Not Used	RHW6202	RHW6202	Lock Washer: 3/8" Dia. Medium Split	
50	4				RHW6402	Lock Washer: 1/2" Dia. Medium Split	
51	Varies	(36)	(39)	(39)	(42) RHW7001	Hex Nut: 1/4" Dia. With 20 Threads Per Inch	
52	2	RHW7101	RHW7101	Not Used	Not Used	Hex Nut: 5/16" Dia. With 18 Threads Per Inch	
53	3	RHW7110	RHW7110	Not Used	Not Used	U-Style Clip Nut: 5/16" Dia. With 18 Threads Per Inch	
54	4				RHW7401	Hex Nut: 1/2" Dia. With 13 Threads Per Inch	
55	Varies	(1)	(1)	(2)	(2) RHW7706	Slotted Hex Nut: 3/4" Dia. With 16 Threads Per Inch	
56	2				RHW8068	Lynch Pin: 1/4" Dia. x 1-9/16" Long (Useable)	
57	Varies	(1)	(1)	(2)	(2) RHW8075	Hairpin Cotter Pin: 1/8" Dia. x 2-3/8" Long	
58	2				RHW8086	Fender Washer: 3/8" I.D. x 1 1/4" O.D. x 0.08" Thick	
59	4				RHW8090	Grease Fitting: 1/4" Dia. With 28 TPI, Self-Tapping	
60	1				RHW8098	Fender Washer: 5/16" I.D. x 1 1/2" O.D. x 0.08" Thick	
61	2				RHW8179	Safety Snap Pin: 5/16" Dia. x 2 1/4" Long (Useable)	
62	4				RHW8251	Connection Link: 5/16" Dia.	
63	1				RHW8613	Weld Plate: 5/16" Dia. Threaded Hole	
64	1				RHW8614	Cover Plate For Hose Clamp Cradles	
65	2				RHW8616	Clamp Cradle For (2) 7/8 O.D. Hoses	
66	1				RHW8618	Spring: 1-1/2" O.D. x 11-5/8" Long With 7-1/4" Coil	
67	Varies	(2)	(2)	(4)	(4) RMR5002	Nylon Cable Ties: 1/4" x 11" Long, Black, Outdoor Use	
68	2	to obtain the correct item.					Hydraulic Elbow (Not required on some models.)
69	2	to obtain the correct item.					Hydraulic Adapter (Not required on some models.)
70	1	to obtain the correct item.					Hydraulic Hose Quick Coupler: With Male End
71	1	to obtain the correct item.					Hydraulic Hose Quick Coupler: With Female End
72	2	Not Used	Not Used	LAF4556		Hydraulic Hose: 1/2" I.D. x 8'-4" w/(2) #8 Female JIC	
					LAF4032	Hydraulic Hose: 1/2" I.D. x 9' 4" w/(2) #8 Female JIC	
73	1	Not Used	Not Used	LAF4243	LAF4243	Hydraulic Hose Protector: 1-7/8" Dia. x 7'-9" Long	
74	1				LAF4266	Hydraulic Check Valve: 16 GPM Flow Nom. W/ (2) #8 Female O-Ring Boss Ports 3,500 Maximum Rated PSI	
75	1	Not Used	Not Used	LAF4555	LAF4555	Hydraulic Run Tee: #8 Male JIC x #8 Female JIC x #8 Male JIC	
76	4				RHW8645	Rivet Nut: 5/16" Dia. x 18 TPI, 0.027-0.150 Grip Range	
77	3				RHW5162	Flat Washer: 5/16" Dia. USS, Grade 5	

NOTE: All parts are the same as the LAF8307 except for those parts numbered under the other models.

PICK-UP BROOM SPECIFICATIONS

Model Number	Overall Width	Overall Height	Overall Depth	Shipping Weight
LAF8253	69-7/8"	32-9/16"	57-7/8"	780 lbs.
LAF8254	81-7/8"	32-9/16"	57-7/8"	960 lbs.
LAF2864	81-7/8"	32-9/16"	57-7/8"	992 lbs.
LAF8307	93-7/8"	32-9/16"	57-7/8"	1172 lbs.

All replacement hydraulic hoses and fittings must have a minimum rated working pressure of 3,500 psi.

POLICIES

Prices shown in this catalog are list prices unless otherwise stated. All prices are subject to change without notice. Prices will be those in effect at time of shipment. Quotations are based on prices prevailing at the time of inquiry and are good for a period of 30 days. All prices are subject to any Federal, State and Local tax that is now in effect or may be put into effect. All prices are F.O.B. nearest warehouse.

Claims for shortages of inaccurate filling of orders will not be allowed after 10 days from receipt of goods. Check merchandise immediately upon receipt. If merchandise is damaged or there is a shortage of boxes or pieces, be sure to note this on the carrier's receipt. You must file a claim immediately on the carrier. The responsibility for filing claims on the carrier for shortages or damaged merchandise is strictly the consignee's.

Special orders require a 50% downpayment and cannot be returned or canceled. When ordering, please specify part numbers, sizes, description and any other necessary information.

RETURN GOODS AGREEMENT

Dealers may return merchandise to SWEEPSTER LLC/FFC ATTACHMENTS FOR CREDIT. Written authorization must be given prior to return. Merchandise returned for credit must be prepaid and accompanied with return goods authorization as well as invoice date and invoice number. If there is an error on our part in filling your order, Sweepster LLC/FFC Attachments will accept the merchandise freight collect if returned by lowest cost transportation. For orders that were filled correctly, credit will be based on either the original purchase price or the current catalog price, whichever is lower, less a 20% restocking charge and reworking charges. In the event it is necessary to replace missing parts or to repaint and package these goods, this rework will be charged back on a time and material basis. **WARNING:** Reworking of merchandise in rusty or damaged condition is extremely costly. Goods must be returned within 30 days after authorization is given.

LIMITED WARRANTY AGREEMENT

The following warranties with respect to new SWEEPSTER LLC/FFC ATTACHMENTS products, excepting as hereafter provided, is made by SWEEPSTER LLC/FFC ATTACHMENTS to Dealers ("Dealers") authorized by SWEEPSTER LLC/FFC ATTACHMENTS to sell the products involved and each selling Dealer, in turn, make such warranties to the original retail purchaser (the "Purchaser").

A. Duration and Extent of Warranty

1. Products, except all working, moving and all or any parts subject to wear, except as hereafter provided, which are defective in materials or workmanship as delivered to the Purchaser by a Dealer will be repaired or replaced, by SWEEPSTER LLC/FFC ATTACHMENTS, only, as SWEEPSTER LLC/FFC ATTACHMENTS elects, without charge for materials or labor, if such defect appears in not more than 12 months, or 2,000 working hours, whichever is first, from and after the date of delivery to the Purchaser by the Dealer.

2. Those working and moving parts consisting of cylinders, pivot pins, bushings, bosses and bearings are warranted for repair or

replacement as SWEEPSTER LLC/FFC ATTACHMENTS elects for a period not to exceed six months or 1,000 working hours, whichever is first, from date of delivery to the Purchaser by Dealer. Teeth, cutting edges and wear bars are not warranted.

3. Liability of SWEEPSTER LLC/FFC ATTACHMENTS for defective parts or materials is specifically limited to the value of the parts or materials, only.

4. All parts or materials requiring warranty work **MUST** be returned by delivery to the selling Dealer for delivery to SWEEPSTER LLC/FFC ATTACHMENTS within thirty (30) days of occurrence of the defect or failure of the part or material, all freight prepaid by the Purchaser. Upon completion of the warranty work, SWEEPSTER LLC/FFC ATTACHMENTS will ship parts and material to Purchaser, freight prepaid by SWEEPSTER LLC/FFC ATTACHMENTS.

5. All decisions by SWEEPSTER LLC/FFC ATTACHMENTS pertaining to warranty work are final.

B. Responsibilities of Dealer

The following responsibilities are to be performed when the Dealer delivers a product to the purchaser or otherwise places it into warranty service:

1. Complete the Warranty Registration Form and forward to SWEEPSTER LLC/FFC ATTACHMENTS within 30 days of the sale of the product. Warranty reimbursement is contingent upon product registration.

2. Review warranty statement, operator's manual and complete delivery report with purchaser to assure understanding of purchaser's responsibilities as related to warranty, service and the proper and safe operation of the product. Purchasers should be advised to have failed parts repaired or replaced immediately upon failure and that continued use will result in additional damage and excessive wear.

3. Contact manufacturer prior to beginning repair or replacement of failed parts to make certain that the cost of repairs are consistent with the value of the product when sold. Warranty requests for units in Dealer's inventory may be submitted to SWEEPSTER LLC/FFC ATTACHMENTS when defects are noted in products prior to the retail sale of that unit.

4. Provide warranty and service repairs as directed by FFC Service Repair Bulletins or other instructions.

5. All warranty work must be completed within 30 days of failure. Notify SWEEPSTER LLC/FFC ATTACHMENTS Warranty Department if repairs will require more than 30 days after failure for an extension. No claim will be accepted for warranties that exceed this 30 day period.

6. No warranty will be allowed on units delivered to the retail customer prior to the full payment of that unit to SWEEPSTER LLC/FFC ATTACHMENTS by the Dealer.

7. If diagnostic time is required, contact SWEEPSTER LLC/FFC ATTACHMENTS prior to beginning the warranty repair for approval. Travel time reimbursement must be approved by SWEEPSTER LLC/FFC ATTACHMENTS prior to beginning the warranty repair.



© 2003 Sweepster LLC / FFC Attachments. Prices effective May 1, 2003. Sweepster LLC / FFC Attachments reserves the right to change specifications, prices, or discounts without notice or obligation.



POLICIES

C. Responsibilities of SWEEPSTER LLC/FFC ATTACHMENTS

1. Reimbursement for parts used in warranty repair will be credited only when the parts are purchased from SWEEPSTER LLC/FFC ATTACHMENTS. Parts will be credited at Dealer's net cost. No warranty will be allowed on parts that are past due.
2. Dealer should use parts from their parts inventory first. In the event that parts must be shipped from SWEEPSTER LLC/FFC ATTACHMENTS, freight will be paid by the Dealer and will be shipped by the most economical means to arrive in the shortest possible time. Air, Next Day Air, Priority and other special shipment methods requested by the Dealer will be at customer's expense.
3. Warranty Labor Reimbursement for labor expense to the Dealer is made by payment of the retail labor rate, or as regulated by state statutes. Repair times will be reviewed by SWEEPSTER LLC/FFC ATTACHMENTS and may be adjusted to average repair time required by other dealers to make similar repairs. Labor is not paid on the warranty associated with repair parts purchased by the retail customer that are used on a product that is not currently in warranty time frame.
4. Reimbursements for repairs made by outside sources (not Dealer personnel) will be made for those services deemed necessary for the resolution of the warranty by SWEEPSTER LLC/FFC ATTACHMENTS Warranty Department. Outside repair invoices must have prior approval from SWEEPSTER LLC/FFC ATTACHMENTS Service Department and must be attached to the warranty claim after approval.

D. Other Warranty Provisions

The following guidelines are to be followed when performing warranty repairs:

1. In all cases, the most economical repair should be performed unless otherwise directed. Credit will not be allowed for assemblies, or groups, if it is practical to make the repair with individual parts. In some cases, the assembly, or group price may be less than the total of the parts and labor required to complete the repair. In those cases, an assembly, or group, may be used.
2. Only those parts provided by SWEEPSTER LLC/FFC ATTACHMENTS are covered under Warranty. The use of parts from other sources will not be eligible for warranty consideration.
3. All parts removed during warranty repair should be held for a period of 60 days after the warranty claim has been submitted to SWEEPSTER LLC/FFC ATTACHMENTS. These parts can be discarded if disposition or return request has not been made during this period. Parts that are returned to SWEEPSTER LLC/FFC ATTACHMENTS for which credit has not been issued can be returned upon Dealer request within 30 days of claim disposition. These parts will be discarded after the 30 day period.
4. SWEEPSTER LLC/FFC ATTACHMENTS reserves the right to deny or reverse any and all warranty claims for parts, labor, or miscellaneous charges when errors are found or warranty provisions are abused or fraudulent claims are submitted.

E. Warranty Exclusions

SWEEPSTER LLC/FFC ATTACHMENTS will not be responsible for any of the following:

1. Defects or damage resulting from use, repairs or service performed in a manner not approved by SWEEPSTER LLC/FFC ATTACHMENTS or from repairs or service performed by someone other than SWEEPSTER LLC/FFC ATTACHMENTS to repair or replace the Product involved.
2. Defects, damage or failure resulting from any alteration or additions, done in a manner not approved by SWEEPSTER LLC/FFC ATTACHMENTS.
3. Defects, damage or failure or depreciation resulting from wear and tear, accident, misuse, negligence, improper maintenance or improper protection and storage; or
4. INCIDENTAL OR CONSEQUENTIAL DAMAGES, INCLUDING BUT NOT LIMITED TO, LOSS OF PROFITS, LOSS OF TIME, LOSS OF CROPS, INCONVENIENCE, LOSS OF USE OF THE PRODUCT OR OTHER MACHINERY, EQUIPMENT OR VEHICLES USED WITH THE PRODUCTS, COST OF RENTALS REPLACEMENT OF THE PRODUCTS OR OTHER COMMERCIAL LOSS.

F. Remedies Exclusive: No Other Warranties

The obligation of SWEEPSTER LLC/FFC ATTACHMENTS and the Dealers are limited to the obligations set forth in this Limited Warranty. THIS LIMITED WARRANTY IS IN LIEU OF ALL OTHER WARRANTIES OF FFC ATTACHMENTS, AND THE DEALERS, EXPRESSED OR IMPLIED. WARRANTIES BY SWEEPSTER LLC/FFC ATTACHMENTS OR THE DEALERS OF CONDITION QUALITY, MERCHANTABILITY OR FITNESS FOR A PARTICULAR PURPOSE ARE EXCLUDED, AS ARE ALL OTHER REPRESENTATIVES BY SWEEPSTER LLC/FFC ATTACHMENTS AND THE DEALERS TO THE PURCHASER OR USER AND ALL OTHER OBLIGATIONS OR LIABILITIES OF SWEEPSTER LLC/FFC ATTACHMENTS AND THE DEALERS. NO OTHER PERSON IS AUTHORIZED TO GIVE ANY OTHER WARRANTY OR TO ASSUME ANY OTHER LIABILITY ON BEHALF OF SWEEPSTER LLC/FFC ATTACHMENTS OR THE DEALERS.

THE LIMITED WARRANTY MAY NOT BE TRANSFERRED BY THE PURCHASER TO ANY SUBSEQUENT OWNER.

1. The instruction manual supplied with the Product contains important maintenance and service information. Read the manual and follow recommendations contained therein. Please remember that failures due to improper maintenance or service are not covered by the Limited Warranty.

SWEEPSTER LLC/FFC ATTACHMENTS reserves the right to make changes in Design or specifications at any time without Obligation to purchasers or equipment and Components previously sold. This warranty may not be altered or changed in any way.



© 2003 Sweepster LLC / FFC Attachments. Prices effective May 1, 2003. Sweepster LLC / FFC Attachments reserves the right to change specifications, prices, or discounts without notice or obligation.

