



# Talet Attachments

## Auger Bucket



- Concrete (3/4" Max)
- Asphalt
- Sand
- Washed Gravel (3/4" Max)
- Wildlife Feed
- Agricultural Grains

- Self loading from loose piles. Optional weld-on cutting edge also available.
- Fits most modern skid-steers.
- Hydraulic direct drive
- Includes two multi-linked chutes (24" and 36"), hoses, and couplers
- Available as a concrete mixer
- 1 Year warranty

- Skid-steer quick attach on both sides allows for left and right hand discharge

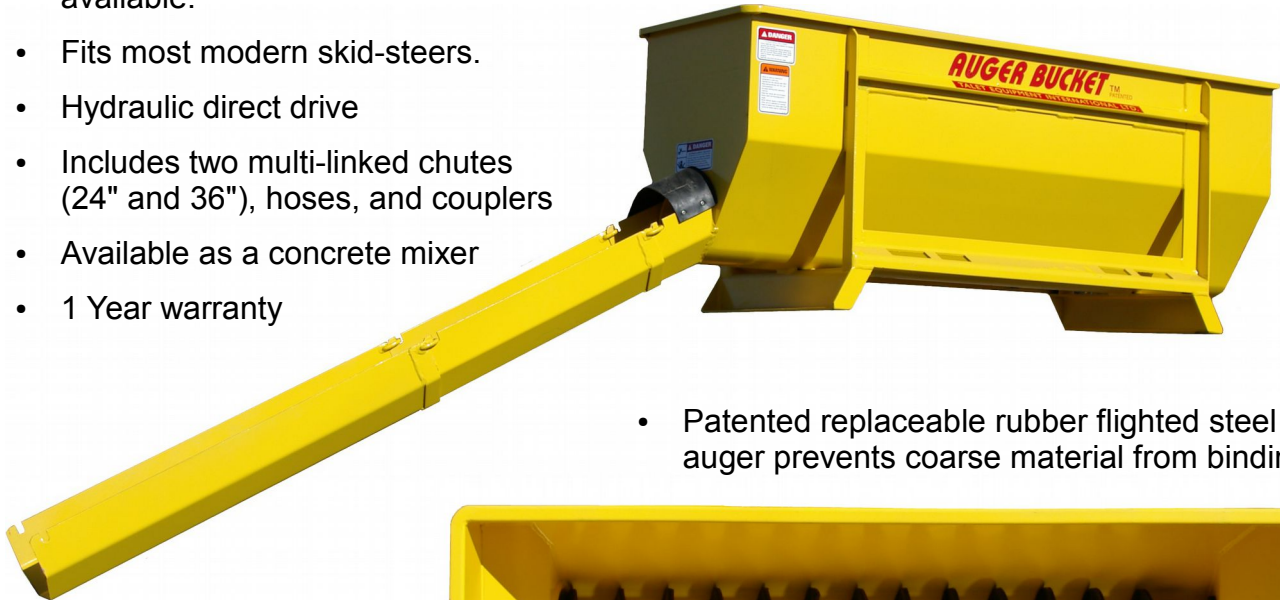

- Patented replaceable rubber flighted steel auger prevents coarse material from binding

- Accurate and controlled discharge - 1/2 yard in 50 seconds



Specifications and designs are subject to change without notice.

Talet Equipment International Ltd.  
888-317-5878  
[www.taletattachments.com](http://www.taletattachments.com)



# Talet Attachments

## Augers



### Discharge Auger

Part # AD001  
The standard rubber flighted auger. Handles most materials.



### Mixing Auger

Part # AM002  
Paddles and a reinforced auger allows for concrete to be mixed directly in the bucket.



### Steel Auger

Part # AS001  
Used for discharging asphalt and dry mixtures or materials.

## Options

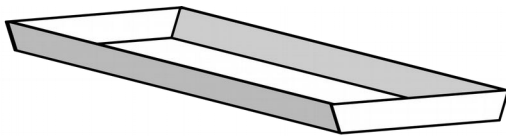

**Weld-On Cutting Edge** - For loading from frozen/hard piles.  
Part # 87137

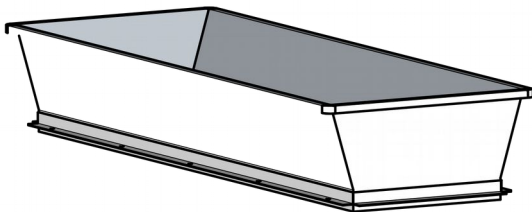

**3/4 Yard Hopper Extension** - Increases the capacity of the auger bucket from 1/2 yard to 3/4 yard. Bolt-on.  
Part # 87134

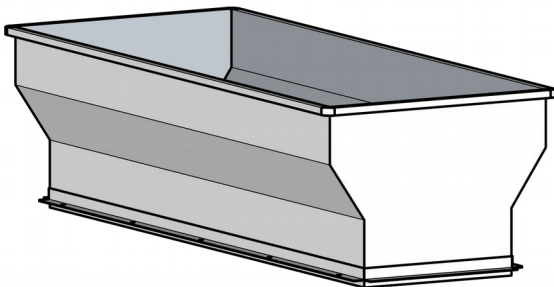

**1 Yard Hopper Extension** - Increases the capacity of the auger bucket from 1/2 yard to 1 yard. Bolt-on. For tractors with skid-steer loader mount only.  
Part # 87133

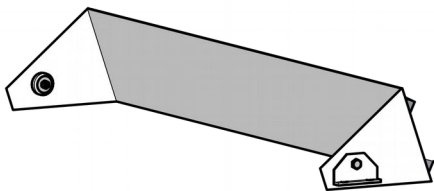

**Spill Guard** - Keeps material from spilling when traveling with a full bucket. Bolt on.  
Part # 90001

Specifications and designs are subject to change without notice.

Talet Equipment International Ltd.  
888-317-5878  
[www.taletattachments.com](http://www.taletattachments.com)



# Talet Attachments

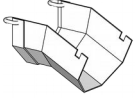

**Chute Angle Increaser**  
Part # 87141

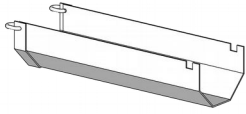

**24" Chute** - Multi-link chutes. Auger Bucket includes 1 by default.  
Part # 87139

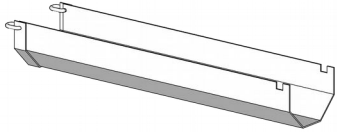

**36" Chute** - Multi link chutes. Auger Bucket includes 1 by default.  
Part # 87140

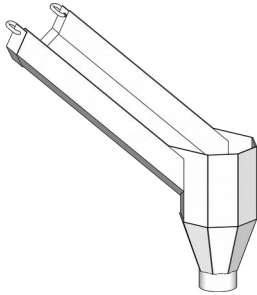
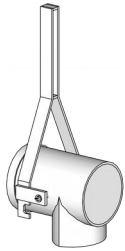

**Hose Adapter** - Can be used for slurry mix, filling block walls, etc.

4" Hose Adapter (Right) - Part # 87136  
6" Hose Adapter (Left) - Part # 90224

## Specifications

Model	3000 Series
Length	73.5"
Width	22.5"
Height	29.5"
Weight	380 lbs.
Volume	13 cu. ft.
Volume – Incl. Extension	28 cu. ft.
Min. Hyd. Requirements	12 GPM
Auger Length	61.5"
Auger Diameter – Without Rubber	4.0"
Auger Diameter – With Rubber	6.5"
Flighting Spacing	4.0"

Specifications and designs are subject to change without notice.

Talet Equipment International Ltd.  
888-317-5878  
[www.taletattachments.com](http://www.taletattachments.com)